



## Willifield Way, NW11

£1,350,000

In this sought after location in the artisan quarter, a pretty house with an outstanding large rear garden and the valuable advantage of a double length garage with off street parking.

On the south side of Hampstead Garden Suburb, within half a mile of Big Wood, Henrietta Barnett School, the heath extension and the café society of Temple Fortune, a local (H2) bus takes you to Golders Green underground station.

### Features

- Three Bedrooms
- Two Reception Rooms
- Guest WC
- Large Rear Garden
- Double Garage
- Off Street Parking



## Willifield Way, NW11

Approached via a tiled portico entrance, there is a dual aspect reception room with glazed doors overlooking and leading to the garden, a separate dining room and a kitchen with garden access.

On the first floor you will find three good-size bedrooms, bathroom, separate WC and access to the loft area, which is ideal for additional storage.

Externally there is off-street parking, a double garage, a front garden set behind a mature Yew hedge and a generous south-westerly facing rear garden with a spacious patio area and a large lawn.



# Willifield Way, London, NW11

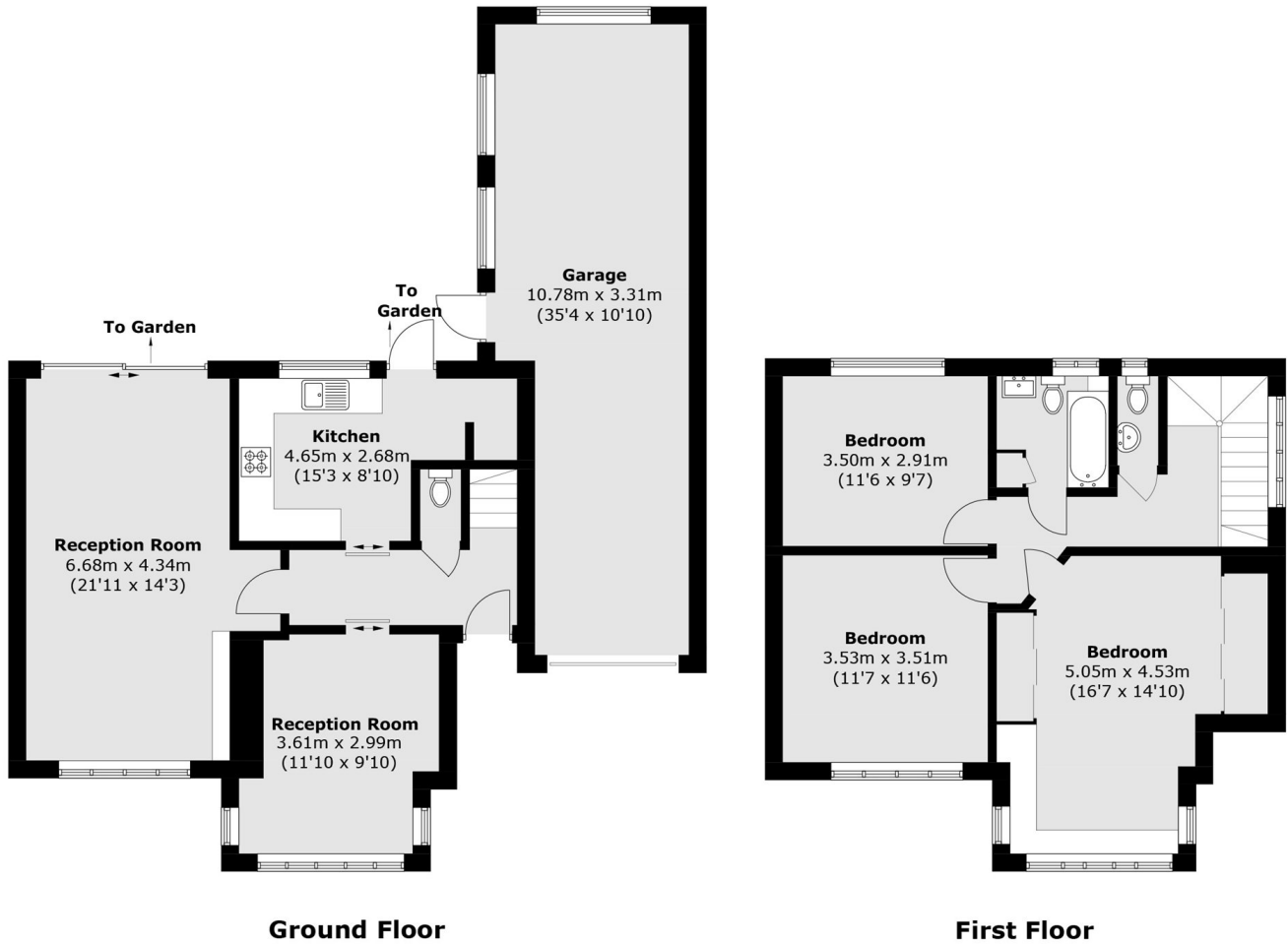

Total area (approx.): 115.2 sq. m (1,240.0 sq. ft)  
Garage: 32.4 sq. m (348.7 sq. ft)