



31 Draycott Avenue | | LONDON | SW3 3BS

£2,562 Per month

ESON2
REAL ESTATE

Key features

- Open-Plan Living
- High-End Kitchen
- Luxurious Bathroom
- Smart Design
- On-site Gym
- Workspace Facilities

Description

This newly renovated studio in Chelsea features modern interiors, a versatile living area with a study room, premium kitchen appliances, and a luxurious bathroom. Located near King's Road and Knightsbridge with excellent transport links.



Directions

This newly renovated studio in Chelsea's SW3, combines sleek design with smart, efficient living. With contemporary interiors and an open-plan layout, the apartment maximises natural light and space, creating a bright, stylish, and inviting atmosphere.

Floor plans

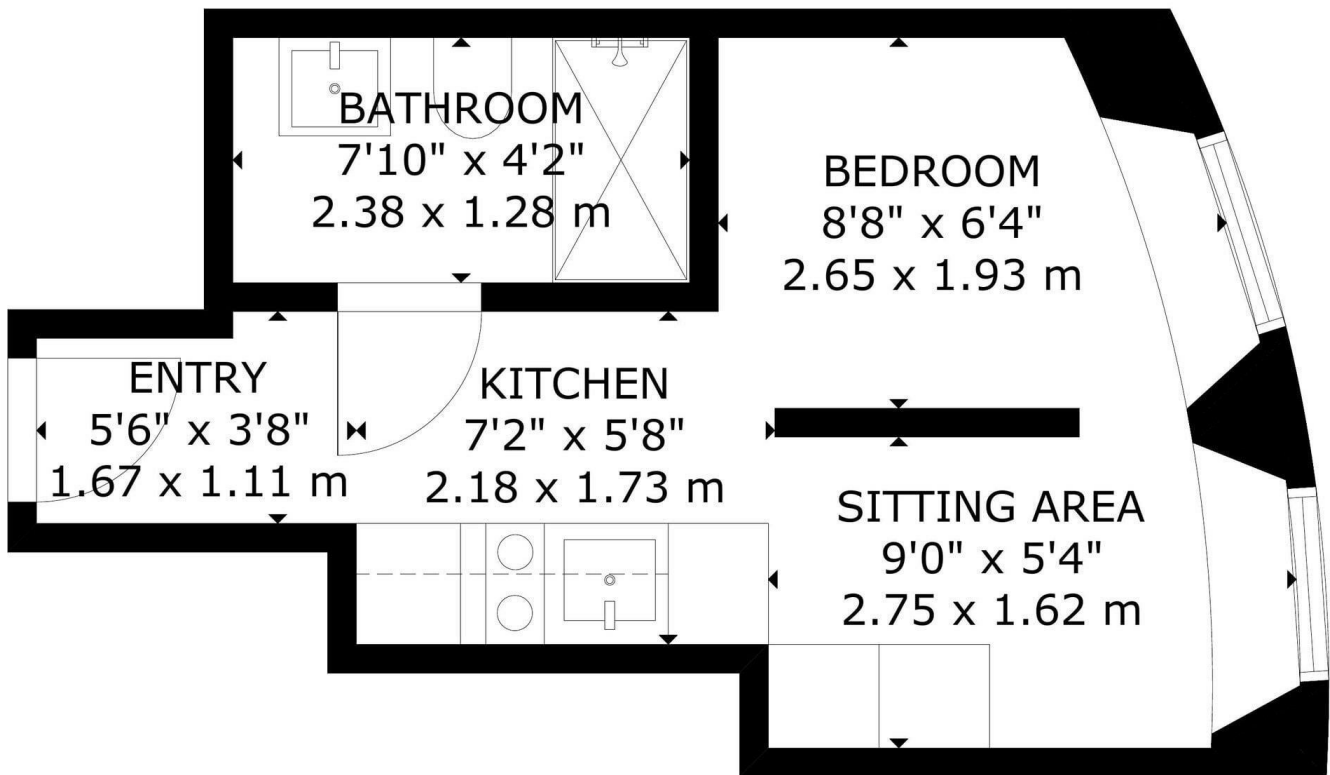

LOWER GROUND FLOOR

GROSS INTERNAL AREA
TOTAL: 18 m²/196 sq ft
LOWER GROUND FLOOR: 18 m²/196 sq ft
SIZE AND DIMENSIONS ARE APPROXIMATE, ACTUAL MAY VARY

Energy Efficiency Rating		
	Current	Potential
<i>Very energy efficient - lower running costs</i>		
(92 plus) A		
(81-91) B		81
(69-80) C	69	
(55-68) D		
(39-54) E		
(21-38) F		
(1-20) G		
<i>Not energy efficient - higher running costs</i>		
England & Wales	EU Directive 2002/91/EC	

Council Tax Band EPC Rating C



301 Michelin House 81 Fulham road
London
Greater London
SW3 6RD
07920 257649
fayeel@eson2.co.uk
www.eson2.co.uk