

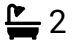



HOMES BY VICTORIA  
ESTATE AGENCY

## Offenham Close, Redditch, B98 8RJ

Offers Over £330,000

 3  2  2



**\*\*OFFERED TO THE THE MARKET CHAIN FREE\*\*** Welcome to Offenham Close, a beautifully presented linked detached family home, perfectly positioned within a quiet and sought-after cul-de-sac. Offering both style and sophistication throughout, this property is truly move-in ready.

[homesbyvictoria.co.uk](https://www.homesbyvictoria.co.uk)

[victoria@homesbyvictoria](mailto:victoria@homesbyvictoria) | 07833 136521

FOR M HOMES MIDLANDS LIMITED trading as Homes By Victoria Company Number: 13688840 VAT no: 470190115



HOMES BY VICTORIA  
ESTATE AGENCY



## Key Features

- OFFERED TO THE MARKET CHAIN FREE
- HIGHLY DESIRABLE LOCATION
- GENEROUS LOUNGE
- LARGE UTILITY ROOM AND DSWC
- LANDSCAPED REAR GARDEN
- IMMACUALLY PRESENTED THROUGHOUT
- LINK DETACHED FAMILY HOME
- STUNNING KITCHEN DINER
- BEAUTIFUL GARDEN ROOM
- DRIVEWAY AND STORAGE GARAGE

Approx Gross Internal Area  
96 sq m / 1037 sq ft

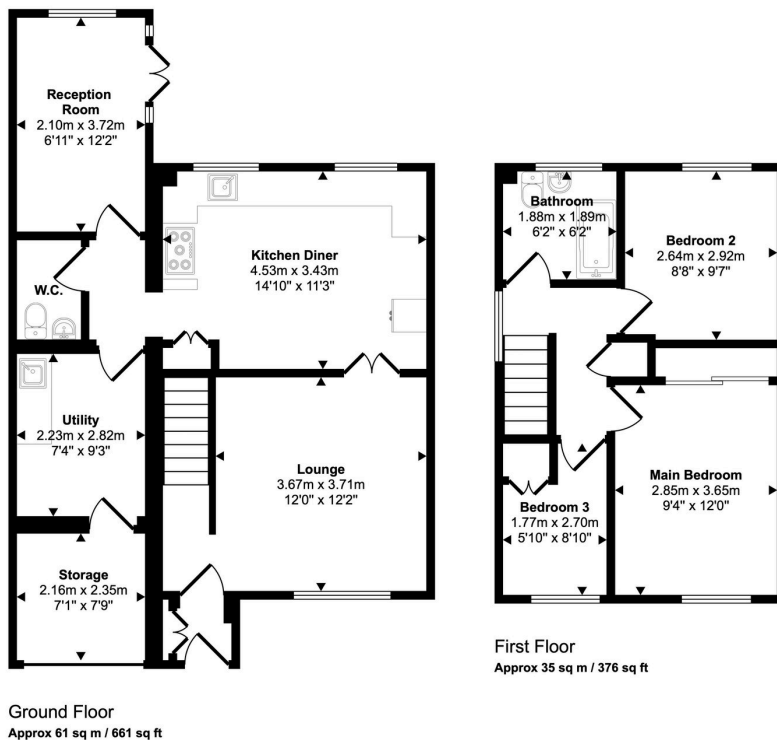

This floorplan is only for illustrative purposes and is not to scale. Measurements of rooms, doors, windows, and any items are approximate and no responsibility is taken for any error, omission or mis-statement. Icons of items such as bathroom suites are representations only and may not look like the real items. Made with Made Snappy 360.