



Connells

Tay Gardens
Plymouth



Property Description

We are delighted to introduce this well-presented two bedroom end terrace family home to the market, situated in a popular residential location. Benefiting from two double bedrooms, lounge/diner, kitchen, bathroom, separate W.C., large wrap around garden, outbuilding/workshop and communal parking.

Located in Deer Park, close to a host of local amenities, local parks and well-regarded schools whilst offering easy access to the A38 and main transport links.

As you enter this home, you are welcomed with a spacious bright and airy lounge/diner with double patio doors leading directly out to the rear garden, followed by the kitchen area which has beautiful matching wall and base units.

Continuing the good condition of this home, on the first floor you will find two good-sized double bedrooms, a new bathroom comprising bath with overhead shower, hand basin and a separate W.C.

Externally, this property offers a large wrap around garden, perfect for enjoying and hosting in the summer months, as well as an outbuilding/workshop, the ideal storage space and brand-new fence. This property also offers communal parking.

This home has recently been redecorated with it being replastered and repainted

throughout as well as new radiators throughout.

This property is the perfect opportunity for a first-time buyer or growing family, appealing to a wide range of buyers.

EARLY VIEWINGS ADVISED!

Ground Floor

Lounge/Diner

19' 8" x 9' 10" (5.99m x 3.00m)

Kitchen

10' 6" x 7' 7" (3.20m x 2.31m)

First Floor

Bedroom One

11' 6" x 10' 6" (3.51m x 3.20m)

Bedroom Two

11' 6" x 8' 10" (3.51m x 2.69m)

Bathroom

5' 7" x 4' 11" (1.70m x 1.50m)

W.C.







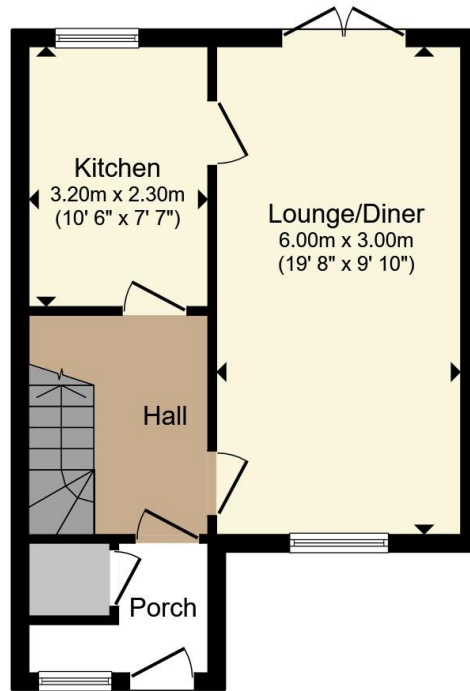

Ground Floor

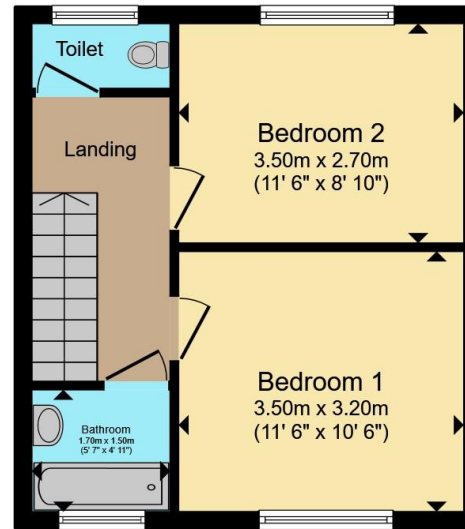

First Floor

Total floor area 64.6 m² (695 sq.ft.) approx

This floor plan is for illustrative purposes only. It is not drawn to scale. Any measurements, floor areas (including any total floor area), openings and orientation are approximate. No details are guaranteed, they cannot be relied upon for any purpose and they do not form part of any agreement. No liability is taken for any error, omission or misstatement. A party must rely upon its own inspection(s). Powered by www.propertybox.io



To view this property please contact Connells on

T 01752 674 467
E plymouth@connells.co.uk

32 Mannamead Road
 PLYMOUTH PL4 7AA

EPC Rating: C Council Tax Band: A

Tenure: Freehold

view this property online connells.co.uk/Property/PLH313703



1. MONEY LAUNDERING REGULATIONS Intending purchasers will be asked to produce identification documentation at a later stage and we would ask for your co-operation in order that there will be no delay in agreeing the sale. 2. These particulars do not constitute part or all of an offer or contract. 3. The measurements indicated are supplied for guidance only and as such must be considered incorrect. Potential buyers are advised to recheck measurements before committing to any expense. 4. We have not tested any apparatus, equipment, fixtures, fittings or services and it is in the buyers interest to check the working condition of any appliances.

Connells Residential is registered in England and Wales under company number 1489613, Registered Office is Cumbria House, 16-20 Hockliffe Street, Leighton Buzzard, Bedfordshire, LU7 1GN. VAT Registration Number is 500 2481 05.

See all our properties at www.connells.co.uk | www.rightmove.co.uk | www.zoopla.co.uk

Property Ref: PLH313703 - 0003