



Pancras Way, London, E3

BUTLER & STAG



Immediately available two bedroom apartment in a popular development, ideally positioned for transport links and local amenities.



- Two Bedroom Apartment
- Two Bathrooms (One En-Suite)
- Close to Transport Links
- Unfurnished
- Third Floor with Balcony
- Allocated Car Parking and Concierge
- Victoria Park and Roman Road Nearby
- Available Immediately

With Victoria Park and the storied Roman Road only a short distance away, you really do have the best of East London on your doorstep. The Heart of Bow development is conveniently located for Bow Road and Bow Church stations, for quick access into Central London and Canary Wharf.

The apartment itself is situated on the third floor and comprises of two double bedrooms (one with an en-suite shower room), a main bathroom and a spacious open-plan kitchen / reception which leads out to a private balcony. The property further benefits from an allocated underground car parking space, as well as concierge service.

Offered unfurnished and available now, this property would make the perfect next home for a couple or two professional sharers.

EPC Rating C
Council Tax Band D





Cuthbert Bell Tower

Approx. Gross Internal Area 74.3 sq. metres (799.7 sq. feet)

BUTLER & STAG

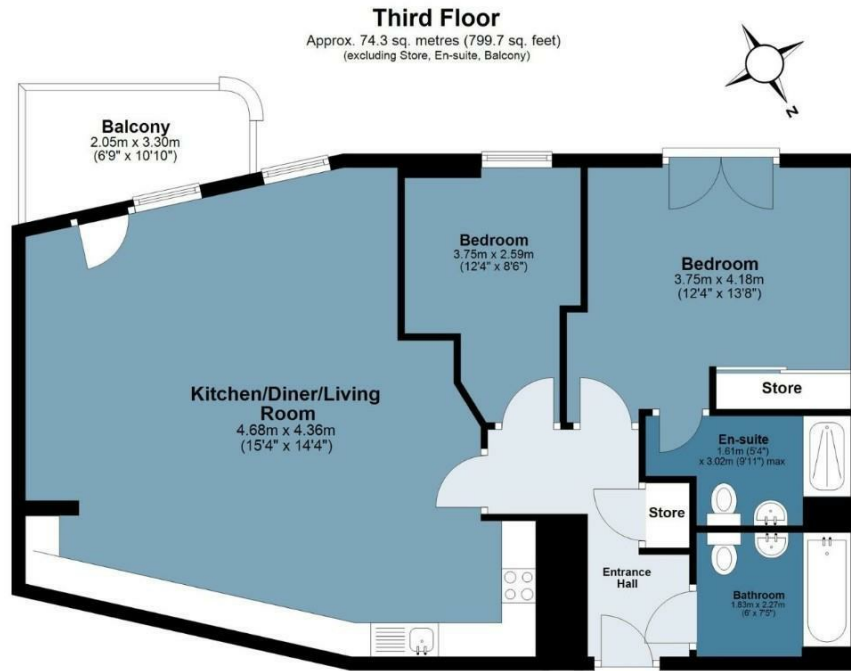

Measurements are approximate and for illustration purposes only. While we do not doubt the accuracy and completeness, we advise you conduct a careful independent assessment of the property to determine monetary value
© @modephoto www.modephoto.co.uk

BUTLER & STAG

☎ 020 8102 1236

🏠 508 Roman Road, Bow, London, E3 5LU

✉ bow@butlerandstag.com

www.butlerandstag.uk

IMPORTANT NOTICE - These particulars have been prepared in good faith and they are not intended to constitute part of an offer or contract. We have not performed a structural survey on this property and the services, appliances and specific fittings have not been tested. All photographs, measurements, floor plans and distances referred to are given as a guide and should not be relied upon.