



Connells

Cheere Way
Papworth Everard



Well presented three bedroom mid-terrace townhouse in sought-after village of Papworth Everard, offering flexible living across three floors. Enjoy a bright kitchen/diner, private study, relaxing lounge, generous bedrooms including one with an ensuite, plus enclosed garden, garage and parking.

Entrance Hall

Door to front, fitted mat, storage cupboard, stairs to first landing, radiator.

Kitchen/Diner

Fitted Kitchen with a range of wall and base units, work surfaces, tiled splash back, electric oven, five burner gas hob, stainless steel cooker hood, one and a half bowl stainless steel sink and drainer, plumbing for dishwasher, space for fridge freezer, spotlights, TV point, french doors to rear, radiator.

Utility Room

Door to rear, wall and base units, surfaces, central heating boiler, plumbing for washing machine, space for tumble drier, tiled splash back, radiator.

Study

Window to front, telephone point, radiator.

First Floor Landing

Stairs to entrance and second floor accommodation, radiator.

Lounge

Two windows to front, television point, two radiators.

Bedroom Two

Window to rear, six door built in wardrobe, radiator.



Ensuite

Window to rear, shower cubicle. wash hand basin, WC, part tiled, shaver point, radiator.

Second Floor Landing

Stairs to first floor landing, loft access, storage cupboard.

Bedroom One

Two windows to front, two double built in wardrobes, radiator.

Bedroom Three

Window to rear, two double built in wardrobe, radiator.

Bathroom

Window to rear, bath with mix taps and hand held shower, wash hand basin, WC, extractor fan, part tiled, shaver point, radiator.

Rear Garden

Fence enclosed, lawn, planted borders, patio area, door to garage, outside tap, gate to rear.

Garage And Parking

Single garage with up and over door, light and power, door to garden, allocated parking to rear.

Agents Notes

Please ask regarding charges.







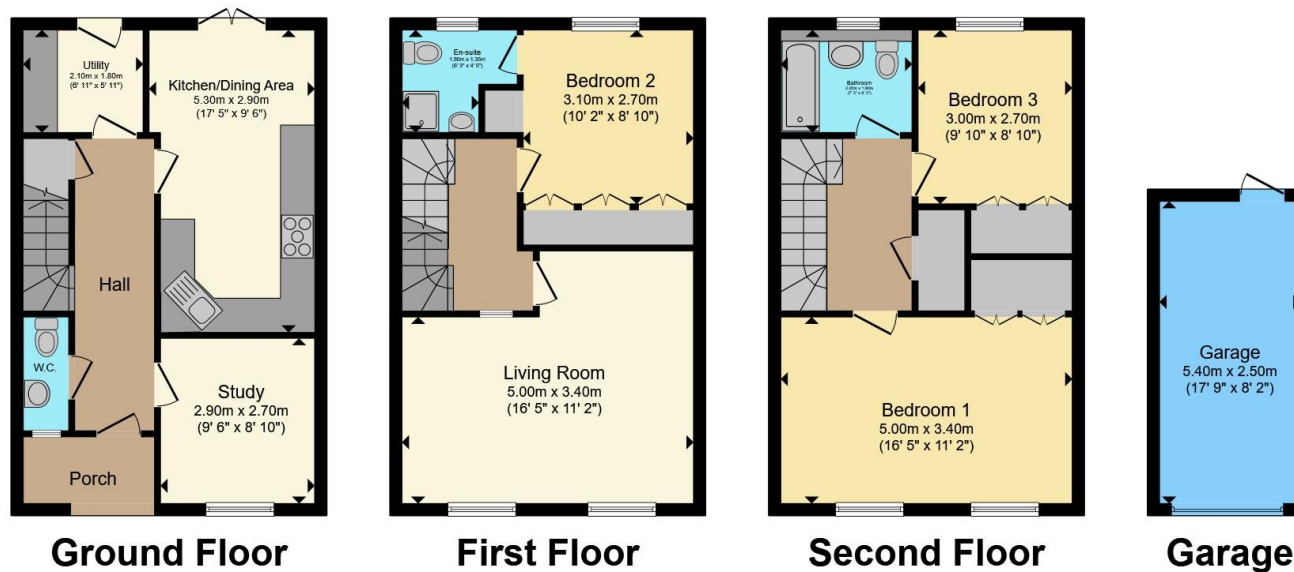

Total floor area 140.0 m² (1,507 sq.ft.) approx
 This floor plan is for illustrative purposes only. It is not drawn to scale. Any measurements, floor areas (including any total floor area), openings and orientation are approximate. No details are guaranteed, they cannot be relied upon for any purpose and they do not form part of any agreement. No liability is taken for any error, omission or misstatement. A party must rely upon its own inspection(s). Powered by www.propertybox.io



To view this property please contact Connells on

T 01954 714900
E cambourne@connells.co.uk

Unit 2 Caxton House Broad Street Great Cambourne
 CAMBRIDGE CB23 6JN

EPC Rating: C Council Tax
 Band: D

Tenure: Freehold

view this property online connells.co.uk/Property/CBN306717



1. MONEY LAUNDERING REGULATIONS Intending purchasers will be asked to produce identification documentation at a later stage and we would ask for your co-operation in order that there will be no delay in agreeing the sale. 2. These particulars do not constitute part or all of an offer or contract. 3. The measurements indicated are supplied for guidance only and as such must be considered incorrect. Potential buyers are advised to recheck measurements before committing to any expense. 4. We have not tested any apparatus, equipment, fixtures, fittings or services and it is in the buyers interest to check the working condition of any appliances.

Connells Residential is registered in England and Wales under company number 1489613, Registered Office is Cumbria House, 16-20 Hockliffe Street, Leighton Buzzard, Bedfordshire, LU7 1GN. VAT Registration Number is 500 2481 05.

See all our properties at www.connells.co.uk | www.rightmove.co.uk | www.zoopla.co.uk

Property Ref: CBN306717 - 0004