



## 48 Gordon Close

Ashford, TN24 8RQ

Price £269,950

A pleasantly appointed terraced home in a highly favoured cul de sac just a few minutes walk from Ashford town centre and mainline station.

The property comprises an entrance hall, sitting room, kitchen/dining room, two bedrooms and bathroom/WC. The generous garden backs on to allotments whilst to the front of the property you will find a private driveway for two cars. Gas central heating and double glazing are installed and several schools of good standing are in easy reach along with a host of other convenient amenities.

### Viewing

Please contact our Ashford Office on 01233 646411 if you wish to arrange a viewing appointment for this property or require further information.

- MODERN TERRACED HOME
- TWO BEDROOMS
- KITCHEN/DINING ROOM
- DRIVEWAY FOR TWO CARS
- ENCLOSED REAR GARDEN BACKING ON TO ALLOTMENTS
- GAS CENTRAL HEATING
- DOUBLE GLAZING
- SHORT WALK FROM TOWN CENTRE & MAINLINE STATION



# Floor Plan

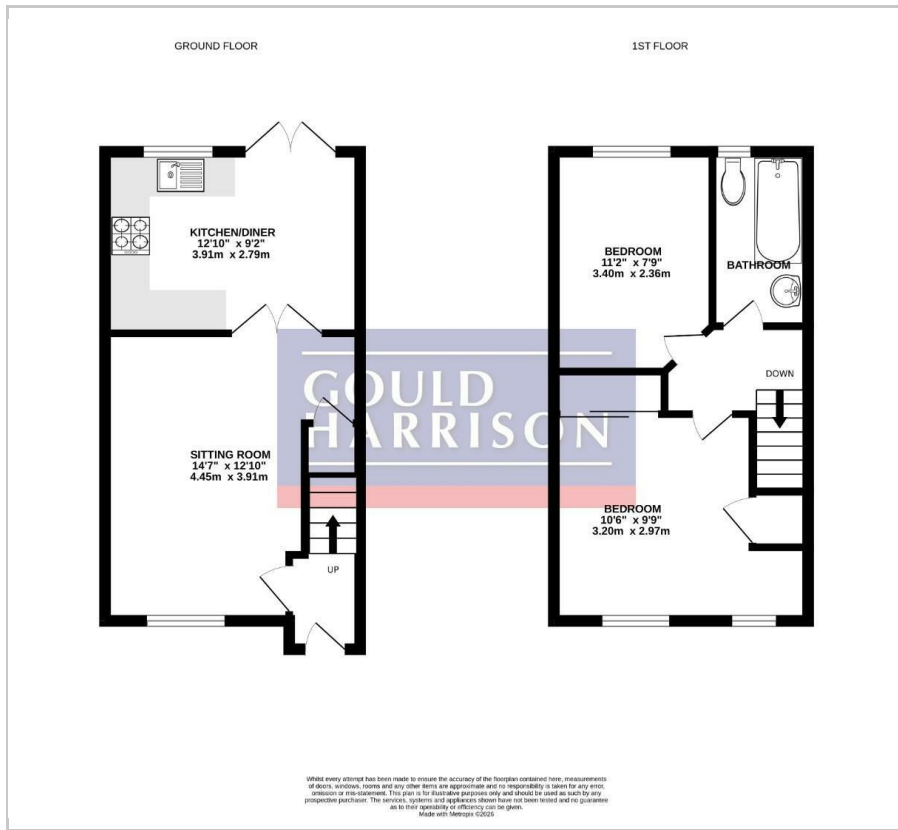

# Area Map



# Energy Efficiency Graph

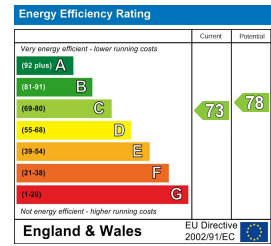

These particulars, whilst believed to be accurate are set out as a general outline only for guidance and do not constitute any part of an offer or contract. Intending purchasers should not rely on them as statements of representation of fact, but must satisfy themselves by inspection or otherwise as to their accuracy. No person in this firm's employment has the authority to make or give any representation or warranty in respect of the property.