



Harefield Road, SE4

£2,000 Per calendar month

A charming top floor flat in the highly sought after Brockley Conservation Area. The flat comprises a double bedrooms and a separate study, a cosy living room that leads to a separate kitchen and a walk in shower room. The property also has the use of the garden with side access.

Ideally located for Brockley station (Zone 2) as well as an array of local shops and other amenities. Hilly Fields is within easy reach too.

Features

- Top Floor Flat
- Two Double Bedrooms
- Well Presented Throughout
- Separate Kitchen
- Modern Walk In Shower Room
- Brockley Conservation Area

Harefield Road,
London, SE4

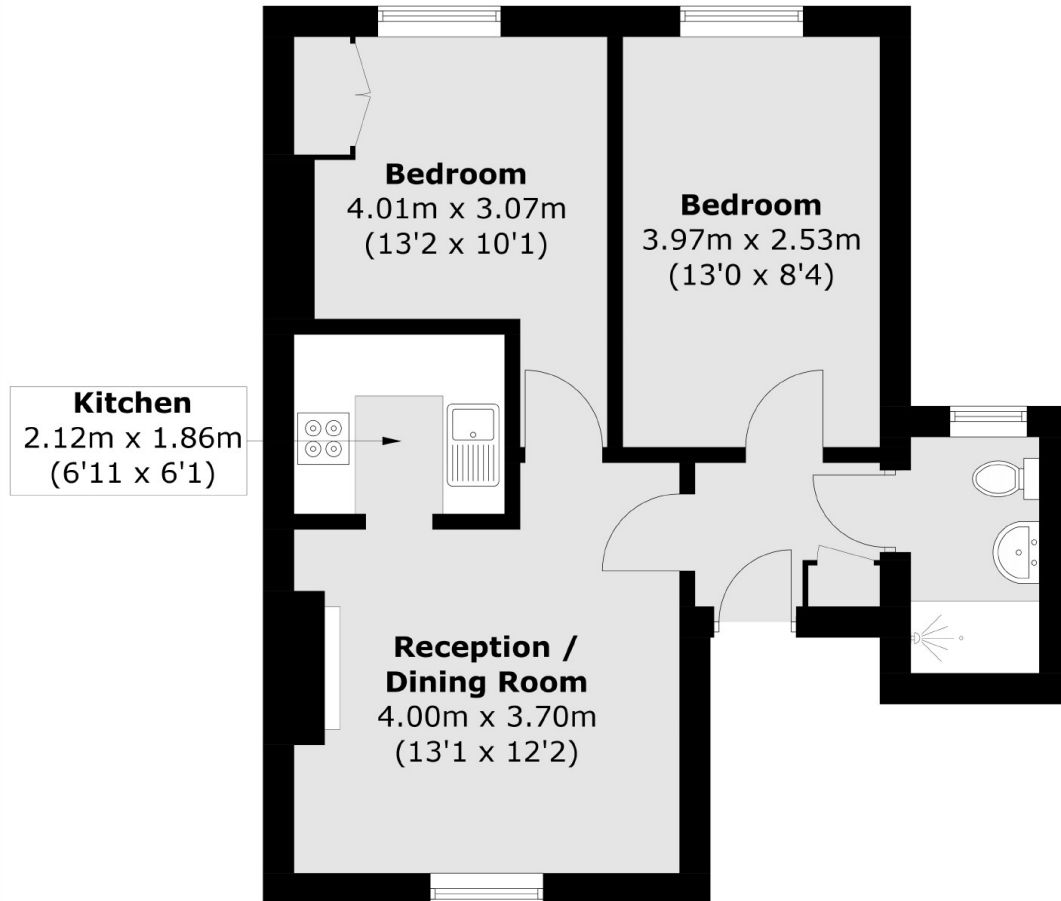

Total area (approx.): 44.9 sq. m (483.3 sq. ft)