



2C Nuthatch Drive

Finberry Ashford, TN25 7AA

Guide Price £335,000

GUIDE PRICE: £335,000 - £350,000

An immaculately presented semi-detached home on the highly favoured Finberry development.

The property comprises an entrance hall, cloakroom, kitchen/dining room, sitting room, three bedrooms, en suite and family bathroom/WC. The rear garden enjoys a sunny aspect with further benefits including gas central heating, double glazing, carport and parking. Finberry primary school is only a few minutes walk whilst Ashford mainline station and popular McArthur Glenn shopping outlet only 2.5 miles distant. Internal viewing is highly recommended.

Viewing

Please contact our Ashford Office on 01233 646411 if you wish to arrange a viewing appointment for this property or require further information.

- ATTRACTIVE SEMI DETACHED HOUSE
- IMMACULATLY PRESENTED
- THREE BEDROOMS
- EN SUITE & FAMILY BATHROOM/WC
- KITCHEN/DINING ROOM
- CARPORT
- ENCLOSED REAR GARDEN
- HIGHLY FAVOURED FINBERRY LOCATION
- GROUND FLOOR CLOAKROOM



Floor Plan

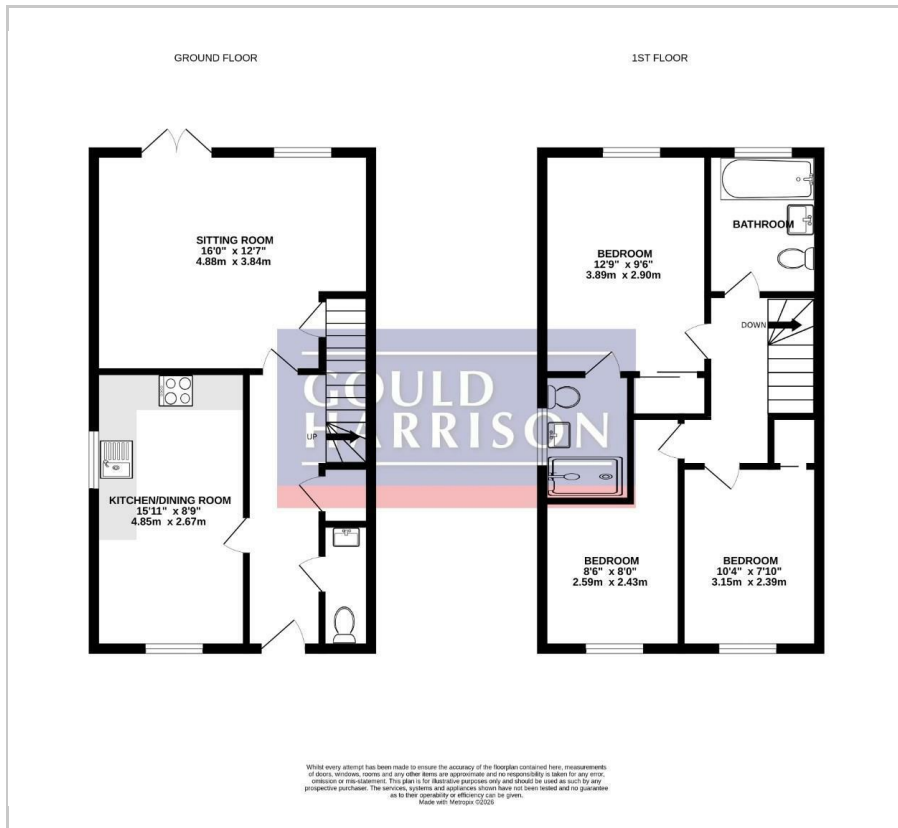

Area Map



Energy Efficiency Graph

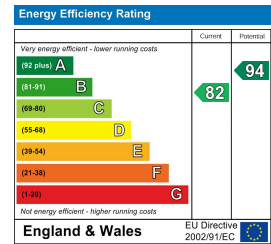

These particulars, whilst believed to be accurate are set out as a general outline only for guidance and do not constitute any part of an offer or contract. Intending purchasers should not rely on them as statements of representation of fact, but must satisfy themselves by inspection or otherwise as to their accuracy. No person in this firm's employment has the authority to make or give any representation or warranty in respect of the property.