



ATHERTON ROAD, SW13

£1,925,000

Detached family home
Three bedrooms
Stunning landscaped garden
Off street parking
Loft extension plans
Barnes

@marshandparsons
marshandparsons.co.uk

MARSH &
PARSONS



ABOUT THE PROPERTY

Marsh & Parsons are feeling privileged to represent this absolutely stunning three bedroom detached house on Atherton Road. This unique corner plot offers rarely available lateral space and fantastic proportions, located on this quiet residential road in Barnes. The property is set back from the road behind a beautiful front garden, the front door opens onto a large entrance hall with access to a laundry room and cloakroom, and the stunning front facing formal reception room. At the rear of the house is a full width entertaining room with bespoke modern fitted kitchen and dining area opening onto a landscaped rear garden with raised beds, ornamental pond and outdoor covered dining area.



STEP INSIDE ATHERTON ROAD

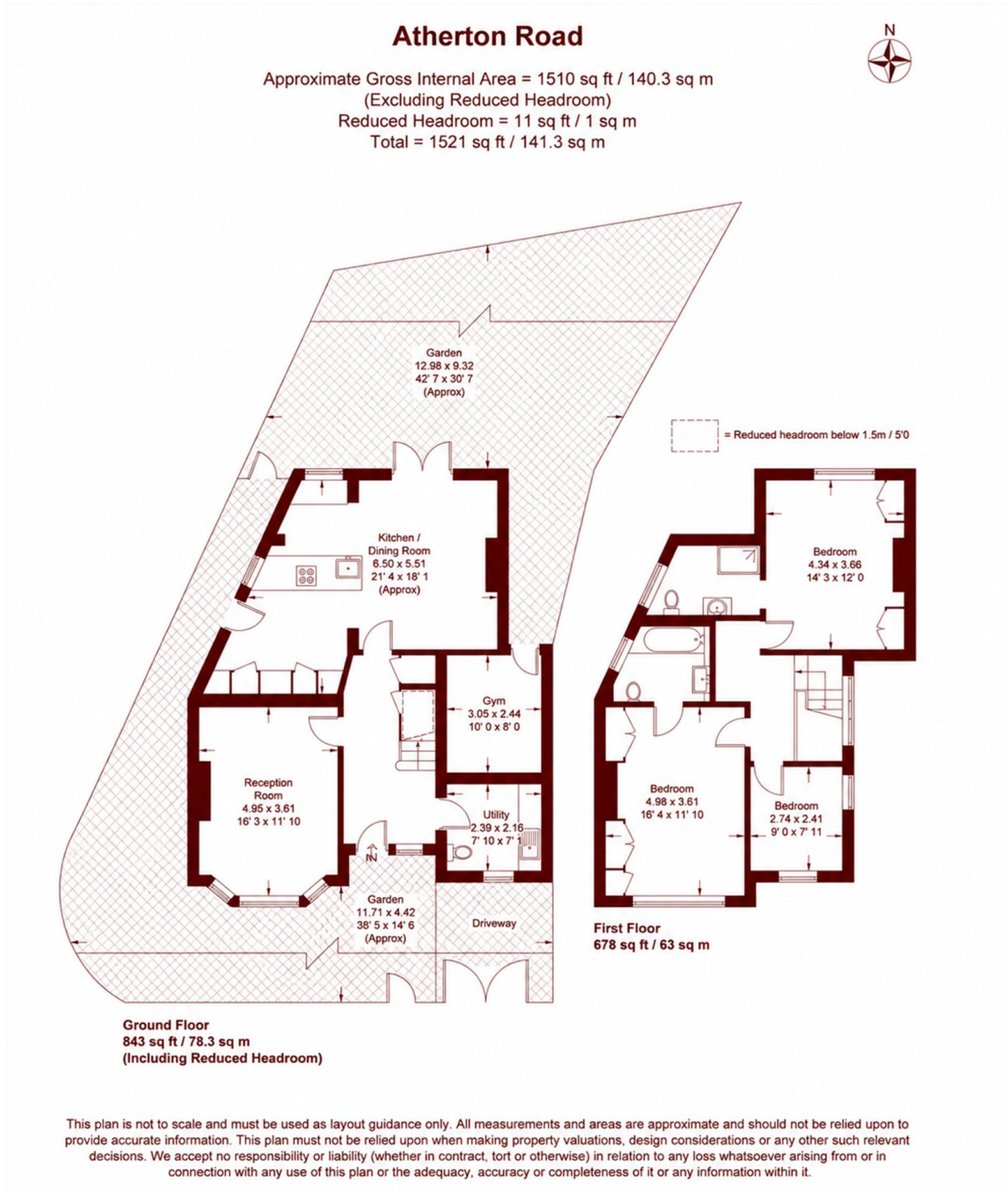

Barnes & East Sheen
020 8563 8333

Energy Rating: D We aim to make our particulars both accurate and reliable. However, they are not guaranteed; nor do they form part of an offer or contract. If you require clarification on any points then please contact us, especially if you're traveling some distance to view. Please note that appliances and heating systems have not been tested and therefore no warranties can be given as to their good working order

**MARSH &
PARSONS**