



## Andre Street, E8

### £500,000

A two double bedroom apartment measuring over 800 sq ft with two private balconies in a vibrant E8 location. Modern throughout with engineered wood flooring, open plan living, plenty of built in storage & family bathroom. The property has secure bike storage and is being sold chain free.

The property is situated within close proximity to Hackney Downs & Hackney Central station offering easy connections to the rest of the City. The amenities and array of shops, cafés and restaurants on Mare Street are also close by as well as London Fields, with the famous Saturday Market, is less than one mile away.

### Features

- Two Double Bedrooms
- Two Private Balconies
- Over 800 sq ft
- Modern Finishes
- Open Plan
- Chain Free
- Lift Access

# Andre Street, London, E8

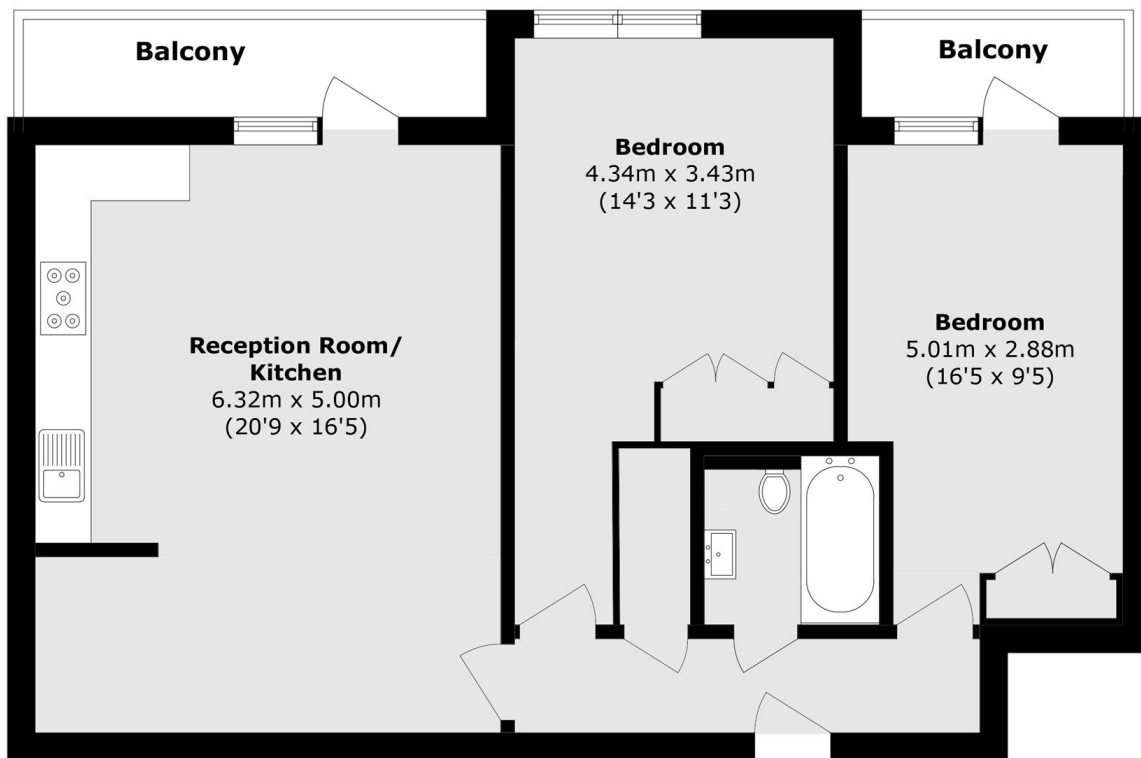

Total area (approx.): 76.0 sq. m (818.0 sq. ft)  
Balcony area (approx.): 9.3 sq. m (100.1 sq. ft)