



## Flat 3, 16 Sackville Gardens

Hove BN3 4GH

Guide Price £300,000 - £325,000

- SOUGHT AFTER LOCATION
- PERIOD BUILDING
- TWO BEDROOMS
- KITCHEN
- LIVING ROOM
- BATHROOM
- SHARE IN THE FREEHOLD
- PRESENTED IN EXCELLENT ORDER

Whitlock and Heaps bring to market this delightful two bedroom apartment forming part of the first floor of this semi detached bay fronted property that is situated on one of Hove's most sought after roads being just a few minutes walk from Hove seafront and the new Beach Park development. The property is presented in excellent order throughout with the living room being of a westerly aspect. The property is being sold with a share in the freehold and the building is self managed. Hove mainline station and an array of local independent shops and eateries are within a short walk.

**Council Tax Band B (taken from the government website, [www.brighton-hove.gov.uk/council-tax](http://www.brighton-hove.gov.uk/council-tax)).**

**We advise that you check this information, we will not be held responsible if the council tax band differs when occupying the property.**

**ENTRANCE HALL** Cupboard with plumbing and space for washing machine, radiator.

**KITCHEN** Incorporating sink unit with drainer and mixer tap, adjacent work surface with cupboards and drawers under, matching eye level wall cupboards, inset fridge/freezer, four ring gas hob with extractor over, electric oven, tiled splashback, breakfast bar, opening to:

**LIVING ROOM** West facing with two sash windows, radiator.

**BEDROOM 1** UPVC double glazed window, radiator.

**BEDROOM 2** Sash window, radiator.

**BATHROOM** White suite comprising panelled bath with shower over, pedestal wash hand basin, low level w.c., heated ladder style towel rail, sash window, part tiled walls.

**OUTGOINGS**

**SHARE OF FREEHOLD**

**MAINTENANCE** Self managed £250 per quarter.

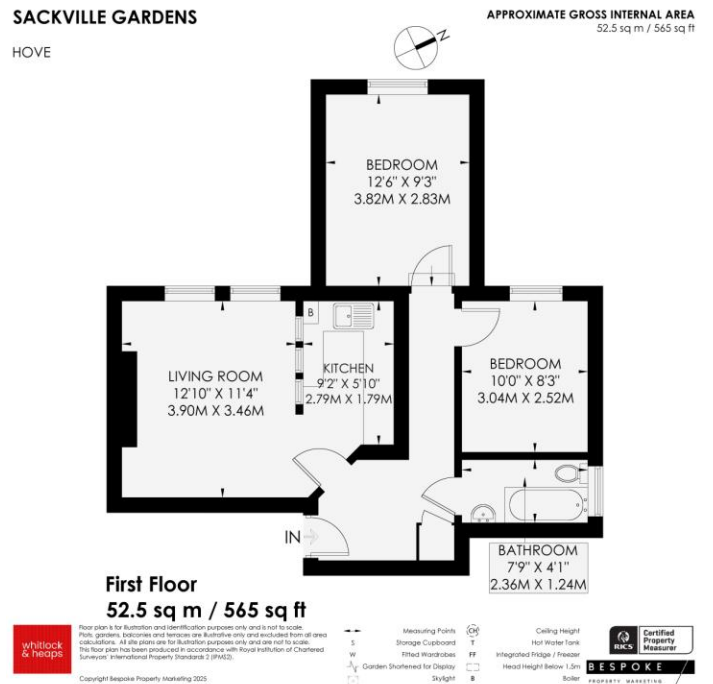

Score	Energy rating	Current	Potential
92+	A		
81-91	B		
69-80	C		75 C
55-68	D	66 D	
39-54	E		
21-38	F		
1-20	G		

65 Sackville Road, Hove BN3 3WE  
 sales@whitlockandheaps.co.uk  
 01273 778577



**Disclaimer:** Whitlock & Heaps have produced these particulars in good faith and they are set out as a general guide. Accuracy is not guaranteed, nor do they form part of any contract. If there is any particular aspect of these details which you require any confirmation, please do contact us, especially if contemplating a long journey. All measurements are approximate. Fixtures and fittings, other than those mentioned above, to be agreed with the seller. Any services, systems or appliances at the property have not been tested.