



### Mayors Lane, DA2

Approximate Gross Internal Area = 120.9 sq m / 1302 sq ft  
(Excluding Garage)



Score	Energy rating	Current	Potential
92+	A		
81-91	B		
69-80	C		
55-68	D	66 D	73 C
39-54	E		
21-38	F		
1-20	G		

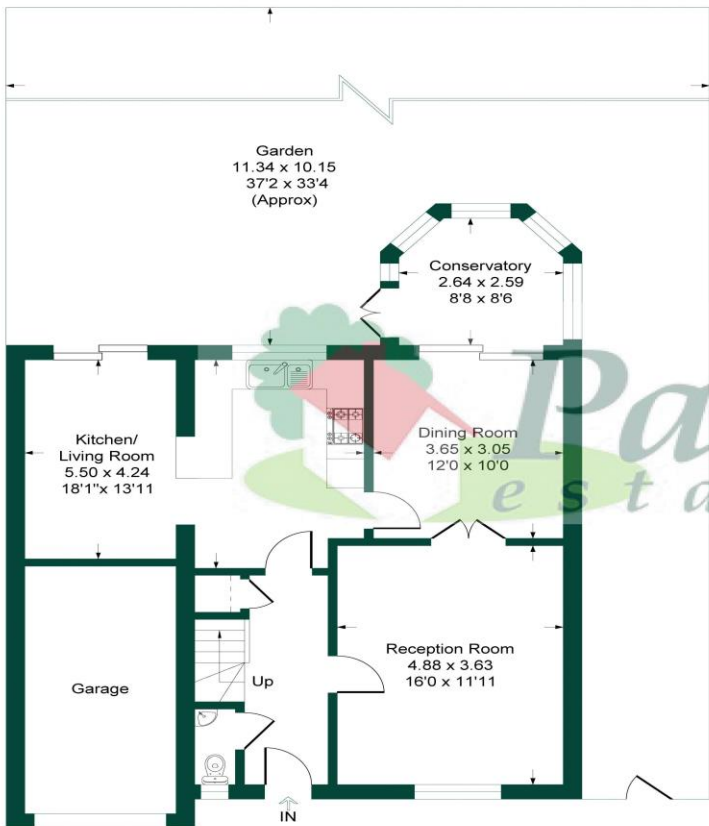

Ground Floor

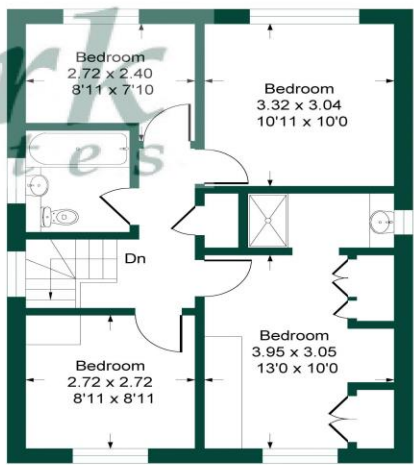

First Floor

This plan is for layout guidance only. Not drawn to scale unless stated. Windows and door openings are approximate. Whilst every care is taken in the preparation of this plan, please check all dimensions, shapes and compass bearings before making any decisions reliant upon them.  
Produced By Planpix



Park Estates are delighted to present this chain-free, four-bedroom detached residence, nestled in a peaceful close within the highly sought-after semi-rural village of Wilmington. The location offers convenient access to a range of well-regarded local amenities, including Wilmington Grammar Schools, Wilmington Academy, nearby shops, and excellent transport links. This ideal family home features well-balanced accommodation comprising an inviting entrance hall, ground floor WC, three versatile reception rooms, a fitted kitchen, and a bright conservatory. Upstairs, you'll find a contemporary family bathroom and four well proportioned bedrooms, with the principal bedroom benefiting from its own en-suite shower room. Further highlights include double glazing, gas central heating, off-street parking, an integral garage, and attractive front and rear gardens. Early viewing is strongly recommended. .

Local Authority: Dartford  
Council Tax Band: F

