



## MACAULAY COURT, SW4

£550,000

Second floor apartment  
Close to Clapham Common  
In good order  
Communal bike storage  
Hot Water included in S/C  
145 year lease



# ABOUT THE PROPERTY

A beautifully presented two bedroom apartment in a striking Art Deco building on Macaulay Road, one of Clapham Old Town's most sought after addresses.

Macaulay Road is a prime residential street, peacefully located in the heart of Clapham Old Town and ideally placed for the local amenities and wide open spaces of Clapham Common. Excellent transport links include Clapham Common Underground Station (Northern Line) and Wandsworth Road Overground Station, part of the London Overground orbital network, together with a comprehensive bus network providing swift access to the City, West End and Canary Wharf.



# STEP INSIDE MACAULAY COURT

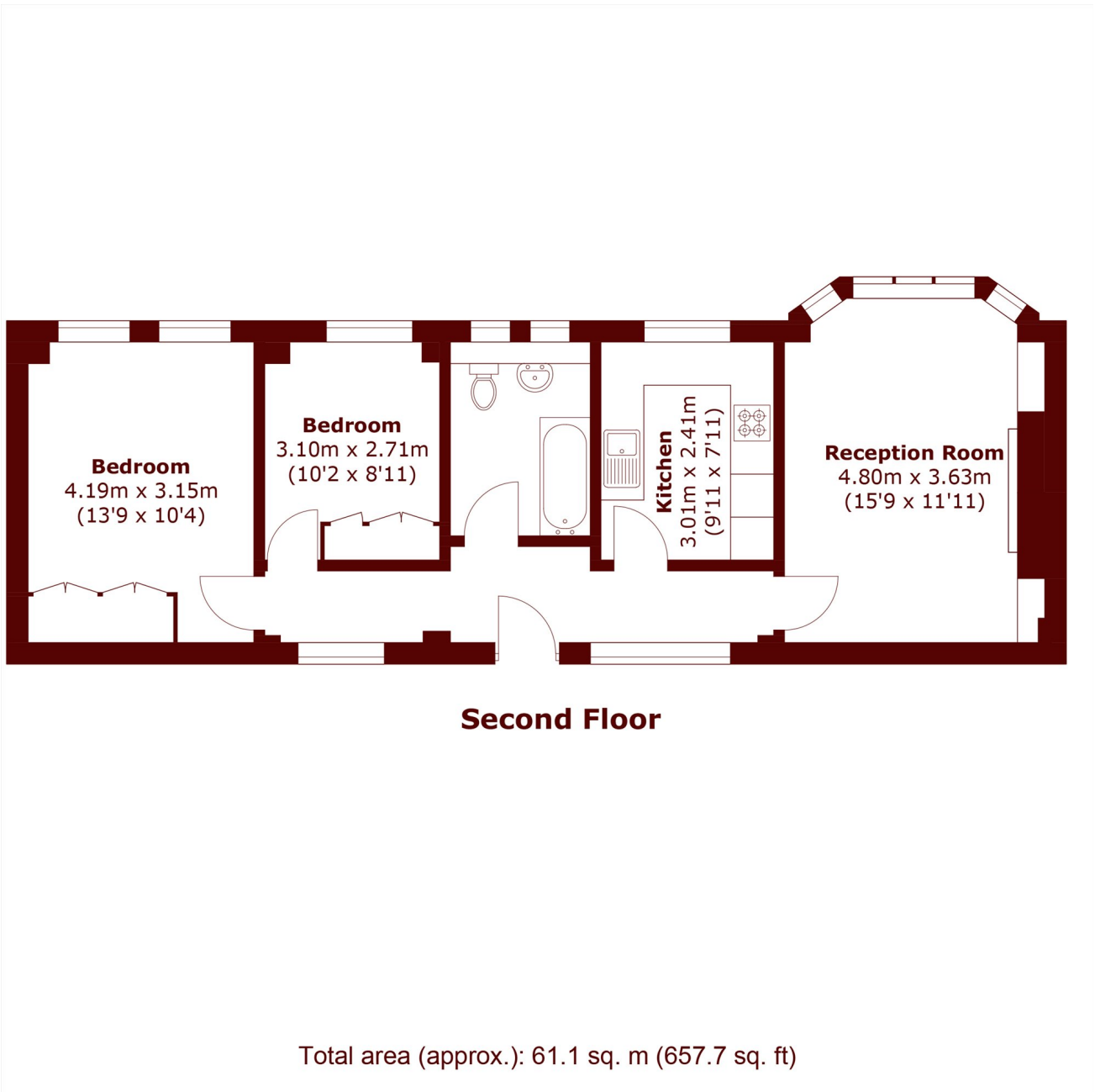

Clapham  
020 7501 3666

Energy Rating: D We aim to make our particulars both accurate and reliable. However, they are not guaranteed; nor do they form part of an offer or contract. If you require clarification on any points then please contact us, especially if you're traveling some distance to view. Please note that appliances and heating systems have not been tested and therefore no warranties can be given as to their good working order

MARSH &  
PARSONS