

WALNUT TREE CLOSE



WALNUT TREE CLOSE

GUILDFORD, SURREY, GU1 4LG

Modern one bedroom furnished apartment in an excellent town centre location, available in June.

Available: 12th June 2026

£1,400 PCM (Per Calendar Month)

Flat, 1 Bedroom, 1 Bathroom, 1 Reception,
Furnished

Key Features

- Town centre location
- Furnished
- Balcony
- Double bedroom
- Open plan living room/kitchen
- Available June





THE PROPERTY

Description

Built in 2016 by Barratt Homes, this apartment is presented in a modern fashion throughout and includes an open plan living room and kitchen with hard flooring and integrated appliances including a gas hob, electric oven, dish washer, fridge, freezer and washing machine. The bedroom is carpeted and includes an aspect over the inner yard of the block. There is a bathroom with a shower over the bath.



Location

King Edwards Court is located in a hugely convenient location for Guildford town centre and the main line station both within walking distance.

Guildford Borough Council tax band C

EPC Band C

Available June

Holding deposit: £323

To check broadband and mobile phone coverage please visit Ofcom here: ofcom.org.uk/phones-telecoms-and-internet/advice-for-consumers/advice/ofcom-checker

King Edwards Court, Walnut Tree Close, Guildford, GU1

Approximate Area = 482 sq ft / 43 sq m
For identification only - Not to scale

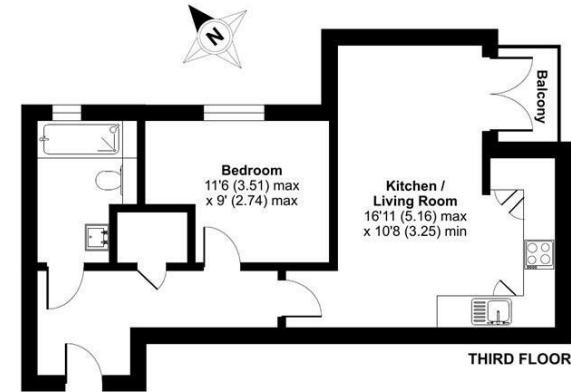

Floor plan produced in accordance with RICS Property Measurement 2nd Edition, Incorporating International Property Measurement Standards (IPMS2 Residential). © rdxcom 2025. Produced for Grantleys. REF: 1279706

Guildford

Poyle House 24 Epsom Road

Guildford

Surrey

GU1 3LE

Tel: 01483 407600

 **GRANTLEY**
SALES AND LETTINGS