



Uxbridge Road, W12

£699,000

A beautiful two bedroom apartment in the heart of Shepherd's Bush. This property has been renovated throughout by the current owner, with parquet flooring throughout, a galley high spec kitchen, two double bedrooms and a large south facing private garden.

Set back on Uxbridge Road, this property is conveniently located by Shepherd's Bush Market and its station on the Hammersmith City and Circle lines. The central line is also close by and it has all the shops, restaurants and amenities of Westfield Shopping Centre down the road.

Features

- No Onward Chain
- Fully Refurbished
- Private South Facing Garden
- Parquet Flooring
- Askew Village
- Westfields White City

Uxbridge Road, London, W12

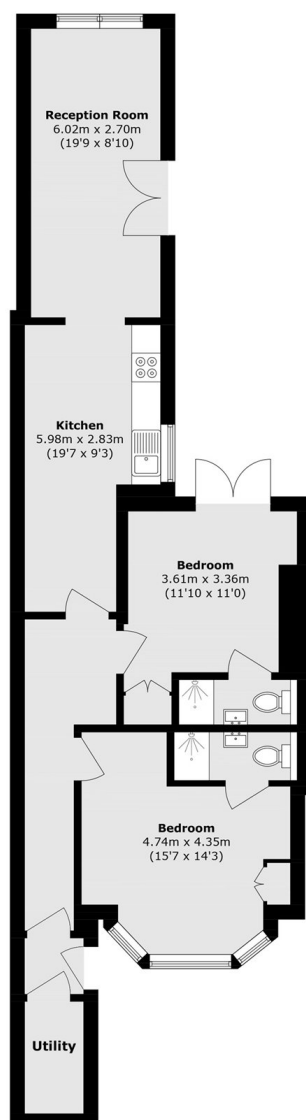

Total area (approx.): 82.2 sq. m (884.8 sq. ft)

Dexters

Shepherds Bush and Brook Green
53 Shepherds Bush Green
London
W12 8PS
Sales
020 8740 2900

Energy Rating: TBC. We aim to make our particulars both accurate and reliable. However they are not guaranteed; nor do they form part of an offer or contract. If you require clarification on any points then please contact us, especially if you're traveling some distance to view. Please note that appliances and heating systems have not been tested and therefore no warranties can be given as to their good working order.

 **RICS** | Regulated
Estate Agent
and Letting Agent

[dexters.co.uk](https://www.dexters.co.uk)