



## Crownstone Road, SW2

£2,600 Per calendar month

This charming three bedroom apartment offers a semi open plan reception room, an eat-in kitchen, wooden flooring and neutral interior throughout. Perfect for professional sharers or a small family.

Located close to Brixton Village, Brockwell Park and Brixton High Street. Residents have a fantastic selection of cafés, restaurants and local transport links which include Brixton overground/underground and numerous bus routes.

### Features

- Three Double Bedrooms
- Eat-In Kitchen
- Open Plan Reception
- Wooden Flooring
- Neutral Interior
- Local Transport Links

# Crownstone Road, London, SW2

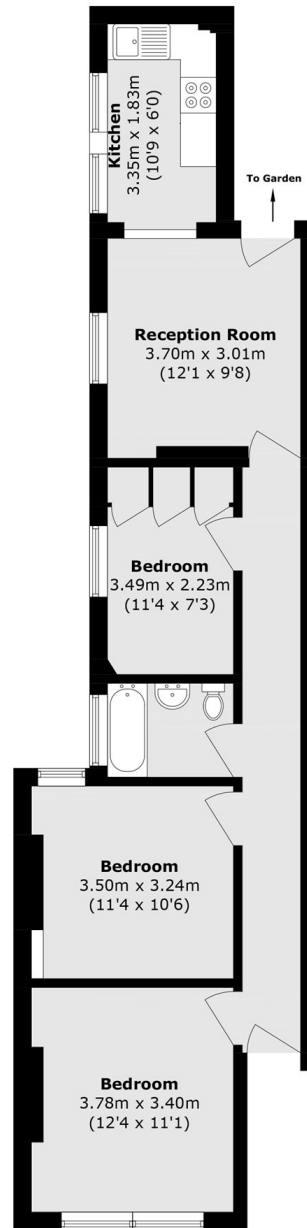

Total area (approx.): 66.0 sq. m (710.4 sq. ft)