



WHITE HART LANE, SW13

£475,000

First floor
Two double bedrooms
Spacious reception room
Private balcony
Communal gardens
Barnes

@marshandparsons
marshandparsons.co.uk

MARSH &
PARSONS

ABOUT THE PROPERTY

Marsh & Parsons are delighted to bring this two double bedroom purpose built flat on White Hart Lane to the market. Located on the first floor of a small and well-maintained development at the top of White Hart Lane, this bright and spacious two bedroom purpose built apartment is ideally positioned within the highly sought after catchment area for Barnes Primary School and East Sheen Primary along with being just moments from the vibrant heart of Little Chelsea. The flat is beautifully presented throughout, it comprises a generous reception room which is ideal for both entertaining and everyday living, two well-proportioned double bedrooms, a stylish renovated family bathroom, along with a modern fitted kitchen opening onto a private balcony with attractive









STEP INSIDE WHITE HART LANE

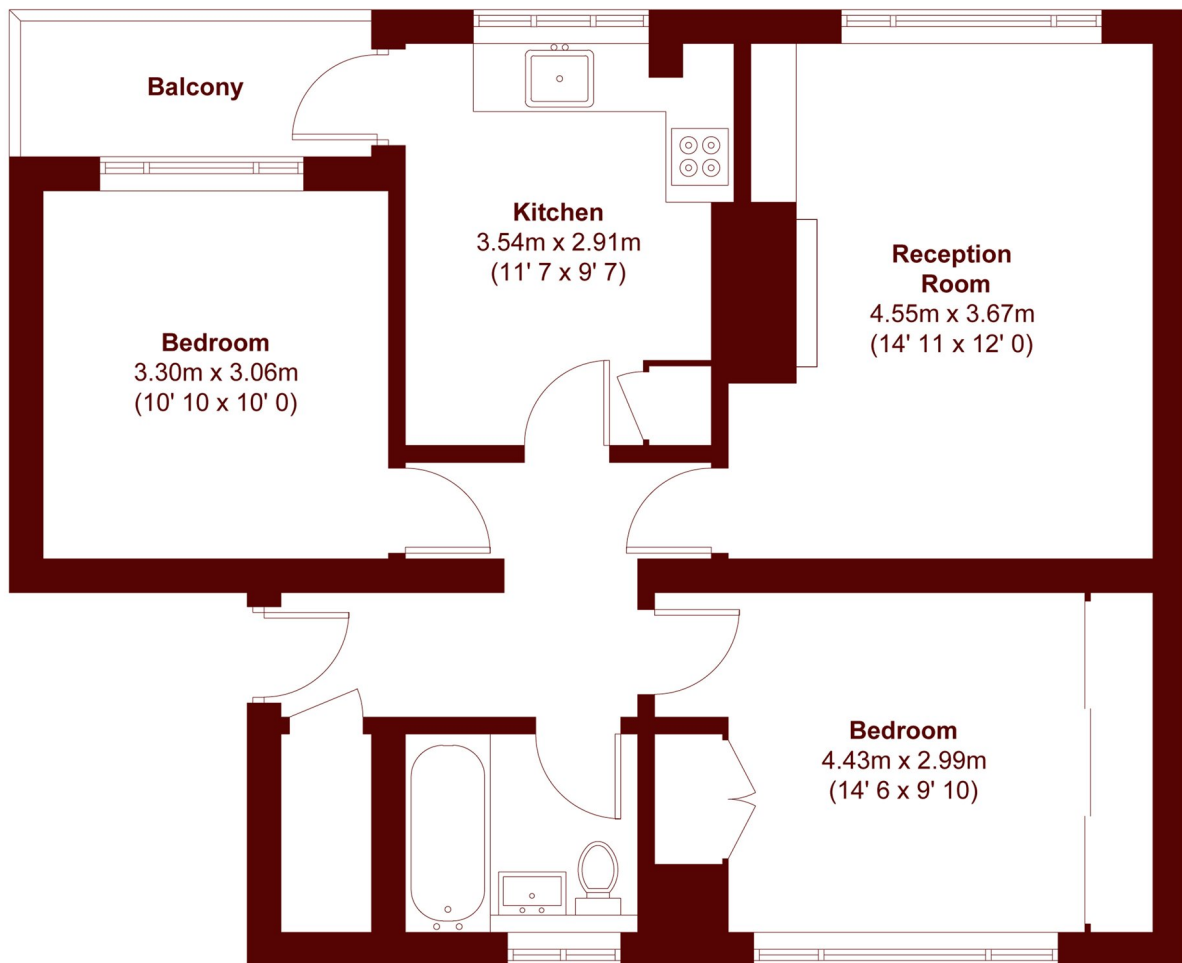

APPROX. GROSS INTERNAL FLOOR AREA = 711 SQFT / 66.1 SQM
APPROX. GROSS EXTERNAL BALCONY AREA = 40 SQFT / 3.7 SQM

Barnes & East Sheen
020 8563 8333

Energy Rating: C We aim to make our particulars both accurate and reliable. However, they are not guaranteed; nor do they form part of an offer or contract. If you require clarification on any points then please contact us, especially if you're traveling some distance to view. Please note that appliances and heating systems have not been tested and therefore no warranties can be given as to their good working order

**MARSH &
PARSONS**