



Guide Price
£280,000

Leasehold

2x  2x  1x 

**Keats Apartments,
Saffron Central Square,
Croydon, Surrey, CR0**

OVER 60?

Secure this property
for up to **59% less!**

cubitt&west
Helping you move forwards



Main features

- **Modern seventh-floor apartment in a well-maintained development**
- **No on-ward chain with a long Lease**
- **Open-plan living space, perfect for relaxing or entertaining**
- **Residents enjoy access to a communal garden, gym, lift, and secure entry system**
- **Walking distance to East & West Croydon Stations**
- **Ideal for first-time buyers, professionals, or investors**

Accommodation

SEVENTH FLOOR

Hallway
 Lounge: 17'7 x 10'4 (5.36m x 3.15m)
 Kitchen: 9'9 x 5'10 (2.97m x 1.78m)
 Bedroom 1: 13'9 x 9'5 (4.19m x 2.87m)
 En-Suite
 Bedroom 2: 12'5 x 10'6 (3.79m x 3.20m)
 Bathroom

OUTSIDE

Balcony
 Roof Garden

Seventh Floor

Approx. 65.9 sq. metres (709.0 sq. feet)

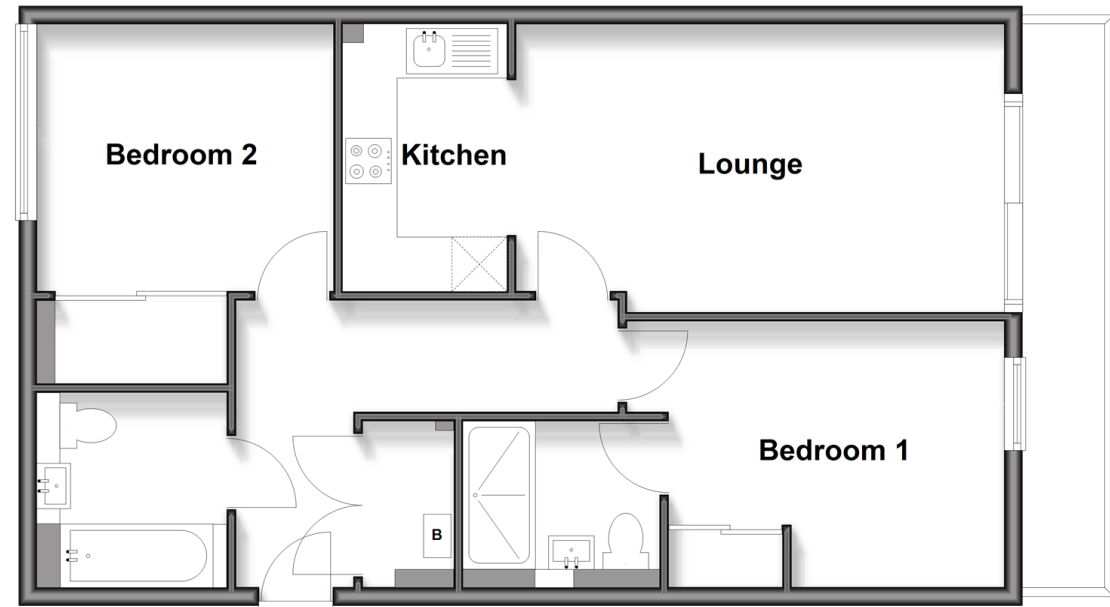

Call Shirley - 020 8654 3037 ■ cubittandwest.co.uk

■ Legal advice should be taken to verify fixtures/fittings, planning, alterations and/or lease details
 ■ Through a Homewise Home For Life Plan people aged 60+ can secure this property for up to 50% less, by purchasing a Lifetime Lease.

■ Appliances & services are untested, dimensions are approximate and floor plans are not to scale