



Flat 3

South Norwood Hill | London | SE25 6DR

Offers In Excess Of £220,000



Flat 3

South Norwood Hill |

London | SE25 6DR

Offers In Excess Of £220,000

Nestled in the sought-after area of South Norwood Hill, this delightful one-bedroom flat offers an excellent opportunity for both first-time buyers and investors alike. The property boasts a bright and airy atmosphere, making it a welcoming retreat from the hustle and bustle of daily life.

The flat features a well-proportioned reception room, perfect for relaxation or entertaining guests. The bedroom provides a comfortable space for rest, while the bathroom is conveniently located to serve both residents and visitors.

One of the standout features of this property is its good transport links, ensuring easy access to the wider London area. Whether you are commuting for work or exploring the vibrant local community, you will find that convenience is at your doorstep.

Additionally, this flat is available with no chain, allowing for a smooth and efficient purchasing

- 1 bed flat, popular location
- Great transport links nearby
- Located on South Norwood Hill
- Ideal for first-time buyers
- Bright and airy interiors
- Available with no chain
- Modern bathroom design
- Viewing highly recommended

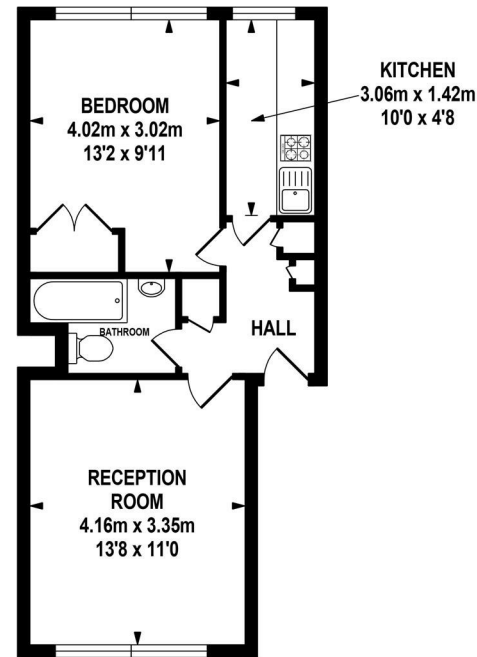

SECOND FLOOR
APPROX. FLOOR
AREA 39.28 SQ.M.
(423 SQ.FT.)

TOTAL APPROX.FLOOR AREA 39.28 SQ.M. (423 SQ.FT.)

Energy Efficiency Rating		Current	Potential
Very energy efficient - lower running costs			
(92 plus)	A		
(81-91)	B		
(69-80)	C	78	80
(55-68)	D		
(39-54)	E		
(21-38)	F		
(1-20)	G		
Not energy efficient - higher running costs			
England & Wales		EU Directive 2002/91/EC	

Council Tax Band B

EPC Rating C

467 Norwood Road

West Norwood

London

SE27 9DJ

02087610830

dean@movinginn.co.uk

www.movinginn.co.uk