

Palmyra Road BEDMINSTER

APPROXIMATE FLOOR AREA
89 SQM / 955 SQFT

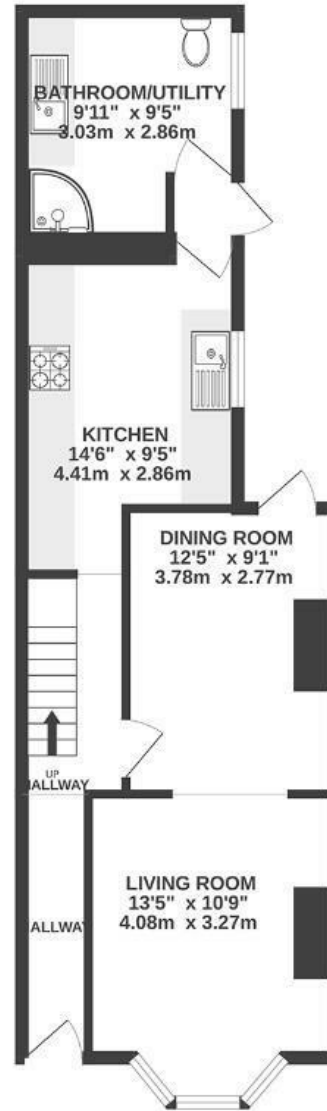

GROUND FLOOR



FIRST FLOOR



Boardwalk

Palmyra Road , BRISTOL



£435,000



3 Bedrooms



BS3 3JQ



2 Bathrooms

"We have loved living at Palmyra Road. It was our first house so will always hold a special place in our family. We've enjoyed putting our own stamp on the place. We reinstated a Victorian style fireplace in the living room, a real focal point, and also very cozy in the winter. We replaced the avocado bathroom downstairs and made a versatile utility room, which has been invaluable for storing muddy outdoor kit over the years. We've made the most of the generous back garden; alfresco dining, barbecues, even moving our ping pong table outside during the summer!"

You can't beat the location; easy walking distance to north street and all the amenities. We will miss Tobacco Factory theatre an awful lot! Its well placed to get out of the city to the South and within easy reach of some wonderful green spaces."

