



11 Arosa Drive, Birmingham, B17 0SB

£155,000

Hadleigh Estate Agents are delighted to offer this excellent first floor two bedroom apartment for sale. Located within the ever popular Arosa Drive, the property is offered with no upward chain and further benefits from garage en-bloc.

The property briefly comprises of modern fitted kitchen, spacious lounge and dining room, two double bedrooms and bathroom.

Location



Arosa Drive is a quiet and well-presented residential development featuring mature lawned areas and easy access to picturesque walks along Bourn Brook. Ideally located on the outskirts of Harborne, the property is close to the Queen Elizabeth Hospital, the University of Birmingham, and within walking distance of local shops and transport links to Birmingham City Centre and Harborne High Street.

Entrance Hallway

Accessed through the front door, the hallway provides entry to all rooms and includes three useful storage cupboards.

Lounge

A good-sized reception room with dual aspect windows. Includes a ceiling light point, gas central-heated radiator and power points.

Kitchen

Featuring a window to the rear elevation, a range of wall and base units, an additional storage cupboard housing the boiler, ceiling light point, plumbing for utilities and power points.

Master Bedroom

A double bedroom facing the rear elevation, with a gas central-heated radiator, power points and ceiling light point.

Bedroom Two

A second well-proportioned bedroom located to the front elevation, with ceiling light point, gas central-heated radiator and power points.

Bathroom

Partially tiled bathroom suite, with fitted bath and shower over. Low level flush WC, hand wash basin and towel radiator. Frosted glass window, ceiling light point and tiled flooring.

General Information

We have been advised of the following lease

information:

The lease was granted on 24/03/1965 for 999 years
Ground rent & service charge: £603.05 every six months

Council Tax Band: B

Floor Plan

Approx Gross Internal Area
52 sq m / 562 sq ft

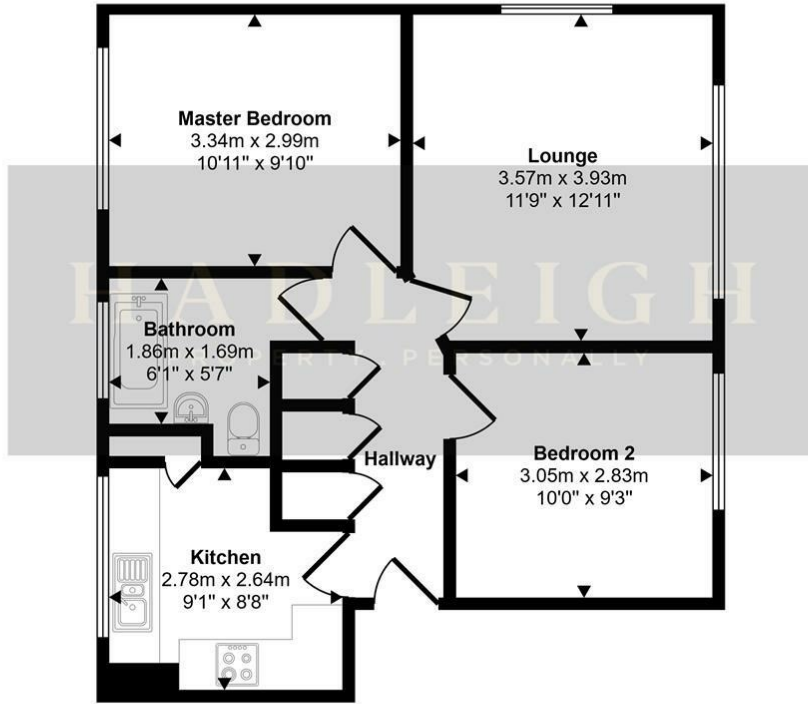

Floorplan

This floorplan is only for illustrative purposes and is not to scale. Measurements of rooms, doors, windows, and any items are approximate and no responsibility is taken for any error, omission or mis-statement. Icons of items such as bathroom suites are representations only and may not look like the real items. Made with Made Snappy 360.

Area Map

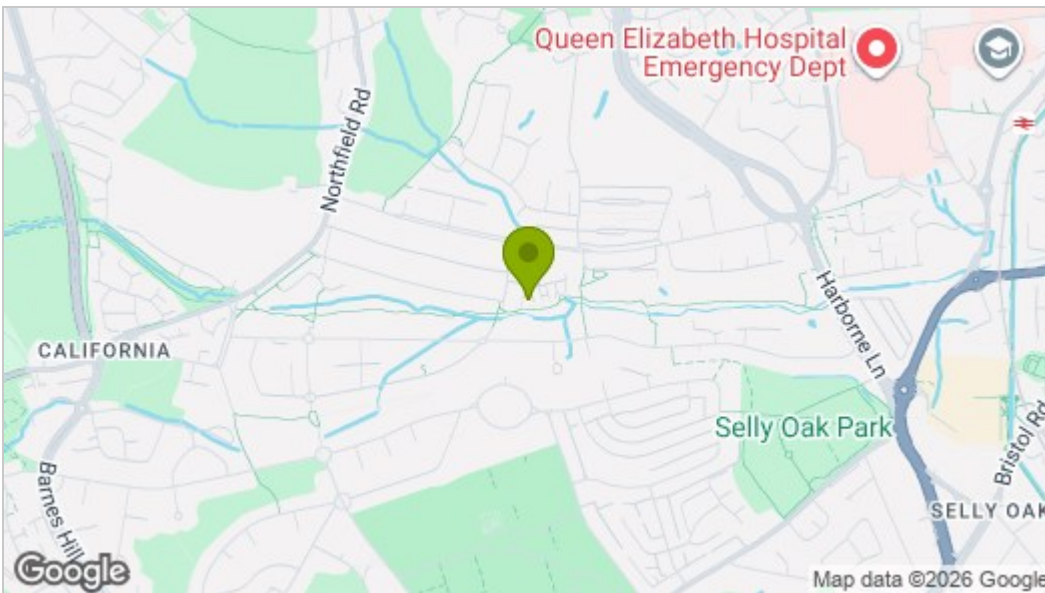

Energy Efficiency Graph

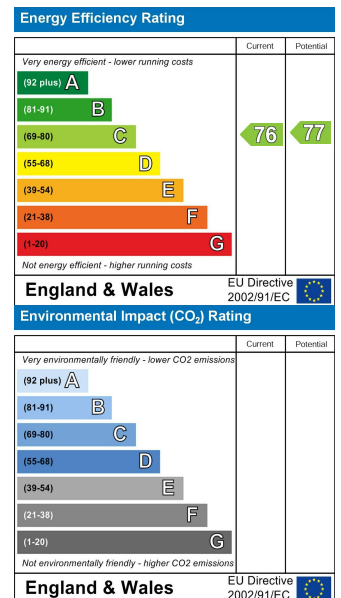

These particulars, whilst believed to be accurate are set out as a general outline only for guidance and do not constitute any part of an offer or contract. Intending purchasers should not rely on them as statements of representation of fact, but must satisfy themselves by inspection or otherwise as to their accuracy. No person in this firm's employment has the authority to make or give any representation or warranty in respect of the property.