

for sale

offers in excess of **£240,000**



Hill View Brompton Ralph TAUNTON TA4 2RX

Nestled in in a charming west Somerset village commanding an impressive **ELEVATED POSITION** with fabulous far-reaching views. **GENEROUS GARDENS** to the front and rear this well-balanced mid-terrace home has much to offer and comes highly **RECOMMENDED**.



Hill View Brompton Ralph TAUNTON TA4 2RX

Front Door

Leading to...

Entrance Porch

Leading to...

Entrance Hall

Steps rise to the first floor. Radiator.

Lounge

15' 1" max x 12' 1" (4.60m max x 3.68m)
Double glazed window to front. Radiator. Wood-burning stove.

Kitchen / Diner

18' 5" max x 10' 1" max (5.61m max x 3.07m max)
Double glazed windows to rear. Equipped with a comprehensive range of wall and base-mounted units with rolltop work surfaces, including a sink and drainer with mixer tap. Recesses include space and plumbing for an automatic washing machine and electric cooker point. Radiator.

Outer Lobby

Cloakroom

Obscure double glazed window to rear. Low-level WC, wash hand basin with splashback tile.

First Floor Landing



Main Bedroom

12' 1" max into cupboard x 12' 2" (3.68m max into cupboard x 3.71m)

Double glazed window to front. Radiator.

Bedroom Two

10' 2" x 9' 6" (3.10m x 2.90m)

Double glazed window to rear. Radiator.

Bedroom Three

8' 10" max x 6' 8" max (2.69m max x 2.03m max)

Double glazed window to rear. Radiator.

Bathroom

Suite comprising low-level WC, pedestal wash hand basin, bath with wall-mounted electric shower over. Obscure double glazed window to front. Heated towel rail. Partial tiling.

Rear Garden

To the rear of the property there is a generous garden beautifully constructed on several tiers, including areas laid to brick-paving, and lawn, the upper-tier also contains a superb studio/cabin with solar power.

Front Garden

A generous front garden laid to brick-paving and lawn, dissected by a hardstanding pathway, and a further enclosed area laid to bark.





Ground Floor

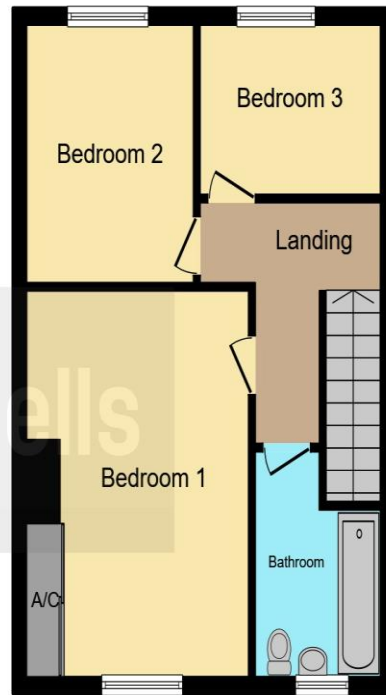

First Floor

This floor plan is for illustrative purposes only. It is not drawn to scale. Any measurements, floor areas (including any total floor area), openings and orientation are approximate. No details are guaranteed, they cannot be relied upon for any purpose and they do not form part of any agreement. No liability is taken for any error, omission or misstatement. A party must rely upon its own inspection(s). Powered by www.focalagent.com

To view this property please contact Connells on

T 01823 334 433
E taunton@connells.co.uk

53 High Street
 TAUNTON TA1 3PR

Property Ref: TTN313255 - 0011

Tenure:Freehold EPC Rating: E

Council Tax Band: B

view this property online
connells.co.uk/Property/TTN313255



1. MONEY LAUNDERING REGULATIONS Intending purchasers will be asked to produce identification documentation at a later stage and we would ask for your co-operation in order that there will be no delay in agreeing the sale. 2. These particulars do not constitute part or all of an offer or contract. 3. The measurements indicated are supplied for guidance only and as such must be considered incorrect. Potential buyers are advised to recheck measurements before committing to any expense. 4. We have not tested any apparatus, equipment, fixtures, fittings or services and it is in the buyers interest to check the working condition of any appliances.

Connells Residential is registered in England and Wales under company number 1489613, Registered Office is Cumbria House, 16-20 Hockliffe Street, Leighton Buzzard, Bedfordshire, LU7 1GN. VAT Registration Number is 500 2481 05.

see all our properties at www.connells.co.uk | www.rightmove.co.uk | www.zoopla.co.uk