

Three
bedroom
home.

The Beech

The Beech is a three-bedroom home perfect for couples and young families alike. The ground floor features a modern kitchen to the front of the home and a spacious living with French doors to the rear. There is also a downstairs W.C and a handy storage cupboard. To the first floor, you will find a master bedroom, two further bedrooms and a family bathroom. Externally there is private parking, a garage and a garden.



karbon
living

Homes for you to rent or buy.

For more information, please contact us at:

salesandlettings@karbonhomes.co.uk | **0191 223 8749**

or visit **karbonhomes.co.uk**

Images for illustration purposes only. Room sizes included have been measured from architect's plans and any furniture added is intended to give a general indication of the proposed floor layout only and does not form any part of contract.

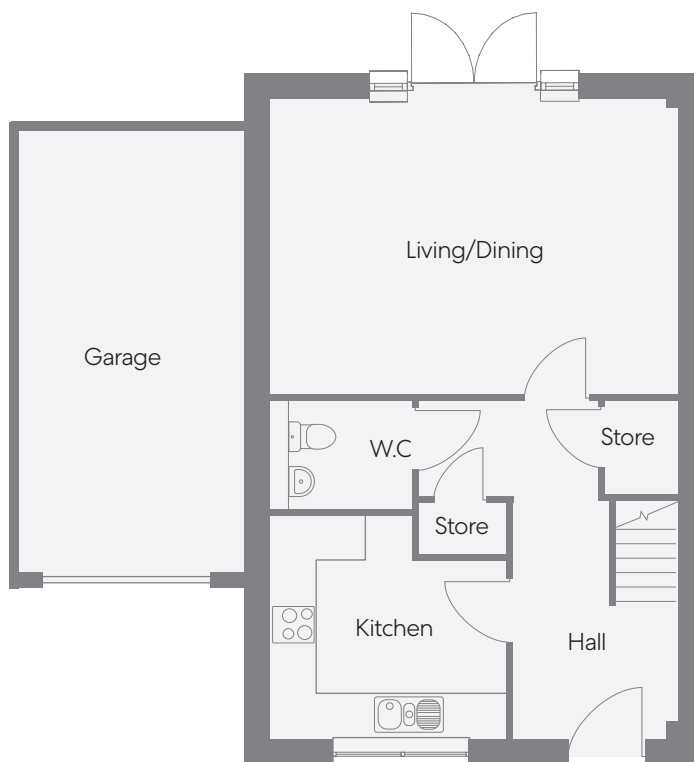

Ground Floor

Living Room

4003 x 5511

Kitchen

3001 x 3208

W.C

1493 x 1938

Garage

9327.5 x 3150



First Floor

Bedroom 1

4212 x 2788

Bedroom 2

4348 x 3236

Bedroom 3

2903 x 2661

Bathroom

1726 x 2213

karbon
living

Homes for you to rent or buy.

For more information, please contact us at:

salesandlettings@karbonhomes.co.uk | 0191 223 8749

or visit karbonhomes.co.uk