

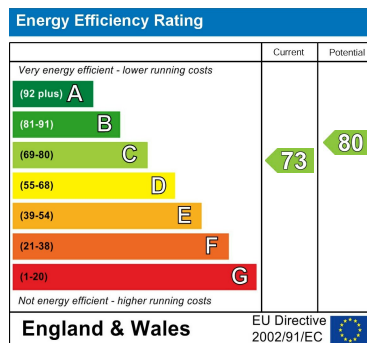

53 Rosemary Road, Cambridge, CB25 9NB
£1,350 Per month

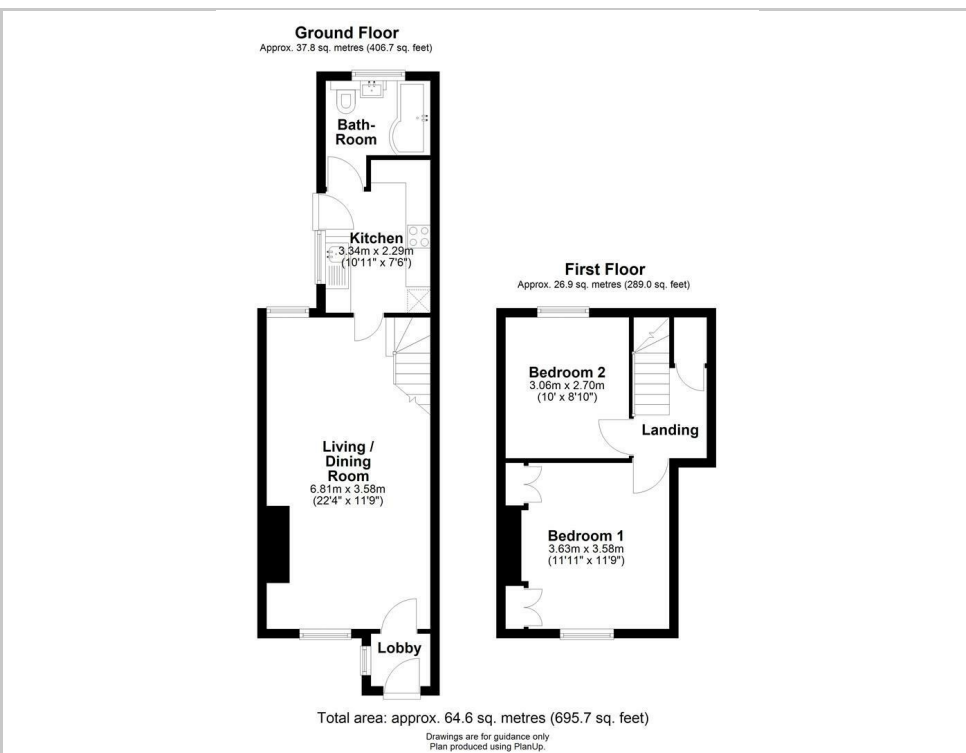

- Available immediately
- Unfurnished
- Recently refurbished
- Heart of the village

A recently refurbished two bedroom mid terrace home, located in the popular village of Waterbeach and within walking distance of all village amenities.

On entering the property, there is a porch suitable for coats and shoes, which leads into the open plan living and dining space. This room is long and spacious, with windows to both the front and rear providing excellent natural light. There are built in cupboards and shelving around the exposed brick fireplace, which is fitted with a log burner.

The kitchen is fitted with a range of high and low level units and includes a dishwasher, sink, tall fridge freezer, washing machine and an integrated gas hob and oven.

The bathroom is positioned at the rear of the ground floor and is modern in finish. It includes a shower over bath with both rainfall and standard shower heads, a wc, basin with vanity unit, illuminated mirror and windows for natural ventilation.

Upstairs, there are two good sized bedrooms. The principal bedroom is at the front and is a well proportioned double with two integrated wardrobes. The second bedroom is also a double, slightly smaller, with views over the garden. The stairs, landing and bedrooms have all been newly carpeted, and there is an airing cupboard on the landing for additional storage.

Outside, the property benefits from a good sized garden with a patio area and lawn. There is also a garage and off street parking, as well as rear access to the property.

The property is available immediately and is offered unfurnished.

Council Tax Band: C EPC: C

///starter.reprints.dinosaur



These particulars, whilst believed to be accurate are set out as a general outline only for guidance and do not constitute any part of an offer or contract. Intending purchasers should not rely on them as statements of representation of fact, but must satisfy themselves by inspection or otherwise as to their accuracy. No person in this firms employment has the authority to make or give any representation or warranty in respect of the property.

Cambridge Victoria: 154-156 Victoria Road, Cambridge, CB4 3DZ
01223 439 888 theteam@grayandtoynbee.com

Cambridge South: Adkins Corner, Perne Road, Cambridge CB1 3RU
01223 439 555 theteam@grayandtoynbee.com

Waterbeach: 17 High Street, Waterbeach, CB25 9JU
01223 949 444 waterbeach@grayandtoynbee.com