

for sale

£300,000



Wicks Drive CHIPPENHAM SN15 3FS

Well-presented three-bedroom end-terraced property offering a fantastic opportunity for families, first-time buyers, or investors alike. The property offers Lounge/Diner, Kitchen and Conservatory, Three Bedrooms, Family Bathroom and integral Garage.



Wicks Drive CHIPPENHAM SN15 3FS

Description

Situated in the desirable residential area of Pewsham, this well-presented three-bedroom end-terraced property offers a fantastic opportunity for families, first-time buyers, or investors alike.

The ground floor comprises an entrance porch leading through to a bright and spacious lounge/diner, perfect for relaxing or entertaining. To the rear, a modern fitted kitchen/dining area provides ample storage and workspace, with space for appliances and direct access to the garden, creating an ideal setting for everyday living.

There is also a well proportioned conservatory offering additional living/entertaining space.

Upstairs, the property features three well-proportioned bedrooms, including two generous doubles and a comfortable single, all

served by a contemporary family bathroom.

Externally, the home benefits from its end-terrace position, offering additional privacy and side access. The enclosed rear garden is low maintenance and ideal for outdoor dining, while the front provides off-road parking leading to an integral Garage.

Conveniently located close to local amenities, schools, and transport links, this property combines comfort, practicality, and accessibility.

Early viewing is highly recommended to fully appreciate what this home has to offer.



Ground Floor

Entrance Porch

Entrance door to front leading through to Lounge/Diner.

Lounge/Diner

Window to front. Stairs to First Floor. TV point. French doors to Conservatory.

Kitchen

Window and door to rear. Fitted with a matching range of base and wall units with complementary work surfaces over with inset sink and drainer. Plumbing for washing machine. Integrated oven and hob with cooker hood over.

Conservatory

French doors to rear.

First Floor

Landing

Stairs from Ground Floor. Doors to all rooms.

Bedroom One

Window to rear. Built in wardrobes.

Bedroom Two

Window to front.

Bedroom Three

Window to rear.

Bathroom

Suite comprising low level WC, vanity wash hand basin and panelled bath with mixer tap and shower attachment. Glass shower screen door. Window to front.

Outside

Front

Front garden laid to decorative stone. Driveway leading to Integral Garage.

Rear Garden

Fully enclosed. Lawn area, shrub borders and decorative circular patio.



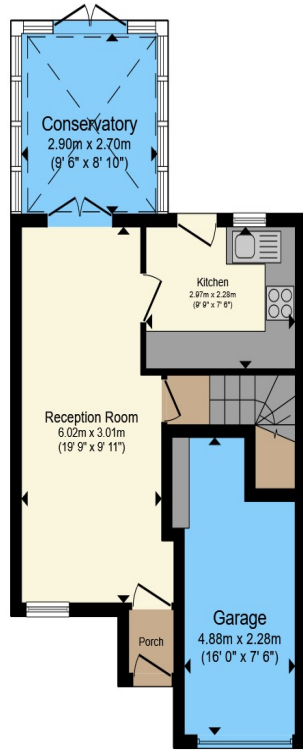

Ground Floor

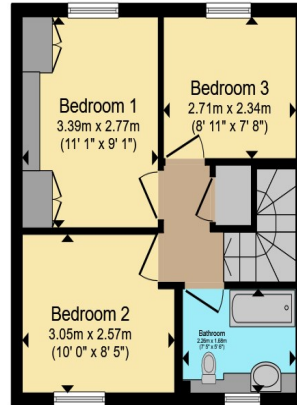

First Floor

Total floor area 79.9 m² (860 sq.ft.) approx

This floor plan is for illustrative purposes only. It is not drawn to scale. Any measurements, floor areas (including any total floor area), openings and orientation are approximate. No details are guaranteed, they cannot be relied upon for any purpose and they do not form part of any agreement. No liability is taken for any error, omission or misstatement. A party must rely upon its own inspection(s). Powered by www.propertybox.io



To view this property please contact Connells on

T 01249 652 476
E chippenham@connells.co.uk

59 Market Place
 CHIPPENHAM SN15 3HL

Property Ref: CHM306600 - 0002

Tenure:Freehold EPC Rating: C

Council Tax Band: C

view this property online
connells.co.uk/Property/CHM306600



1. MONEY LAUNDERING REGULATIONS Intending purchasers will be asked to produce identification documentation at a later stage and we would ask for your co-operation in order that there will be no delay in agreeing the sale. 2. These particulars do not constitute part or all of an offer or contract. 3. The measurements indicated are supplied for guidance only and as such must be considered incorrect. Potential buyers are advised to recheck measurements before committing to any expense. 4. We have not tested any apparatus, equipment, fixtures, fittings or services and it is in the buyers interest to check the working condition of any appliances.

Connells Residential is registered in England and Wales under company number 1489613, Registered Office is Cumbria House, 16-20 Hockliffe Street, Leighton Buzzard, Bedfordshire, LU7 1GN. VAT Registration Number is 500 2481 05.

see all our properties at www.connells.co.uk | www.rightmove.co.uk | www.zoopla.co.uk

for sale

£300,000



Wicks Drive CHIPPENHAM SN15 3FS

Well-presented three-bedroom end-terraced property offering a fantastic opportunity for families, first-time buyers, or investors alike. The property offers Lounge/Diner, Kitchen and Conservatory, Three Bedrooms, Family Bathroom and integral Garage.



Wicks Drive CHIPPENHAM SN15 3FS

Description

Situated in the desirable residential area of Pewsham, this well-presented three-bedroom end-terraced property offers a fantastic opportunity for families, first-time buyers, or investors alike.

The ground floor comprises an entrance porch leading through to a bright and spacious lounge/diner, perfect for relaxing or entertaining. To the rear, a modern fitted kitchen/dining area provides ample storage and workspace, with space for appliances and direct access to the garden, creating an ideal setting for everyday living.

There is also a well proportioned conservatory offering additional living/entertaining space.

Upstairs, the property features three well-proportioned bedrooms, including two generous doubles and a comfortable single, all

served by a contemporary family bathroom.

Externally, the home benefits from its end-terrace position, offering additional privacy and side access. The enclosed rear garden is low maintenance and ideal for outdoor dining, while the front provides off-road parking leading to an integral Garage.

Conveniently located close to local amenities, schools, and transport links, this property combines comfort, practicality, and accessibility.

Early viewing is highly recommended to fully appreciate what this home has to offer.



Ground Floor

Entrance Porch

Entrance door to front leading through to Lounge/Diner.

Lounge/Diner

Window to front. Stairs to First Floor. TV point. French doors to Conservatory.

Kitchen

Window and door to rear. Fitted with a matching range of base and wall units with complementary work surfaces over with inset sink and drainer. Plumbing for washing machine. Integrated oven and hob with cooker hood over.

Conservatory

French doors to rear.

First Floor

Landing

Stairs from Ground Floor. Doors to all rooms.

Bedroom One

Window to rear. Built in wardrobes.

Bedroom Two

Window to front.

Bedroom Three

Window to rear.

Bathroom

Suite comprising low level WC, vanity wash hand basin and panelled bath with mixer tap and shower attachment. Glass shower screen door. Window to front.

Outside

Front

Front garden laid to decorative stone. Driveway leading to Integral Garage.

Rear Garden

Fully enclosed. Lawn area, shrub borders and decorative circular patio.



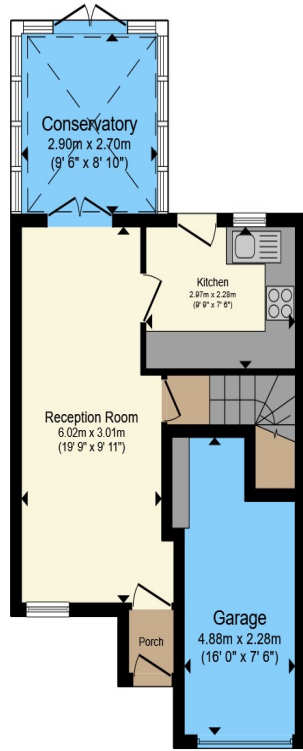

Ground Floor

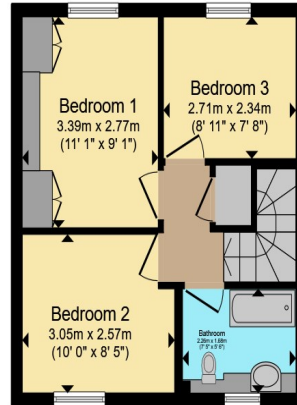

First Floor

Total floor area 79.9 m² (860 sq.ft.) approx

This floor plan is for illustrative purposes only. It is not drawn to scale. Any measurements, floor areas (including any total floor area), openings and orientation are approximate. No details are guaranteed, they cannot be relied upon for any purpose and they do not form part of any agreement. No liability is taken for any error, omission or misstatement. A party must rely upon its own inspection(s). Powered by www.propertybox.io



To view this property please contact Connells on

T 01249 652 476
E chippenham@connells.co.uk

59 Market Place
 CHIPPENHAM SN15 3HL

Property Ref: CHM306600 - 0002

Tenure:Freehold EPC Rating: C

Council Tax Band: C

view this property online
connells.co.uk/Property/CHM306600



1. MONEY LAUNDERING REGULATIONS Intending purchasers will be asked to produce identification documentation at a later stage and we would ask for your co-operation in order that there will be no delay in agreeing the sale. 2. These particulars do not constitute part or all of an offer or contract. 3. The measurements indicated are supplied for guidance only and as such must be considered incorrect. Potential buyers are advised to recheck measurements before committing to any expense. 4. We have not tested any apparatus, equipment, fixtures, fittings or services and it is in the buyers interest to check the working condition of any appliances.

Connells Residential is registered in England and Wales under company number 1489613, Registered Office is Cumbria House, 16-20 Hockliffe Street, Leighton Buzzard, Bedfordshire, LU7 1GN. VAT Registration Number is 500 2481 05.

see all our properties at www.connells.co.uk | www.rightmove.co.uk | www.zoopla.co.uk

for sale

£300,000



Wicks Drive CHIPPENHAM SN15 3FS

Well-presented three-bedroom end-terraced property offering a fantastic opportunity for families, first-time buyers, or investors alike. The property offers Lounge/Diner, Kitchen and Conservatory, Three Bedrooms, Family Bathroom and integral Garage.



Wicks Drive CHIPPENHAM SN15 3FS

Description

Situated in the desirable residential area of Pewsham, this well-presented three-bedroom end-terraced property offers a fantastic opportunity for families, first-time buyers, or investors alike.

The ground floor comprises an entrance porch leading through to a bright and spacious lounge/diner, perfect for relaxing or entertaining. To the rear, a modern fitted kitchen/dining area provides ample storage and workspace, with space for appliances and direct access to the garden, creating an ideal setting for everyday living.

There is also a well proportioned conservatory offering additional living/entertaining space.

Upstairs, the property features three well-proportioned bedrooms, including two generous doubles and a comfortable single, all

served by a contemporary family bathroom.

Externally, the home benefits from its end-terrace position, offering additional privacy and side access. The enclosed rear garden is low maintenance and ideal for outdoor dining, while the front provides off-road parking leading to an integral Garage.

Conveniently located close to local amenities, schools, and transport links, this property combines comfort, practicality, and accessibility.

Early viewing is highly recommended to fully appreciate what this home has to offer.



Ground Floor

Entrance Porch

Entrance door to front leading through to Lounge/Diner.

Lounge/Diner

Window to front. Stairs to First Floor. TV point. French doors to Conservatory.

Kitchen

Window and door to rear. Fitted with a matching range of base and wall units with complementary work surfaces over with inset sink and drainer. Plumbing for washing machine. Integrated oven and hob with cooker hood over.

Conservatory

French doors to rear.

First Floor

Landing

Stairs from Ground Floor. Doors to all rooms.

Bedroom One

Window to rear. Built in wardrobes.

Bedroom Two

Window to front.

Bedroom Three

Window to rear.

Bathroom

Suite comprising low level WC, vanity wash hand basin and panelled bath with mixer tap and shower attachment. Glass shower screen door. Window to front.

Outside

Front

Front garden laid to decorative stone. Driveway leading to Integral Garage.

Rear Garden

Fully enclosed. Lawn area, shrub borders and decorative circular patio.



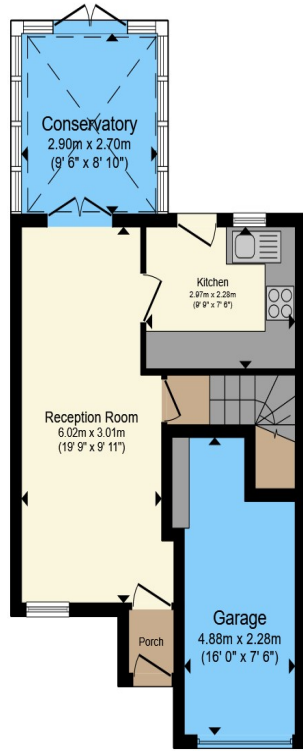

Ground Floor

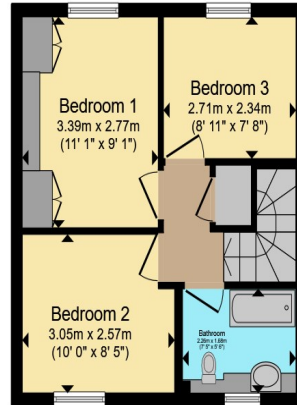

First Floor

Total floor area 79.9 m² (860 sq.ft.) approx

This floor plan is for illustrative purposes only. It is not drawn to scale. Any measurements, floor areas (including any total floor area), openings and orientation are approximate. No details are guaranteed, they cannot be relied upon for any purpose and they do not form part of any agreement. No liability is taken for any error, omission or misstatement. A party must rely upon its own inspection(s). Powered by www.propertybox.io



To view this property please contact Connells on

T 01249 652 476
E chippenham@connells.co.uk

59 Market Place
 CHIPPENHAM SN15 3HL

Property Ref: CHM306600 - 0002

Tenure:Freehold EPC Rating: C

Council Tax Band: C

view this property online
connells.co.uk/Property/CHM306600



1. MONEY LAUNDERING REGULATIONS Intending purchasers will be asked to produce identification documentation at a later stage and we would ask for your co-operation in order that there will be no delay in agreeing the sale. 2. These particulars do not constitute part or all of an offer or contract. 3. The measurements indicated are supplied for guidance only and as such must be considered incorrect. Potential buyers are advised to recheck measurements before committing to any expense. 4. We have not tested any apparatus, equipment, fixtures, fittings or services and it is in the buyers interest to check the working condition of any appliances.

Connells Residential is registered in England and Wales under company number 1489613, Registered Office is Cumbria House, 16-20 Hockliffe Street, Leighton Buzzard, Bedfordshire, LU7 1GN. VAT Registration Number is 500 2481 05.

see all our properties at www.connells.co.uk | www.rightmove.co.uk | www.zoopla.co.uk

for sale

£300,000



Wicks Drive CHIPPENHAM SN15 3FS

Well-presented three-bedroom end-terraced property offering a fantastic opportunity for families, first-time buyers, or investors alike. The property offers Lounge/Diner, Kitchen and Conservatory, Three Bedrooms, Family Bathroom and integral Garage.



Wicks Drive CHIPPENHAM SN15 3FS

Description

Situated in the desirable residential area of Pewsham, this well-presented three-bedroom end-terraced property offers a fantastic opportunity for families, first-time buyers, or investors alike.

The ground floor comprises an entrance porch leading through to a bright and spacious lounge/diner, perfect for relaxing or entertaining. To the rear, a modern fitted kitchen/dining area provides ample storage and workspace, with space for appliances and direct access to the garden, creating an ideal setting for everyday living.

There is also a well proportioned conservatory offering additional living/entertaining space.

Upstairs, the property features three well-proportioned bedrooms, including two generous doubles and a comfortable single, all

served by a contemporary family bathroom.

Externally, the home benefits from its end-terrace position, offering additional privacy and side access. The enclosed rear garden is low maintenance and ideal for outdoor dining, while the front provides off-road parking leading to an integral Garage.

Conveniently located close to local amenities, schools, and transport links, this property combines comfort, practicality, and accessibility.

Early viewing is highly recommended to fully appreciate what this home has to offer.



Ground Floor

Entrance Porch

Entrance door to front leading through to Lounge/Diner.

Lounge/Diner

Window to front. Stairs to First Floor. TV point. French doors to Conservatory.

Kitchen

Window and door to rear. Fitted with a matching range of base and wall units with complementary work surfaces over with inset sink and drainer. Plumbing for washing machine. Integrated oven and hob with cooker hood over.

Conservatory

French doors to rear.

First Floor

Landing

Stairs from Ground Floor. Doors to all rooms.

Bedroom One

Window to rear. Built in wardrobes.

Bedroom Two

Window to front.

Bedroom Three

Window to rear.

Bathroom

Suite comprising low level WC, vanity wash hand basin and panelled bath with mixer tap and shower attachment. Glass shower screen door. Window to front.

Outside

Front

Front garden laid to decorative stone. Driveway leading to Integral Garage.

Rear Garden

Fully enclosed. Lawn area, shrub borders and decorative circular patio.



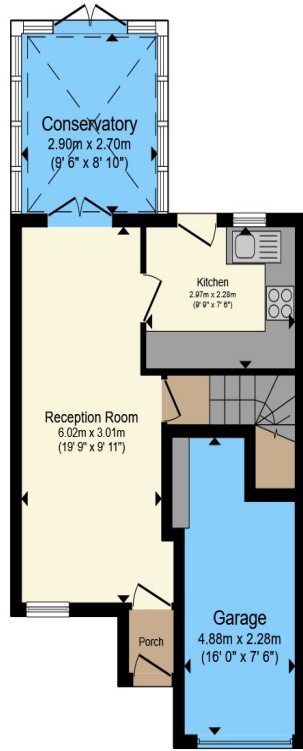

Ground Floor

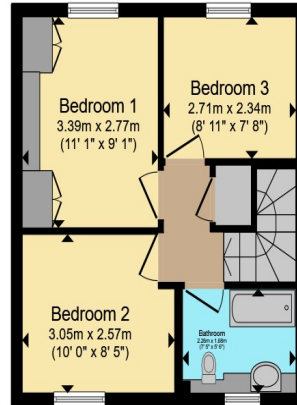

First Floor

Total floor area 79.9 m² (860 sq.ft.) approx

This floor plan is for illustrative purposes only. It is not drawn to scale. Any measurements, floor areas (including any total floor area), openings and orientation are approximate. No details are guaranteed, they cannot be relied upon for any purpose and they do not form part of any agreement. No liability is taken for any error, omission or misstatement. A party must rely upon its own inspection(s). Powered by www.propertybox.io



To view this property please contact Connells on

T 01249 652 476
E chippenham@connells.co.uk

59 Market Place
 CHIPPENHAM SN15 3HL

Property Ref: CHM306600 - 0002

Tenure:Freehold EPC Rating: C

Council Tax Band: C

view this property online
connells.co.uk/Property/CHM306600



1. MONEY LAUNDERING REGULATIONS Intending purchasers will be asked to produce identification documentation at a later stage and we would ask for your co-operation in order that there will be no delay in agreeing the sale. 2. These particulars do not constitute part or all of an offer or contract. 3. The measurements indicated are supplied for guidance only and as such must be considered incorrect. Potential buyers are advised to recheck measurements before committing to any expense. 4. We have not tested any apparatus, equipment, fixtures, fittings or services and it is in the buyers interest to check the working condition of any appliances.

Connells Residential is registered in England and Wales under company number 1489613, Registered Office is Cumbria House, 16-20 Hockliffe Street, Leighton Buzzard, Bedfordshire, LU7 1GN. VAT Registration Number is 500 2481 05.

see all our properties at www.connells.co.uk | www.rightmove.co.uk | www.zoopla.co.uk

for sale

£300,000



Wicks Drive CHIPPENHAM SN15 3FS

Well-presented three-bedroom end-terraced property offering a fantastic opportunity for families, first-time buyers, or investors alike. The property offers Lounge/Diner, Kitchen and Conservatory, Three Bedrooms, Family Bathroom and integral Garage.



Wicks Drive CHIPPENHAM SN15 3FS

Description

Situated in the desirable residential area of Pewsham, this well-presented three-bedroom end-terraced property offers a fantastic opportunity for families, first-time buyers, or investors alike.

The ground floor comprises an entrance porch leading through to a bright and spacious lounge/diner, perfect for relaxing or entertaining. To the rear, a modern fitted kitchen/dining area provides ample storage and workspace, with space for appliances and direct access to the garden, creating an ideal setting for everyday living.

There is also a well proportioned conservatory offering additional living/entertaining space.

Upstairs, the property features three well-proportioned bedrooms, including two generous doubles and a comfortable single, all

served by a contemporary family bathroom.

Externally, the home benefits from its end-terrace position, offering additional privacy and side access. The enclosed rear garden is low maintenance and ideal for outdoor dining, while the front provides off-road parking leading to an integral Garage.

Conveniently located close to local amenities, schools, and transport links, this property combines comfort, practicality, and accessibility.

Early viewing is highly recommended to fully appreciate what this home has to offer.



Ground Floor

Entrance Porch

Entrance door to front leading through to Lounge/Diner.

Lounge/Diner

Window to front. Stairs to First Floor. TV point. French doors to Conservatory.

Kitchen

Window and door to rear. Fitted with a matching range of base and wall units with complementary work surfaces over with inset sink and drainer. Plumbing for washing machine. Integrated oven and hob with cooker hood over.

Conservatory

French doors to rear.

First Floor

Landing

Stairs from Ground Floor. Doors to all rooms.

Bedroom One

Window to rear. Built in wardrobes.

Bedroom Two

Window to front.

Bedroom Three

Window to rear.

Bathroom

Suite comprising low level WC, vanity wash hand basin and panelled bath with mixer tap and shower attachment. Glass shower screen door. Window to front.

Outside

Front

Front garden laid to decorative stone. Driveway leading to Integral Garage.

Rear Garden

Fully enclosed. Lawn area, shrub borders and decorative circular patio.



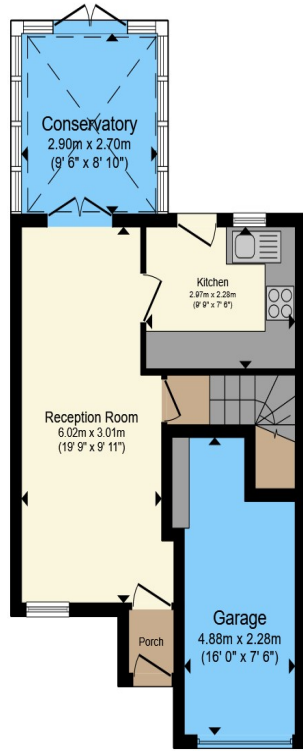

Ground Floor

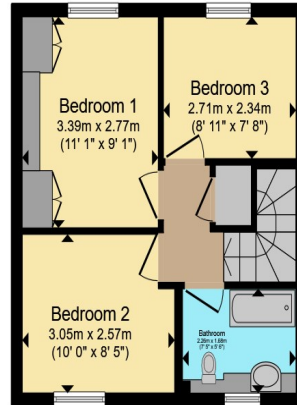

First Floor

Total floor area 79.9 m² (860 sq.ft.) approx

This floor plan is for illustrative purposes only. It is not drawn to scale. Any measurements, floor areas (including any total floor area), openings and orientation are approximate. No details are guaranteed, they cannot be relied upon for any purpose and they do not form part of any agreement. No liability is taken for any error, omission or misstatement. A party must rely upon its own inspection(s). Powered by www.propertybox.io



To view this property please contact Connells on

T 01249 652 476
E chippenham@connells.co.uk

59 Market Place
 CHIPPENHAM SN15 3HL

Property Ref: CHM306600 - 0002

Tenure:Freehold EPC Rating: C

Council Tax Band: C

view this property online
connells.co.uk/Property/CHM306600



1. MONEY LAUNDERING REGULATIONS Intending purchasers will be asked to produce identification documentation at a later stage and we would ask for your co-operation in order that there will be no delay in agreeing the sale. 2. These particulars do not constitute part or all of an offer or contract. 3. The measurements indicated are supplied for guidance only and as such must be considered incorrect. Potential buyers are advised to recheck measurements before committing to any expense. 4. We have not tested any apparatus, equipment, fixtures, fittings or services and it is in the buyers interest to check the working condition of any appliances.

Connells Residential is registered in England and Wales under company number 1489613, Registered Office is Cumbria House, 16-20 Hockliffe Street, Leighton Buzzard, Bedfordshire, LU7 1GN. VAT Registration Number is 500 2481 05.

see all our properties at www.connells.co.uk | www.rightmove.co.uk | www.zoopla.co.uk

for sale

£300,000



Wicks Drive CHIPPENHAM SN15 3FS

Well-presented three-bedroom end-terraced property offering a fantastic opportunity for families, first-time buyers, or investors alike. The property offers Lounge/Diner, Kitchen and Conservatory, Three Bedrooms, Family Bathroom and integral Garage.



Wicks Drive CHIPPENHAM SN15 3FS

Description

Situated in the desirable residential area of Pewsham, this well-presented three-bedroom end-terraced property offers a fantastic opportunity for families, first-time buyers, or investors alike.

The ground floor comprises an entrance porch leading through to a bright and spacious lounge/diner, perfect for relaxing or entertaining. To the rear, a modern fitted kitchen/dining area provides ample storage and workspace, with space for appliances and direct access to the garden, creating an ideal setting for everyday living.

There is also a well proportioned conservatory offering additional living/entertaining space.

Upstairs, the property features three well-proportioned bedrooms, including two generous doubles and a comfortable single, all

served by a contemporary family bathroom.

Externally, the home benefits from its end-terrace position, offering additional privacy and side access. The enclosed rear garden is low maintenance and ideal for outdoor dining, while the front provides off-road parking leading to an integral Garage.

Conveniently located close to local amenities, schools, and transport links, this property combines comfort, practicality, and accessibility.

Early viewing is highly recommended to fully appreciate what this home has to offer.



Ground Floor

Entrance Porch

Entrance door to front leading through to Lounge/Diner.

Lounge/Diner

Window to front. Stairs to First Floor. TV point. French doors to Conservatory.

Kitchen

Window and door to rear. Fitted with a matching range of base and wall units with complementary work surfaces over with inset sink and drainer. Plumbing for washing machine. Integrated oven and hob with cooker hood over.

Conservatory

French doors to rear.

First Floor

Landing

Stairs from Ground Floor. Doors to all rooms.

Bedroom One

Window to rear. Built in wardrobes.

Bedroom Two

Window to front.

Bedroom Three

Window to rear.

Bathroom

Suite comprising low level WC, vanity wash hand basin and panelled bath with mixer tap and shower attachment. Glass shower screen door. Window to front.

Outside

Front

Front garden laid to decorative stone. Driveway leading to Integral Garage.

Rear Garden

Fully enclosed. Lawn area, shrub borders and decorative circular patio.



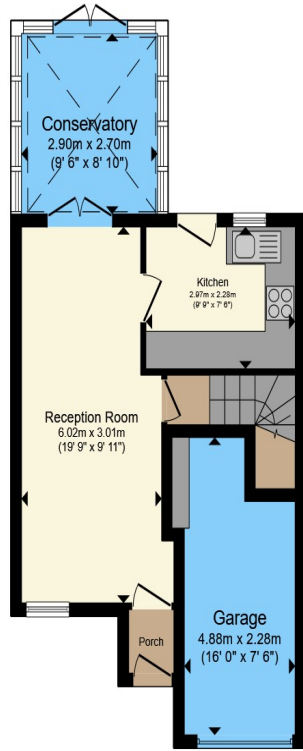

Ground Floor

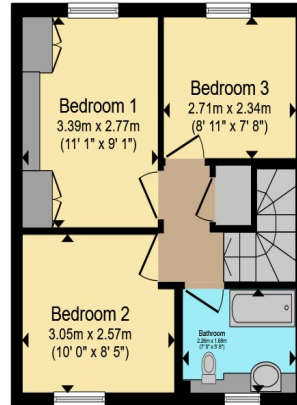

First Floor

Total floor area 79.9 m² (860 sq.ft.) approx

This floor plan is for illustrative purposes only. It is not drawn to scale. Any measurements, floor areas (including any total floor area), openings and orientation are approximate. No details are guaranteed, they cannot be relied upon for any purpose and they do not form part of any agreement. No liability is taken for any error, omission or misstatement. A party must rely upon its own inspection(s). Powered by www.propertybox.io



To view this property please contact Connells on

T 01249 652 476
E chippenham@connells.co.uk

59 Market Place
 CHIPPENHAM SN15 3HL

Property Ref: CHM306600 - 0002

Tenure:Freehold EPC Rating: C

Council Tax Band: C

view this property online
connells.co.uk/Property/CHM306600



1. MONEY LAUNDERING REGULATIONS Intending purchasers will be asked to produce identification documentation at a later stage and we would ask for your co-operation in order that there will be no delay in agreeing the sale. 2. These particulars do not constitute part or all of an offer or contract. 3. The measurements indicated are supplied for guidance only and as such must be considered incorrect. Potential buyers are advised to recheck measurements before committing to any expense. 4. We have not tested any apparatus, equipment, fixtures, fittings or services and it is in the buyers interest to check the working condition of any appliances.

Connells Residential is registered in England and Wales under company number 1489613, Registered Office is Cumbria House, 16-20 Hockliffe Street, Leighton Buzzard, Bedfordshire, LU7 1GN. VAT Registration Number is 500 2481 05.

see all our properties at www.connells.co.uk | www.rightmove.co.uk | www.zoopla.co.uk

for sale

£300,000



Wicks Drive CHIPPENHAM SN15 3FS

Well-presented three-bedroom end-terraced property offering a fantastic opportunity for families, first-time buyers, or investors alike. The property offers Lounge/Diner, Kitchen and Conservatory, Three Bedrooms, Family Bathroom and integral Garage.



Wicks Drive CHIPPENHAM SN15 3FS

Description

Situated in the desirable residential area of Pewsham, this well-presented three-bedroom end-terraced property offers a fantastic opportunity for families, first-time buyers, or investors alike.

The ground floor comprises an entrance porch leading through to a bright and spacious lounge/diner, perfect for relaxing or entertaining. To the rear, a modern fitted kitchen/dining area provides ample storage and workspace, with space for appliances and direct access to the garden, creating an ideal setting for everyday living.

There is also a well proportioned conservatory offering additional living/entertaining space.

Upstairs, the property features three well-proportioned bedrooms, including two generous doubles and a comfortable single, all

served by a contemporary family bathroom.

Externally, the home benefits from its end-terrace position, offering additional privacy and side access. The enclosed rear garden is low maintenance and ideal for outdoor dining, while the front provides off-road parking leading to an integral Garage.

Conveniently located close to local amenities, schools, and transport links, this property combines comfort, practicality, and accessibility.

Early viewing is highly recommended to fully appreciate what this home has to offer.



Ground Floor

Entrance Porch

Entrance door to front leading through to Lounge/Diner.

Lounge/Diner

Window to front. Stairs to First Floor. TV point. French doors to Conservatory.

Kitchen

Window and door to rear. Fitted with a matching range of base and wall units with complementary work surfaces over with inset sink and drainer. Plumbing for washing machine. Integrated oven and hob with cooker hood over.

Conservatory

French doors to rear.

First Floor

Landing

Stairs from Ground Floor. Doors to all rooms.

Bedroom One

Window to rear. Built in wardrobes.

Bedroom Two

Window to front.

Bedroom Three

Window to rear.

Bathroom

Suite comprising low level WC, vanity wash hand basin and panelled bath with mixer tap and shower attachment. Glass shower screen door. Window to front.

Outside

Front

Front garden laid to decorative stone. Driveway leading to Integral Garage.

Rear Garden

Fully enclosed. Lawn area, shrub borders and decorative circular patio.



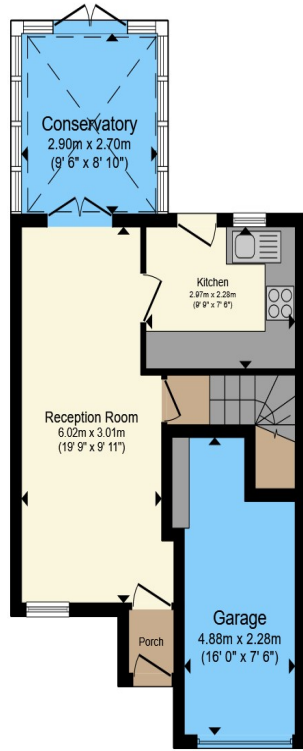

Ground Floor

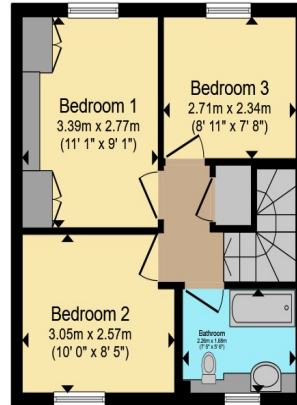

First Floor

Total floor area 79.9 m² (860 sq.ft.) approx

This floor plan is for illustrative purposes only. It is not drawn to scale. Any measurements, floor areas (including any total floor area), openings and orientation are approximate. No details are guaranteed, they cannot be relied upon for any purpose and they do not form part of any agreement. No liability is taken for any error, omission or misstatement. A party must rely upon its own inspection(s). Powered by www.propertybox.io



To view this property please contact Connells on

T 01249 652 476
E chippenham@connells.co.uk

59 Market Place
 CHIPPENHAM SN15 3HL

Property Ref: CHM306600 - 0002

Tenure:Freehold EPC Rating: C

Council Tax Band: C

view this property online
connells.co.uk/Property/CHM306600



1. MONEY LAUNDERING REGULATIONS Intending purchasers will be asked to produce identification documentation at a later stage and we would ask for your co-operation in order that there will be no delay in agreeing the sale. 2. These particulars do not constitute part or all of an offer or contract. 3. The measurements indicated are supplied for guidance only and as such must be considered incorrect. Potential buyers are advised to recheck measurements before committing to any expense. 4. We have not tested any apparatus, equipment, fixtures, fittings or services and it is in the buyers interest to check the working condition of any appliances.

Connells Residential is registered in England and Wales under company number 1489613, Registered Office is Cumbria House, 16-20 Hockliffe Street, Leighton Buzzard, Bedfordshire, LU7 1GN. VAT Registration Number is 500 2481 05.

see all our properties at www.connells.co.uk | www.rightmove.co.uk | www.zoopla.co.uk

for sale

£300,000



Wicks Drive CHIPPENHAM SN15 3FS

Well-presented three-bedroom end-terraced property offering a fantastic opportunity for families, first-time buyers, or investors alike. The property offers Lounge/Diner, Kitchen and Conservatory, Three Bedrooms, Family Bathroom and integral Garage.



Wicks Drive CHIPPENHAM SN15 3FS

Description

Situated in the desirable residential area of Pewsham, this well-presented three-bedroom end-terraced property offers a fantastic opportunity for families, first-time buyers, or investors alike.

The ground floor comprises an entrance porch leading through to a bright and spacious lounge/diner, perfect for relaxing or entertaining. To the rear, a modern fitted kitchen/dining area provides ample storage and workspace, with space for appliances and direct access to the garden, creating an ideal setting for everyday living.

There is also a well proportioned conservatory offering additional living/entertaining space.

Upstairs, the property features three well-proportioned bedrooms, including two generous doubles and a comfortable single, all

served by a contemporary family bathroom.

Externally, the home benefits from its end-terrace position, offering additional privacy and side access. The enclosed rear garden is low maintenance and ideal for outdoor dining, while the front provides off-road parking leading to an integral Garage.

Conveniently located close to local amenities, schools, and transport links, this property combines comfort, practicality, and accessibility.

Early viewing is highly recommended to fully appreciate what this home has to offer.



Ground Floor

Entrance Porch

Entrance door to front leading through to Lounge/Diner.

Lounge/Diner

Window to front. Stairs to First Floor. TV point. French doors to Conservatory.

Kitchen

Window and door to rear. Fitted with a matching range of base and wall units with complementary work surfaces over with inset sink and drainer. Plumbing for washing machine. Integrated oven and hob with cooker hood over.

Conservatory

French doors to rear.

First Floor

Landing

Stairs from Ground Floor. Doors to all rooms.

Bedroom One

Window to rear. Built in wardrobes.

Bedroom Two

Window to front.

Bedroom Three

Window to rear.

Bathroom

Suite comprising low level WC, vanity wash hand basin and panelled bath with mixer tap and shower attachment. Glass shower screen door. Window to front.

Outside

Front

Front garden laid to decorative stone. Driveway leading to Integral Garage.

Rear Garden

Fully enclosed. Lawn area, shrub borders and decorative circular patio.



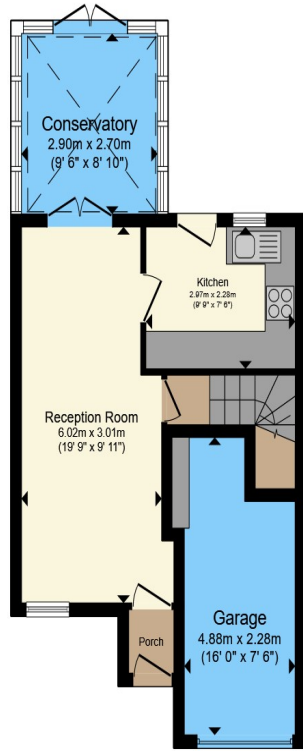

Ground Floor

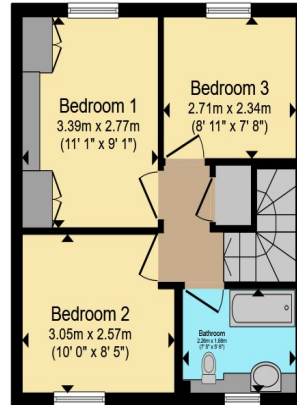

First Floor

Total floor area 79.9 m² (860 sq.ft.) approx

This floor plan is for illustrative purposes only. It is not drawn to scale. Any measurements, floor areas (including any total floor area), openings and orientation are approximate. No details are guaranteed, they cannot be relied upon for any purpose and they do not form part of any agreement. No liability is taken for any error, omission or misstatement. A party must rely upon its own inspection(s). Powered by www.propertybox.io



To view this property please contact Connells on

T 01249 652 476
E chippenham@connells.co.uk

59 Market Place
 CHIPPENHAM SN15 3HL

Property Ref: CHM306600 - 0002

Tenure:Freehold EPC Rating: C

Council Tax Band: C

view this property online
connells.co.uk/Property/CHM306600



1. MONEY LAUNDERING REGULATIONS Intending purchasers will be asked to produce identification documentation at a later stage and we would ask for your co-operation in order that there will be no delay in agreeing the sale. 2. These particulars do not constitute part or all of an offer or contract. 3. The measurements indicated are supplied for guidance only and as such must be considered incorrect. Potential buyers are advised to recheck measurements before committing to any expense. 4. We have not tested any apparatus, equipment, fixtures, fittings or services and it is in the buyers interest to check the working condition of any appliances.

Connells Residential is registered in England and Wales under company number 1489613, Registered Office is Cumbria House, 16-20 Hockliffe Street, Leighton Buzzard, Bedfordshire, LU7 1GN. VAT Registration Number is 500 2481 05.

see all our properties at www.connells.co.uk | www.rightmove.co.uk | www.zoopla.co.uk