



Prairie Street, SW8

£525,000

Dexters



Prairie Street, SW8

A spacious ground floor maisonette presented in excellent order throughout. Arranged to include an open plan reception/kitchen, two double bedrooms, private garden, family bathroom and a cellar for storage. The property benefits from its own front door and has a share of freehold.

Entering the flat, you step into a central hallway that leads directly into a bright and spacious open-plan reception room and kitchen, overlooking the garden with doors that open out to the patio area. Off the hallway, there is a modern bathroom and two bedrooms, one generous double at the front with a bay window, and a second bedroom beside it. A useful utility space sits just opposite the bathroom for convenient laundry and storage. Steps lead down to the basement, providing a sizeable additional storage area. Outside, the private garden offers a lovely area to relax or entertain, complete with a storage shed.

Prairie Street is located on a quiet residential road within the popular 'Diamond Conservation' area, the flat is within easy reach of the amenities of Queenstown Road and local transport links including the Northern Line extension. The iconic Battersea Power Station & Battersea Park are a short stroll away.

Features

- Two Double Bedrooms
- Own Front Door
- Private Garden
- Share Of The Freehold
- Modern Kitchen
- Superb Location







Prairie Street, London, SW8

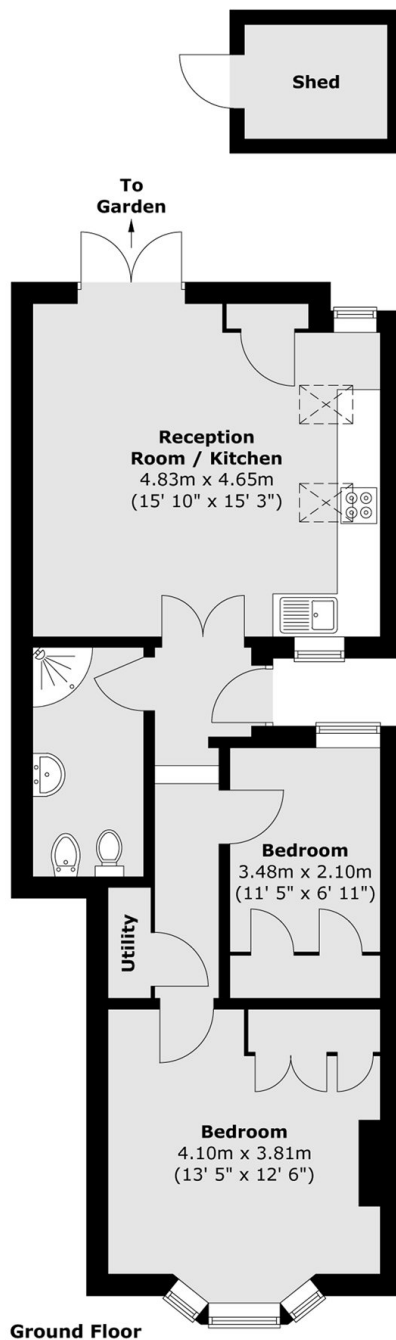

Total area (approx.) : 57.8 sq. m (622 sq. ft)