



OFFERS IN THE REGION OF

£245,000

Victoria Street

Sheffield, S36 6EL

## PROPERTY SUMMARY

Located in the heart of Penistone, this beautifully presented three-bedroom semi-detached home offers space, flexibility, and a lifestyle that's hard to beat. Having spacious accommodation with attractive enclosed rear garden and off road parking.

3



1



2









Approx Gross Internal Area  
95 sq m / 1021 sq ft

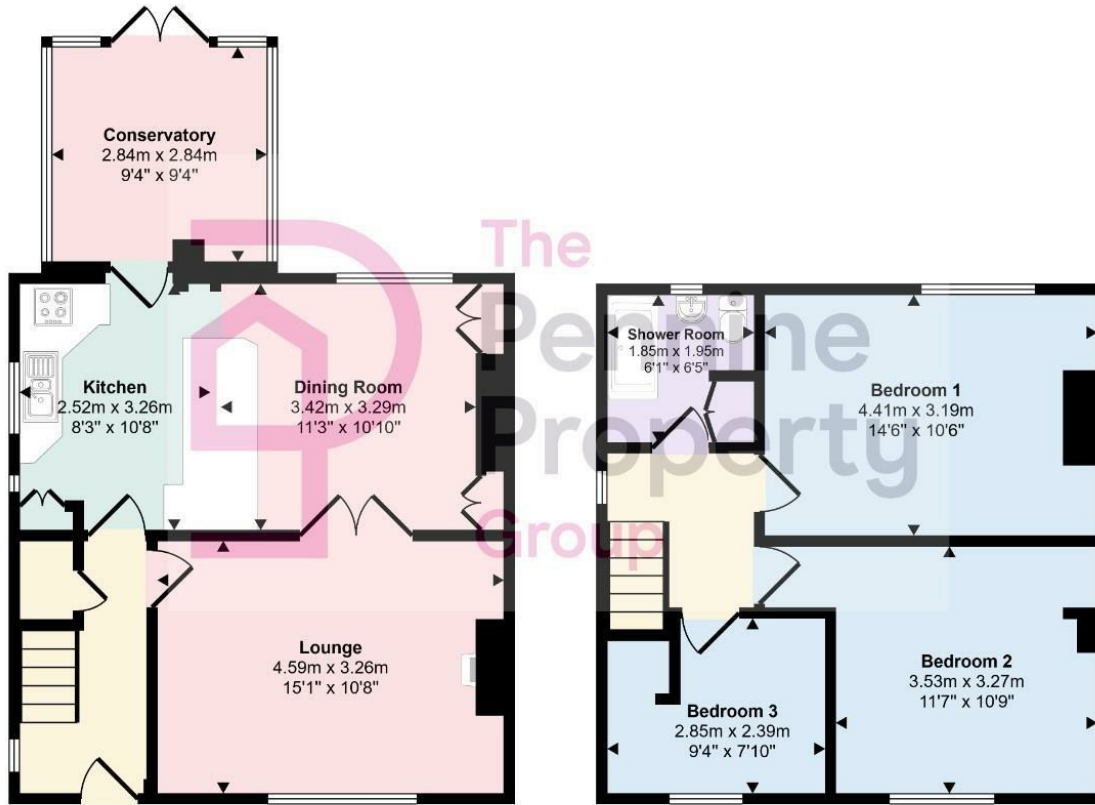

Ground Floor  
Approx 52 sq m / 561 sq ft

First Floor  
Approx 43 sq m / 460 sq ft

This floorplan is only for illustrative purposes and is not to scale. Measurements of rooms, doors, windows, and any items are approximate and no responsibility is taken for any error, omission or mis-statement. Icons of items such as bathroom suites are representations only and may not look like the real items. Made with Made Snappy 360.

**LOCAL AUTHORITY**  
BMBC

**TENURE**  
Freehold

**COUNCIL TAX BAND**  
B

**VIEWINGS**  
By prior appointment only

Energy Efficiency Rating		
	Current	Potential
Very energy efficient - lower running costs		
(92 plus) <b>A</b>		
(81-91) <b>B</b>		<b>83</b>
(69-80) <b>C</b>	<b>70</b>	
(55-68) <b>D</b>		
(39-54) <b>E</b>		
(21-38) <b>F</b>		
(1-20) <b>G</b>		
Not energy efficient - higher running costs		
<b>England &amp; Wales</b>	EU Directive 2002/91/EC	

Agents Note: Whilst every care has been taken to prepare these particulars, they are for guidance purposes only. All measurements are approximate and are for general guidance purposes only and whilst every care has been taken to ensure their accuracy, they should not be relied upon and potential buyers/tenants are advised to recheck the measurements

**OFFICE ADDRESS**

12 St Marys Street  
Penistone  
Sheffield  
South Yorkshire  
S36 6DT

**OFFICE DETAILS**

01226 766755  
info@pennineproperty.co.uk