



Price
£300,000

Leasehold

2x  1x  1x 

**Aysgarth Court, Sutton
Common Road, Sutton,
Surrey, SM1**

OVER 60?

Secure this property
for up to **59% less!**

cubitt & west
Helping you move forwards



Main features

- Just 200 meters from Sutton Common Station
- Beautifully presented throughout
- Bright and spacious living accommodation
- Off street unallocated parking
- Excellent location close to local amenities and transport links

Accommodation

FIRST FLOOR

Entrance Hall

Lounge/Dining Room: 14'1 x 12'8
(4.30m x 3.86m)

Kitchen: 11'0 x 7'9 (3.36m x 2.36m)

Bedroom 1: 15'4 x 11'9 (4.68m x 3.58m)

Bedroom 2: 13'6 x 7'8 (4.12m x 2.34m)

Bathroom

OUTSIDE

Communal Gardens

Off Road Parking

First Floor

Approx. 62.0 sq. metres (667.7 sq. feet)

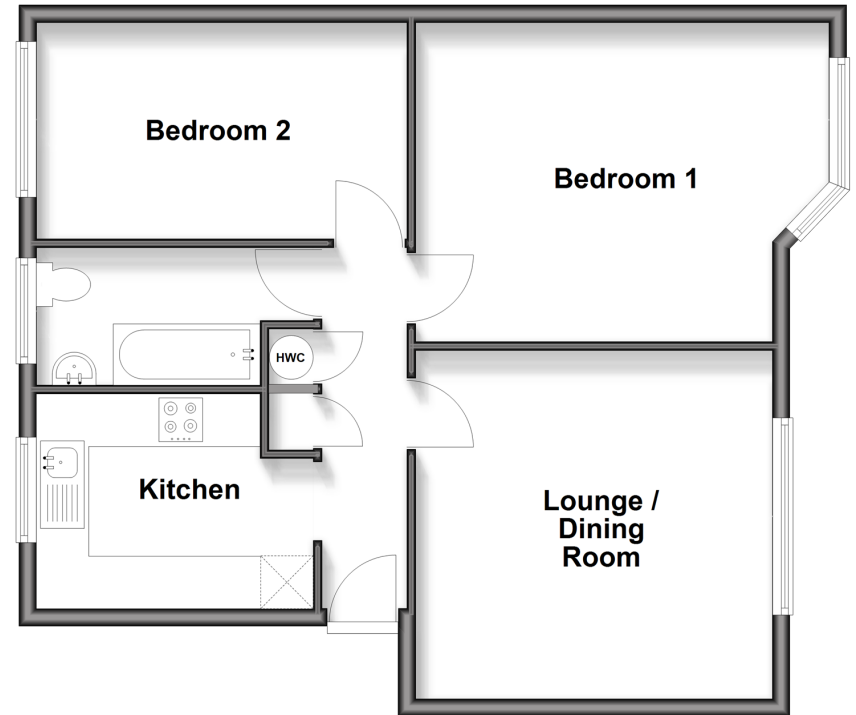

Call Sutton - 020 8661 0330 ■ cubittandwest.co.uk

■ Through a Homewise Home For Life Plan people aged 60+ can secure this property for up to 59% less, by purchasing a Lifetime Lease



22018476/20260430/CR/JF