



6 Courteenhall Drive  
Corby, Northamptonshire NN17 5FE



**Simpson West**



Simpson West Lettings are delighted to offer for rent this immaculately presented two bedroom mews style semi detached house which is situated within the highly prestigious Priors Hall Park area. This property has many features throughout and proudly boasts entrance hall, downstairs WC, kitchen and a lounge/diner with patio doors leading to the rear garden. Upstairs there is a master bedroom with a fitted wardrobe and an en suite shower room. There is a further second bedroom and a family bathroom. Outside there is fully enclosed rear garden and off road parking to the front. Energy Rating C. Council tax band B.

£950 PCM

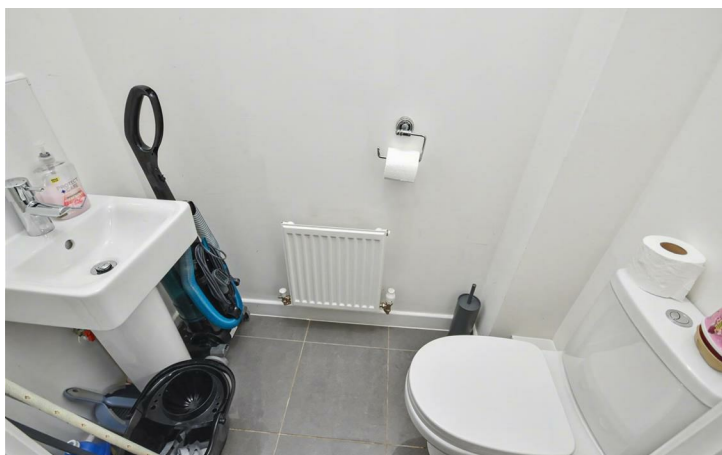

Ground Floor

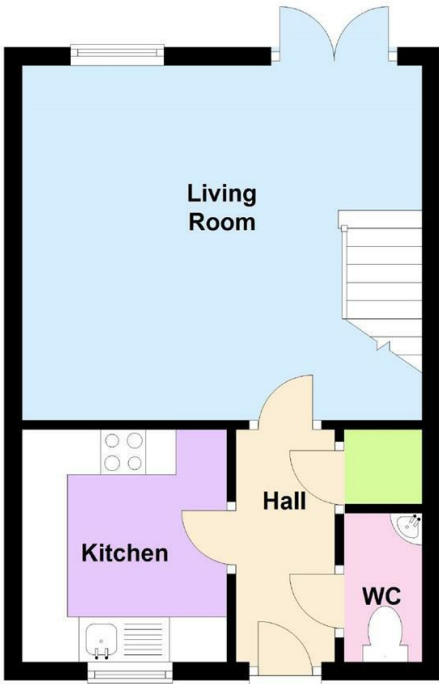

First Floor

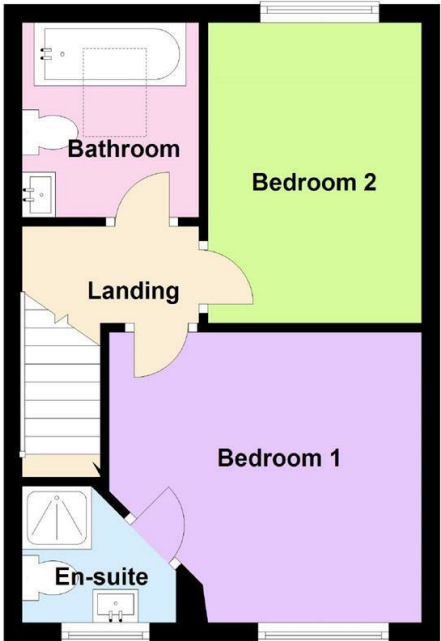

Floor plan not to scale - for guidance purposes only.  
Plan produced using PlanUp.

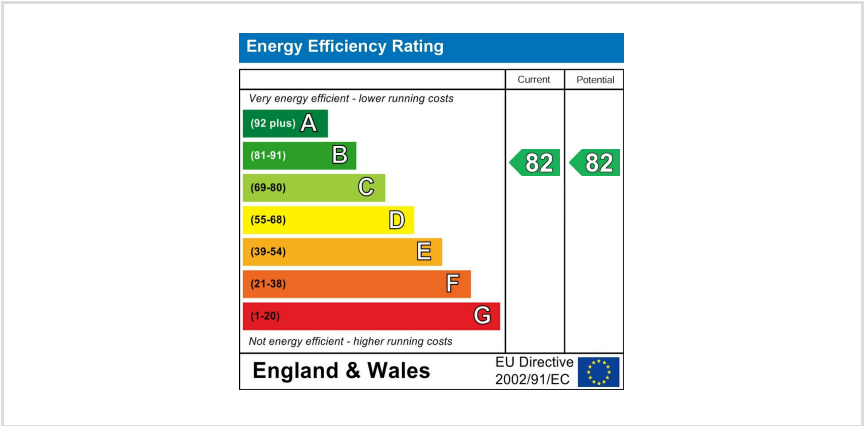

When you buy with Simpson West, you know **you'll be in safe hands**. From the moment you walk through our doors, we'll make you **feel truly welcome**. Our sales consultants and financial advisors will take you through **every step of the process**, offering **free expert advice** along the way, from help choosing the right mortgage and insurance through to finding your conveyancer. And if you need help selling your home too, **with over 20 years of local experience, you can trust us to get you moving**.



**Simpson  
West**

Making Every  
Journey Personal



01536 202007

[info@simpsonwest.co.uk](mailto:info@simpsonwest.co.uk)

<https://www.simpsonwest.co.uk/>

64 Corporation Street, Corby, Northants, NN17 1NH