



Connells

Mill Green Road
Amesbury Salisbury



Property Description

This two bedroom semi-detached house offers open plan accommodation and includes a stylish kitchen and private driveway. The property is offered for sale with no onward chain and is just minutes from Salisbury and the A303.

Entrance Porch

Lounge Area

Stairs to first floor, open plan to..

Kitchen/ Breakfast Area

Comprising a single drainer sink unit with a range of wall and base units with work surfaces over, breakfast bar, built in oven, inset hob unit with steel hood over, space for washing machine, built in dishwasher, fridge/freezer space, twin wine racks, downlighters, front aspect.

Landing

Built in cupboard.

Bedroom One

Front aspect.

Bedroom Two

Rear aspect.

Bathroom

Comprising a panel enclosed bath with pedestal wash hand basin and WC.

Outside

Rear Garden

Of a good size and with side access and a timber shed.

Driveway

To the side.







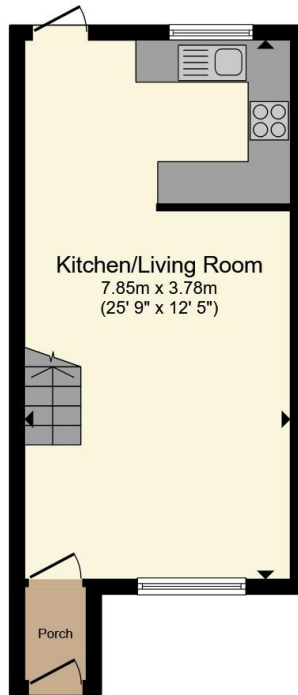

Ground Floor

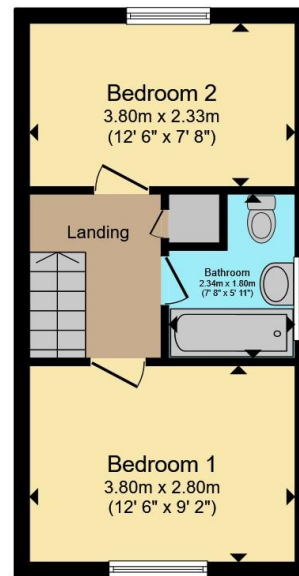

First Floor

Total floor area 59.2 m² (637 sq.ft.) approx

This floor plan is for illustrative purposes only. It is not drawn to scale. Any measurements, floor areas (including any total floor area), openings and orientation are approximate. No details are guaranteed, they cannot be relied upon for any purpose and they do not form part of any agreement. No liability is taken for any error, omission or misstatement. A party must rely upon its own inspection(s). Powered by www.propertybox.io



To view this property please contact Connells on

T 01980 622 662
E amesbury@connells.co.uk

Unit 3 23 Salisbury Street AMESBURY
 SALISBURY SP4 7AW

EPC Rating: D Council Tax
 Band: C

Tenure: Freehold

view this property online connells.co.uk/Property/ABY308641



1. MONEY LAUNDERING REGULATIONS Intending purchasers will be asked to produce identification documentation at a later stage and we would ask for your co-operation in order that there will be no delay in agreeing the sale. 2. These particulars do not constitute part or all of an offer or contract. 3. The measurements indicated are supplied for guidance only and as such must be considered incorrect. Potential buyers are advised to recheck measurements before committing to any expense. 4. We have not tested any apparatus, equipment, fixtures, fittings or services and it is in the buyers interest to check the working condition of any appliances.

Connells Residential is registered in England and Wales under company number 1489613, Registered Office is Cumbria House, 16-20 Hockliffe Street, Leighton Buzzard, Bedfordshire, LU7 1GN. VAT Registration Number is 500 2481 05.

See all our properties at www.connells.co.uk | www.rightmove.co.uk | www.zoopla.co.uk

Property Ref: ABY308641 - 0005