

Towers Wills

Town & Country

📞 01935 577 032 | 01460 298 530 | ✉ info@towerswills.co.uk



8, Court Ash House, Yeovil, Somerset BA20 1HG

£140,000

Towers Wills are delighted to bring to the market this spacious and well-presented two-bedroom first-floor apartment, situated within a purpose-built development conveniently located close to Yeovil town centre and its many amenities. NO ONWARD CHAIN.

Accommodation:

The property is presented in very good condition throughout and offers well-proportioned accommodation. The main living space comprises a bright and comfortable open-plan living/kitchen area, designed for modern living and fitted with a range of contemporary units together with integrated appliances.

There are two good-sized bedrooms, with both rooms benefitting from fitted wardrobes. The apartment is further served by a well-appointed main bathroom and additional storage facilities, adding to the practicality of the home.

Externally, the property benefits from an allocated parking space located to the rear of the building.

Situated within easy walking distance of Yeovil town centre, the property is ideally placed for local shops, restaurants and transport links. This apartment would make an excellent purchase for first-time buyers or investors alike, and early viewing is highly recommended.

Key Features

- First Floor Apartment
- Well Presented Throughout
- Two Bedrooms
- Allocated Parking
- NO ONWARD CHAIN

Contact Us

Towers Wills Estate Agents - Yeovil

114, Hendford Hill
Yeovil

Somerset
BA202RF

T: 01935 577032

E: info@towerswills.co.uk

Energy Efficiency

Score	Energy rating	Current	Potential
92+	A		
81-91	B		
69-80	C	70 c	78 c
55-68	D		
39-54	E		
21-38	F		
1-20	G		



Floor Plan

GROUND FLOOR

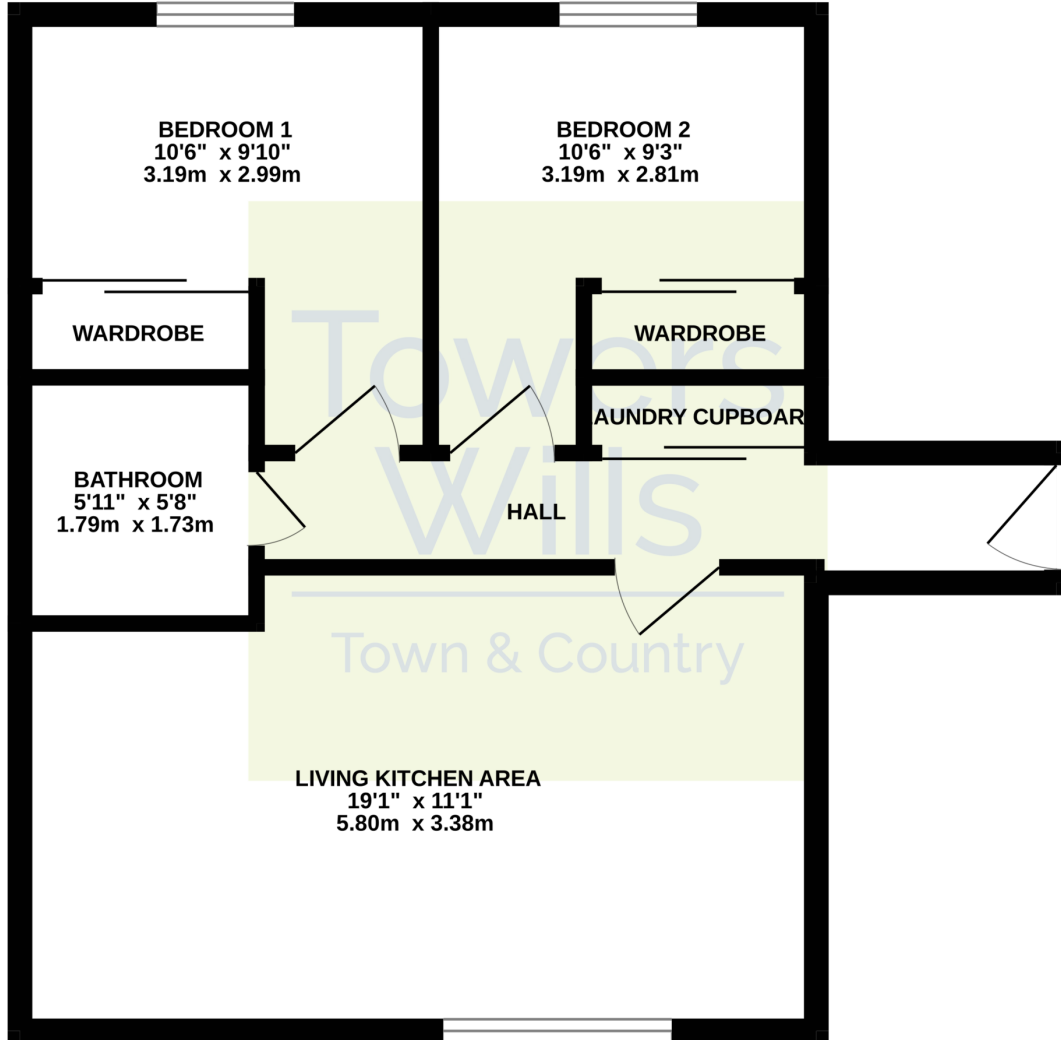

Please Note No tests have been undertaken of any of the services and any intending purchasers should satisfy themselves in this regard. Towers Wills Ltd for themselves and for the vendor of this property whose agents they are, give notice that, (i) these particulars do not constitute any part of an offer or contract, (ii) all statements contained within these particulars are made without responsibility on the part of Towers Wills or the vendor, (iii) whilst made in good faith, none of the statements contained within these particulars are to be relied upon as a statement of representation or fact, (iv) any intending purchaser must satisfy him/herself by inspection or otherwise as to the correctness of each of the statements contained within these particulars, (v) the vendor does not make or give either Towers Wills or any person in their employment any authority to make or give representation or warranty whatsoever in relation to this property.

Photographs / Floor Plans Photographs are reproduced for general information and it must not be inferred that any item is included for sale with this property. Please note floor plans are not to scale and are for identification purposes only. The photographs used in these particulars may have been taken with the use of a wide angle lens. If you have any queries as to the size of the accommodation or plot, please address these with the agent prior to making an appointment to view

Towers Wills

The White House, 114 Hendford Hill, Yeovil BA20 2RF

Yeovil 01935 577032 / South Petherton 01460 298530

info@towerswills.co.uk | www.towerswills.co.uk