



Henbury - £239,950

2 bed coach house

32 Norton Farm Road, BS10 7ER



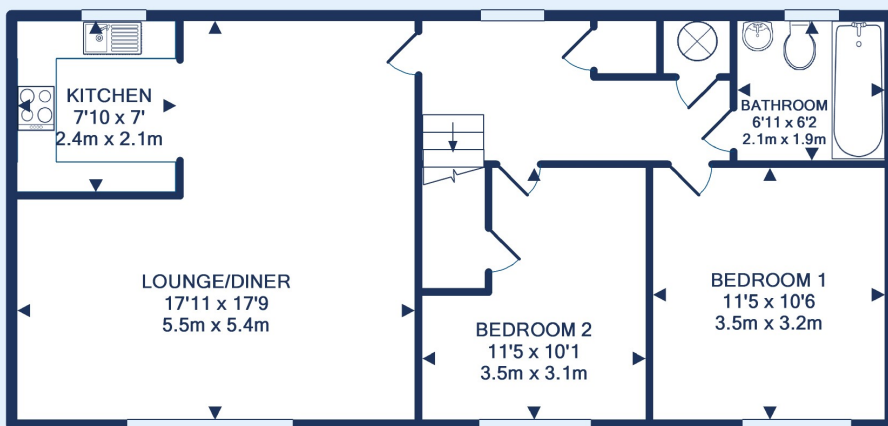
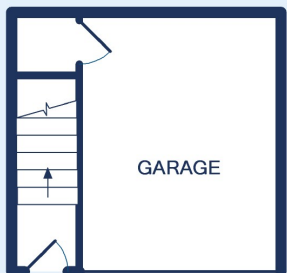

Made with Metropix ©2021



Beautifully presented and spacious two double bedroom detached coach house tucked away off Norton Farm Road.

This lovely home is accessed via its own private entrance with stairs rising to a hallway with storage cupboards and doors leading to the bedrooms, modern fitted bathroom with a shower over the bath and the spacious 17'9 x 17'11 lounge/diner which opens into a modern fitted kitchen with integrated oven, hob, washing machine and fridge freezer.

This fantastic home has gas central heating powered by a new combination boiler, double glazing, visitors parking and a garage with additional storage area.



Westbury on Trym Office

73 Westbury Hill, Westbury-on-Trym,
Bristol, BS9 3AD

Call: 0117 9621973

Mail: westburysales@oceanhome.co.uk

Search: oceanhome.co.uk

References to the Tenure of a Property are based on information supplied by the Seller. The Agent has not had sight of the title documents. Lease details, service ground rent (where applicable) are given as a guide only and should be checked and confirmed by your solicitor prior to exchange of contracts.