

Denecroft Crescent

Hillingdon • Middlesex • UB10 9HY
Offers In Excess Of: £525,000



coopers
est 1986

Denecroft Crescent

Hillingdon • Middlesex • UB10 9HY

A three bedroom mid terraced house that is situated on a popular residential road on the Oak Farm that has been modernised throughout while still offering potential to extend (S.T.P). The property offers easy access to a variety of amenities including shops, numerous sought after schools, parks, bus/road links and Hillingdon tube station. The ground floor of the property benefits from a spacious and bright hallway with a door leading into the 13ft living room which is open plan to the modern 17ft kitchen/diner with double doors leading onto the garden. To the first floor there is an 11ft main bedroom with fitted wardrobes, 11ft second bedroom, 8ft third bedroom and modern family bathroom. Outside the front garden has been block paved creating off street parking. To the rear is a beautiful, landscaped, east facing garden that offers a large decked area across the rear of the house that leads onto the well manicured lawn. The borders are well stocked with a variety of evergreen shrubs and trees with a pathway leading to a rear patio and access to the 14ft garden room, 8ft store and W.C.

Three bedroom house

Mid terraced

Oak Farm

Potential to extend (S.T.P)

Modernised throughout

Open plan living room

17ft kitchen/diner

Off street parking

Landscaped rear garden

14ft games / garden room

These particulars are intended as a guide and must not be relied upon as statements of fact. Your attention is drawn to the Important Notice on the last page.





Ground Floor

Approx. 39.2 sq. metres (422.2 sq. feet)
(excluding Garden Room, Store Room)

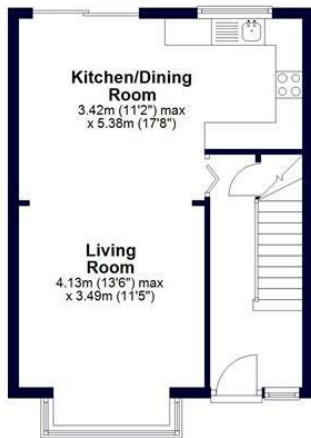
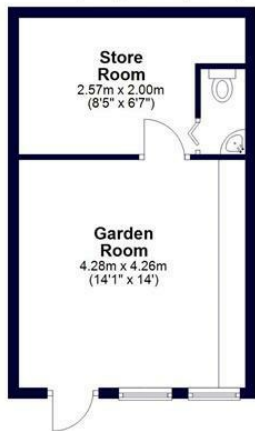

First Floor

Approx. 37.7 sq. metres (406.3 sq. feet)



Total area: approx. 77.0 sq. metres (828.5 sq. feet)



Whilst every effort has been made to ensure the accuracy of this floor plan, measurements of doors, windows, rooms and other items are approximate and no responsibility is taken for any errors. This plan is for illustrative purposes only and should be used as such by any prospective purchaser.
©Property Pot. Produced on behalf of Coopers Residential.



**109 Hillingdon Hill, Hillingdon Village,
Middlesex, UB10 0JQ**
hillingdon@coopersresidential.co.uk

CoopersResidential.co.uk

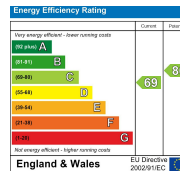

Important Notice: These particulars, whilst believed to be accurate are set out as a general outline only for guidance and do not constitute any part of an offer or contract. Intending purchasers should not rely on them as statements or representation of fact, but must satisfy themselves by inspection or otherwise has the authority to make or give any representation or warranty in respect of the property.