



**Connells**

Bucklers Mead Road  
Yeovil



## Property Description

Located in a residential area of Yeovil, this well-proportioned three bedroom home offers comfortable and practical accommodation suited to a range of buyers. The property comprises an entrance hall with side access, a front-facing lounge with a night storage heater, and a functional kitchen fitted with wall and base units, designated appliance spaces and a door opening directly onto the rear garden. Upstairs, there are two bedrooms, both benefiting from double-glazed windows, along with useful built-in and over-stairs storage and access to the loft. The home is equipped with night storage heating and double glazing throughout.

Externally, the property enjoys a fully enclosed rear garden featuring a patio, pathway and lawn, complemented by established trees and shrubs. Parking is provided by a driveway suitable for two vehicles, in addition to a garage with an up-and-over door, rear workshop area and rear access door, offering both storage and versatility.

Yeovil is a well-served market town offering a wide range of local amenities including shops, supermarkets, schools and leisure facilities. The town benefits from good transport links, with Yeovil Junction and Yeovil Pen Mill providing rail connections, and convenient road access to the A30 and A303 for travel towards the South West and beyond. Surrounded by attractive countryside, Yeovil offers a balance of town living with easy access to rural walks and nearby villages.

## Entrance Hall

A well-proportioned entrance hall featuring a side access door and fitted with a night storage heater.

## Lounge

A comfortable lounge with a double-glazed window to the front aspect and fitted with a night storage heater.

## Kitchen

A practical kitchen with a double-glazed window to the rear aspect, a door providing access to the garden, a range of wall and base units with worktops over, designated spaces for a washing machine, electric oven, dishwasher and freestanding fridge freezer, and an extractor fan.

## Shower Room

Fitted with a double-glazed window to the rear, low-level WC, wash hand basin, and enclosed shower. Additional features include an extractor fan and electric heater.

## Landing

A first-floor landing providing access to the loft space.

## Bedroom One

A bright bedroom with a double-glazed window to the front aspect and a built-in mirrored wardrobe.

## Bedroom Two

A bedroom with a double-glazed window to the rear aspect, an over-stairs storage cupboard and fitted with a night storage heater.

## Bedroom Three

A bedroom with a double-glazed window to the rear aspect and fitted cupboards housing the immersion heater.

## Outside

### Rear Garden

A rear garden featuring a patio area, pathway and lawn, fully enclosed by fencing and complemented by a selection of mature trees and shrubs.

### Parking

A driveway providing parking for two vehicles, along with a garage featuring an up-and-over door, a workshop area to the rear and a rear access door.

### Agents Note

Move with Us, as the appointed selling agent, is required to conduct ID/AML and source of funds checks for the properties we sell. To date, we have absorbed the associated administrative and third party costs, however, from 1st January 2026, we will be introducing a charge to purchasers of £49 (plus VAT) a total cost of £58.80 to cover the increasing costs of this customer due diligence, as is increasingly standard industry practice.

Please advise all parties making an offer that, should their offer be accepted, this non-refundable charge will be payable and taken by phone as part of our purchaser compliance call before a memorandum of sale can be issued







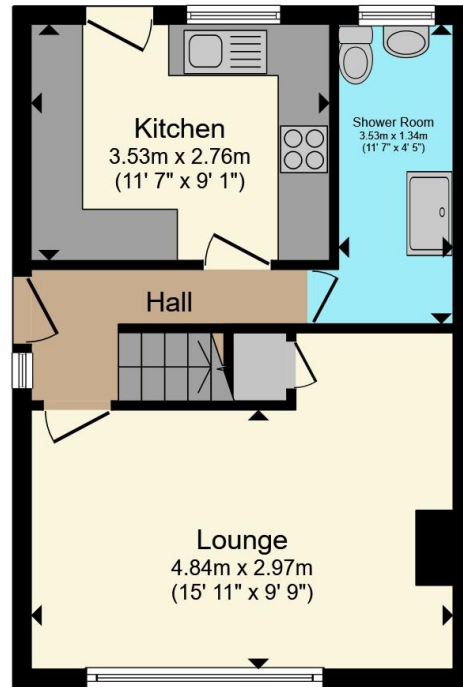

**Ground Floor**

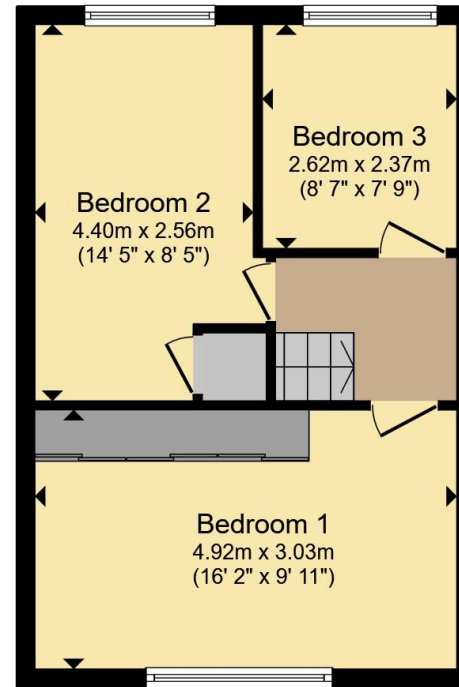

**First Floor**

Total floor area 74.1 m<sup>2</sup> (797 sq.ft.) approx

This floor plan is for illustrative purposes only. It is not drawn to scale. Any measurements, floor areas (including any total floor area), openings and orientation are approximate. No details are guaranteed, they cannot be relied upon for any purpose and they do not form part of any agreement. No liability is taken for any error, omission or misstatement. A party must rely upon its own inspection(s). Powered by [www.propertybox.io](http://www.propertybox.io)



To view this property please contact Connells on

**T 01935 431 129**  
**E [yeovil@connells.co.uk](mailto:yeovil@connells.co.uk)**

1-3 Princes Street  
YEOVIL BA20 1EW

EPC Rating: Council Tax  
Awaited Band: C

Tenure: Freehold

**view this property online [connells.co.uk/Property/YOV314221](http://connells.co.uk/Property/YOV314221)**



1. MONEY LAUNDERING REGULATIONS Intending purchasers will be asked to produce identification documentation at a later stage and we would ask for your co-operation in order that there will be no delay in agreeing the sale. 2. These particulars do not constitute part or all of an offer or contract. 3. The measurements indicated are supplied for guidance only and as such must be considered incorrect. Potential buyers are advised to recheck measurements before committing to any expense. 4. We have not tested any apparatus, equipment, fixtures, fittings or services and it is in the buyers interest to check the working condition of any appliances.

Connells Residential is registered in England and Wales under company number 1489613, Registered Office is Cumbria House, 16-20 Hockliffe Street, Leighton Buzzard, Bedfordshire, LU7 1GN. VAT Registration Number is 500 2481 05.

**See all our properties at [www.connells.co.uk](http://www.connells.co.uk) | [www.rightmove.co.uk](http://www.rightmove.co.uk) | [www.zoopla.co.uk](http://www.zoopla.co.uk)**

Property Ref: YOY314221 - 0004