

the floorplan...

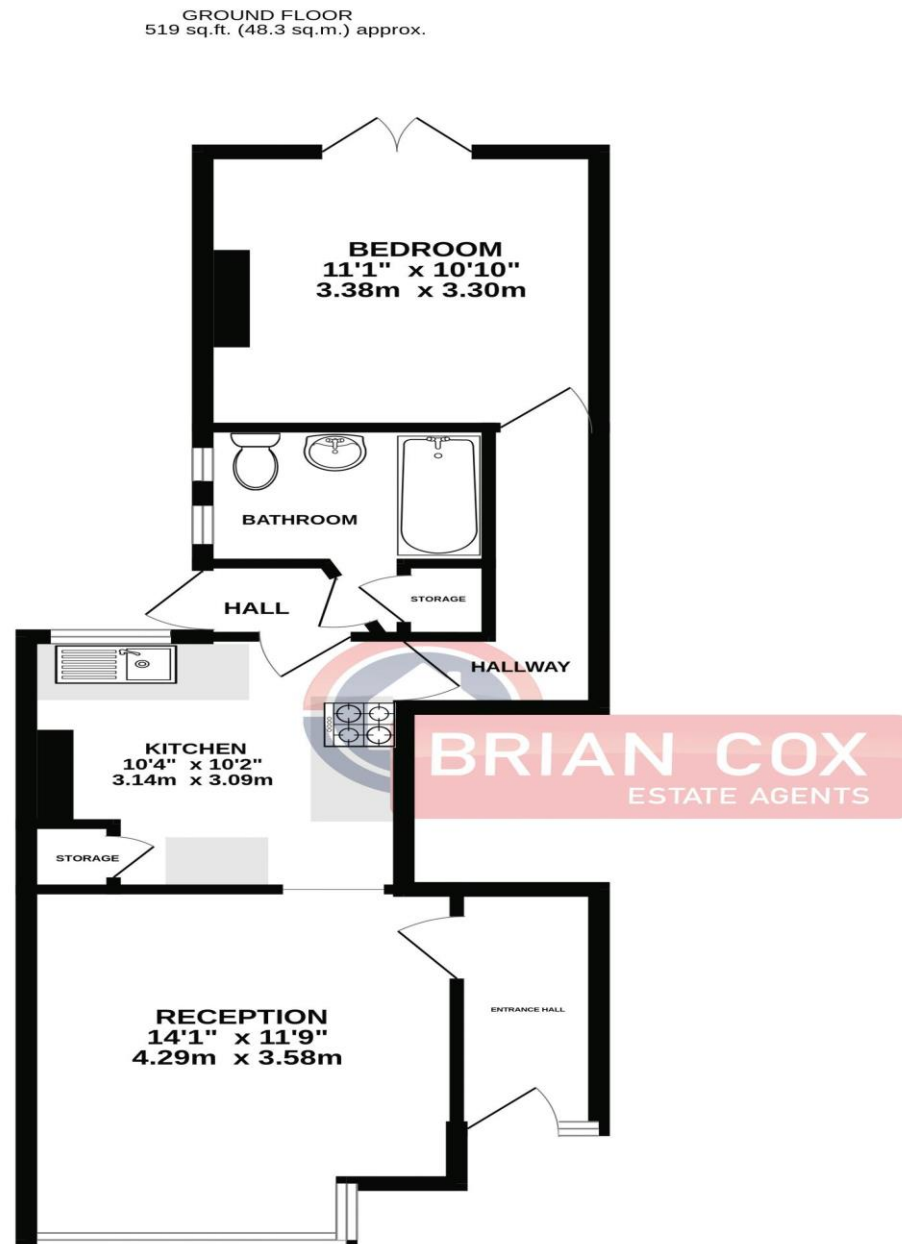

TOTAL FLOOR AREA : 519 sq.ft. (48.3 sq.m.) approx.  
Whilst every attempt has been made to ensure the accuracy of the floorplan contained here, measurements of doors, windows, rooms and any other items are approximate and no responsibility is taken for any error, omission or mis-statement. This plan is for illustrative purposes only and should be used as such by any prospective purchaser. The services, systems and appliances shown have not been tested and no guarantee as to their operability or efficiency can be given.  
Made with Metropix ©2025

more details from...

call: **Brian Cox Greenford: 0208 912 0006**

email: [info@brian-cox.co.uk](mailto:info@brian-cox.co.uk)

web: [www.brian-cox.co.uk](http://www.brian-cox.co.uk)



Consumer Protection from Unfair Trading Regulations 2008 We have not tested any apparatus, equipment, fixtures, fittings or services and so cannot verify that they are in working order or fit for purpose. You are advised to obtain verification from your solicitor or surveyor. References to the tenure of a property are based on information supplied by the seller. We have not had sight of the title documents and a buyer is advised to obtain verification from their solicitor. Items shown in photographs are not included unless specifically mentioned within the sales particulars, but may be available by separate negotiation. We advise you to book an appointment to view before embarking on any journey to see a property, and check its availability.



0208 912 0006  
[brian-cox.co.uk](http://brian-cox.co.uk)



ONE BEDROOM - GROUND FLOOR - PRIVATE REAR GARDEN - OFF STREET PARKING - CHAIN FREE. Brian Cox and Company are delighted to offer to the market this one-bedroom ground floor maisonette located within easy reach of both Harrow Town Centre and Harrow on The Hill Bus and Train Station. This conveniently situated flat benefits from its own private garden, no onward chain and being share of freehold with a new long lease. Viewings are recommended so call now to arrange yours!!



£275,000  
Share of Freehold

Wellesley Road, Harrow HA1 1QN



### in brief...

- One Bedroom
- Ground Floor Maisonette
- Share of Freehold
- Private Rear Garden
- Chain Free
- Convenient Location



### the location...

#### nearest stations ...

- Harrow-on-the-Hill (0.3 miles)
- Harrow & Wealdstone (0.6 miles)
- West Harrow (0.8 miles)

Harrow is a large suburban town in the London Borough of Harrow, North West London, England. It is centred 10.5 miles (16.9 km) North West of Charing Cross.

Harrow has two large shopping centres which are St Anns and St Georges with its many large department stores, restaurants, cafes and cinema.

There are many local schools in the area some of these include Norbury School, Marlborough Primary School, St Anselm's Catholic Primary School, Harrow High School and Whitefriars School.

