

# STAPLETON LONG

Estate Agents & Chartered Surveyors

EST 1907



**Montague Road, London, SW19 1TB**

**Two Bedroom Conversion Flat**

**No Onward Chain**

**Share of Freehold**

**£435,000 Leasehold - Share of Freehold**

**TO VIEW THIS PROPERTY CALL: 020 8670 9111**

Email: [norwood.sales@stapletonlong.co.uk](mailto:norwood.sales@stapletonlong.co.uk)

[www.stapletonlong.co.uk](http://www.stapletonlong.co.uk)

This fantastic spit level apartment located in prime location for various local amenities, the property comprises of entrance hall, 20' lounge, fitted kitchen, four piece bathroom, and two bedrooms. Offered chain free and available to view now!

EPC: C

Council Tax Band: C

### Montague Avenue

Approximate Gross Internal Area = 71.8 sq m / 773 sq ft  
(Excluding Eaves)

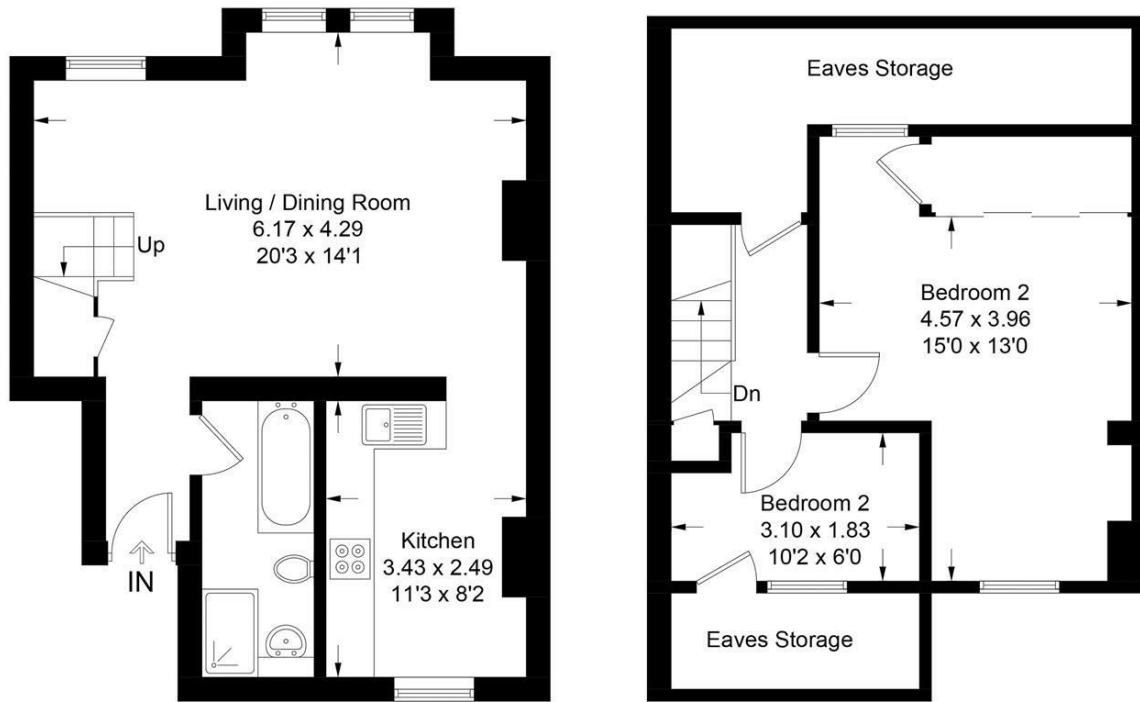
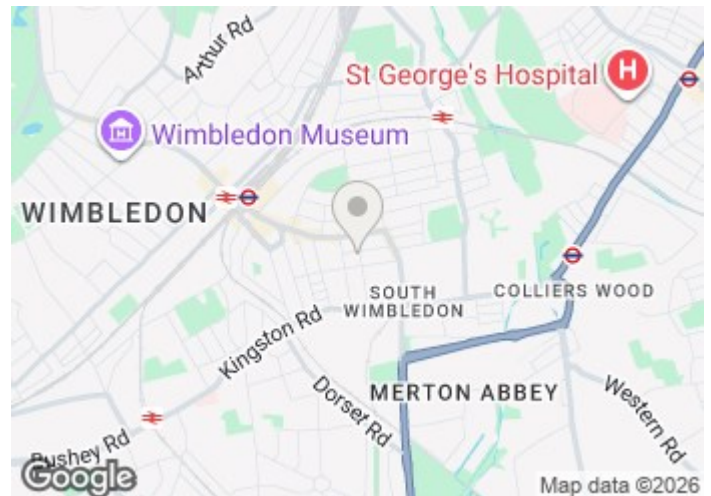

Illustration for identification purposes only, measurements are approximate, not to scale. Fourlabs.co © (ID1186460)

Energy Efficiency Rating		Current	Potential
<i>Very energy efficient - lower running costs</i>			
(92 plus) <b>A</b>			
(81-91) <b>B</b>			
(69-80) <b>C</b>			
(55-68) <b>D</b>			
(39-54) <b>E</b>			
(21-38) <b>F</b>			
(1-20) <b>G</b>			
<i>Not energy efficient - higher running costs</i>			
<b>England &amp; Wales</b>	EU Directive 2002/91/EC	69	76

Environmental Impact (CO <sub>2</sub> ) Rating		Current	Potential
<i>Very environmentally friendly - lower CO<sub>2</sub> emissions</i>			
(92 plus) <b>A</b>			
(81-91) <b>B</b>			
(69-80) <b>C</b>			
(55-68) <b>D</b>			
(39-54) <b>E</b>			
(21-38) <b>F</b>			
(1-20) <b>G</b>			
<i>Not environmentally friendly - higher CO<sub>2</sub> emissions</i>			
<b>England &amp; Wales</b>	EU Directive 2002/91/EC		



Please Note: All dimensions are approximate and are quoted for guidance only. Reference to appliances and/or services does not imply that they are necessarily in working order or fit for the purpose. We have been advised by the vendor of the freehold/leasehold status of the property and you should have this, together with any other information provided concerning the tenure of the property, checked by your solicitor. The position regarding fixtures and fittings and, where the property has been extended/converted, the position regarding planning approval and building regulation compliance, should also be checked by your solicitor. These particulars do not constitute or form part of an offer or contract nor may they be regarded as representations. All interest parties must themselves verify their accuracy.