



5A Castlegate

Tickhill, Doncaster, DN11 9QP

£180,000

Nestled in the charming area of Castlegate, Tickhill, Doncaster, this exquisite flat offers a perfect blend of modern living and classic elegance. With two spacious double bedrooms, this property is beautifully presented throughout, making it an ideal home for individuals or small families seeking comfort and style. Totally renovated in the last 3 years.

Upon entering, you are greeted by a welcoming reception room that flows seamlessly into a bespoke German kitchen. This culinary haven is equipped with an array of high-end appliances, including a steam/air fry/microwave combination that boasts self-cleaning capabilities, an induction hob, and a convection oven. The integral fridge/freezer and waste disposal unit add to the convenience, while the under-sink control for water in the courtyard enhances functionality.

The family bathroom is a true sanctuary, featuring luxurious marble flooring and underfloor heating for added comfort. The five-piece suite, complete with a bidet and a stunning waterfall bath, is complemented by a lighted vanity mirror, creating a serene space for relaxation.

Throughout the flat, real wood flooring adds warmth and character, while the heat pump air conditioning and heating system, which compliments the gas hot water heating system and ensures a pleasant atmosphere year-round. The property also includes a garage with a mezzanine level, equipped with electrics for electric vehicle charging, providing practicality for modern living.

- In the heart of Tickhill
- Beautifully presented apartment
- Two double bedrooms
- Fitted kitchen with lots of modern features
- Four piece bathroom suite
- Shared enclosed courtyard
- Garage
- Viewing Essential

Viewing

Please contact our Office on 01302 751616 if you wish to arrange a viewing appointment for this property or require further information.



Floor Plan

68 sq m/731.94 sq ft
Approx.

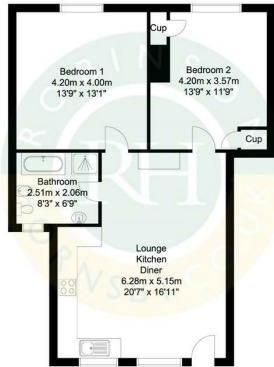

Whilst every attempt has been made to ensure the accuracy of the floor plan contained here, no responsibility is taken for incorrect measurements of doors, windows, appliances and rooms or any error, omission or misstatement. Exterior and interior walls are drawn to scale based on interior measurements. Any figure given is for initial guidance only and should not be relied on as a basis of valuation. The plans are for marketing purposes only and should only be used as such. No guarantee is given on the accuracy of the total square footage/metreage if quoted on this plan. CP Property Services @2026

Area Map



Energy Efficiency Graph

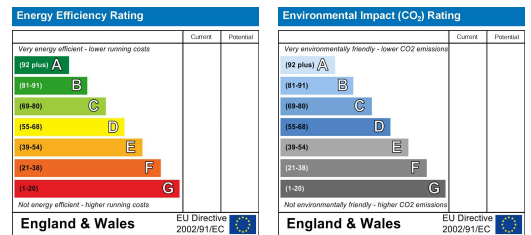

These particulars, whilst believed to be accurate are set out as a general outline only for guidance and do not constitute any part of an offer or contract. Intending purchasers should not rely on them as statements of representation of fact, but must satisfy themselves by inspection or otherwise as to their accuracy. No person in this firm's employment has the authority to make or give any representation or warranty in respect of the property.