

Need a Mortgage in principle
to make offers? Call us now
for quick assistance!
0121 775 0101



Do you need to sell?
Start your journey now!
Call us we can help.
01564 777 314



SCAN FOR MORE INFO
SIZE - 701 Sq Ft
TENURE - Freehold
COUNCIL TAX - Solihull Metropolitan Borough Council - C
BROADBAND - Upload Max 1000Mbps Download Max 1800Mbps
MOBILE - EE - 82%, O2 - 74%, 3 - 76%, Vodafone - 78%
EPC - D - 68
PARKING - Driveway
FLOODRISK - Very Low
SERVICES - Mains
COVENANTS - N/A

5 Copt Heath Croft
Knowle, B93 9LT
Guide Price £335,000

This three-bedroom mid-terrace house, located in a sought-after cul-de-sac, offers a fantastic opportunity to make it your own. Just a short walk from Knowle High Street and excellent schools, with driveway parking and a low-maintenance garden. No chain!

FEATURES

- Three Bedroom Mid Terraced House
- Driveway Parking for Two Vehicles
- Downstairs Cloakroom with Storage
- Low Maintenance Garden
- Sought After Location with Good Schools
- Walking Distance to Knowle High Street
- Close to Public Transport Links
- No Upward Chain

Are you an investor
interested in expanding your
portfolio?

**Call 01564 777 314 to provide your
investment criteria for alerts.**



SCAN TO **VIEW OUR**
WEEKLY FILMS &
SUBSCRIBE



Sneak Peeks

Every week, we unveil "Sneak Peeks," a feature showcasing exclusive properties before they hit Rightmove and other platforms.



The Landlord Club

Join our Landlord Club for weekly updates on legislation, market trends, and our Letting Director's 'Investment Pick of the Week' for optimal ROI.



HTSPMD

Tune into 'How's The Solihull Property Market Dom' weekly for a quick, insightful snapshot of the market.



The Mortgage Update

Get weekly insights and the best deals with our Mortgage Update, your shortcut to navigating the complex mortgage landscape confidently.

Ground Floor

Approx. 30.6 sq. metres (329.4 sq. feet)

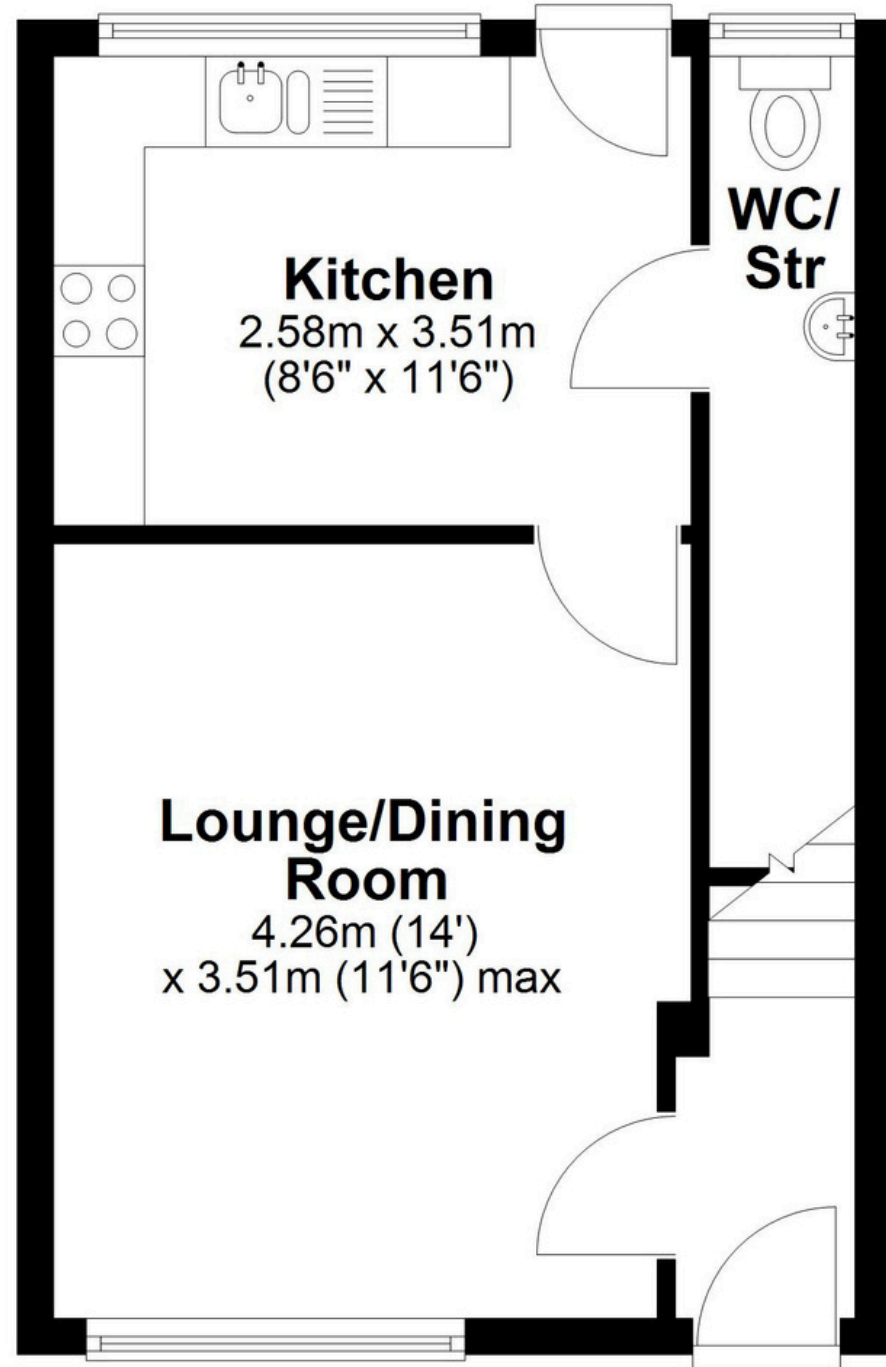

First Floor

Approx. 34.6 sq. metres (372.0 sq. feet)

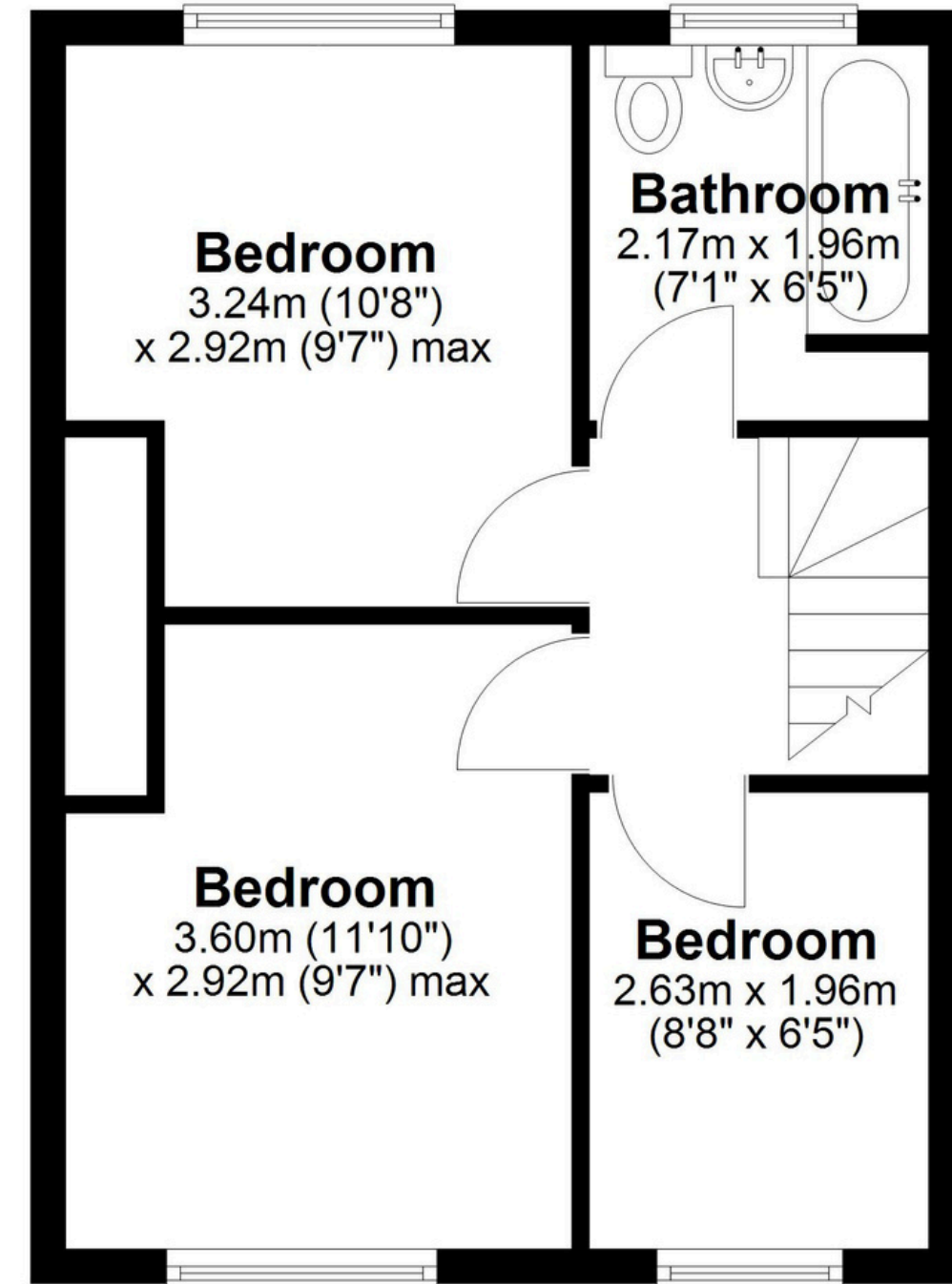

Total area: approx. 65.2 sq. metres (701.4 sq. feet)

This floor plan is for illustration purposes only, this is not intended to be a measured/scaled survey or comply with RICS guidelines. All measurements (including total floor area) openings, orientation and floor area are approximate. No details are guaranteed, they cannot be relied upon for any purpose and do not form part of any agreement. A party must rely upon its own inspection(s). No responsibility is taken for any error, omission, or mis-statement.

Plan produced using PlanUp.