



Weaver Close, Ipswich, IP1 5RB

welcome to

Weaver Close, Ipswich

This beautifully presented, three bedroom, semi-detached home has undergone a full refurbishment and boasts a cosy lounge, a stylish kitchen/diner, a ground floor cloakroom, a 1st floor bathroom, a landscaped rear garden and ample on street and residents parking.

Entrance Porch

Sliding door to entry, a fitted mat and a door to the hall.

Entrance Hall

Wood effect flooring, one radiator, a storage cupboard and an understairs storage cupboard.

Cloakroom

Low level WC, vanity sink, double glazed window to the front, spotlights and fully tiled walls and flooring.

Lounge

Cosy lounge with double glazed window to the front, wood effect flooring, one radiator, spotlights, TV point and USB sockets.

Kitchen/Diner

Stunning, open plan room which has been refurbished to a very high standard, with white marble effect tiled flooring throughout, under floor heating, patio doors to the garden, double glazed windows to the rear, a white vertical wall hung radiator, spotlights, eye and base handle less units in high gloss white black stone effect worktop surfaces, a stainless steel sink plus drainer and chrome mixer tap, an integrated oven with gas hob and extractor hood, an integrated microwave, washing machine and dishwasher, space for a fridge/freezer and ample space for a table and chairs.

First Floor Landing

Carpet flooring, an airing cupboard and loft hatch.

Master Bedroom

Double glazed window to the front, carpet flooring, one radiator and a triple fitted, sliding wardrobe.

Bedroom Two

Double glazed window to the rear, carpet flooring, one radiator and a fitted sliding wardrobe.

Bedroom Three

Double glazed window to the front, carpet flooring and one radiator.

Bathroom

Stunning bathroom with white marble effect tiled flooring and walls, an enclosed WC with matching vanity sink, a triple shower with glass enclosure, waterfall showerhead and shower attachment, chrome heated towel rail, extractor fan, spotlights and double glazed window to the rear.

Outside:

Front Garden

A partially walled border and a paved area leading to the front door.

Rear Garden

A large patio seating area, a shed, raised sleeper borders, a grassed area, fully enclosed border, a rear gate for access and an outside tap and light.

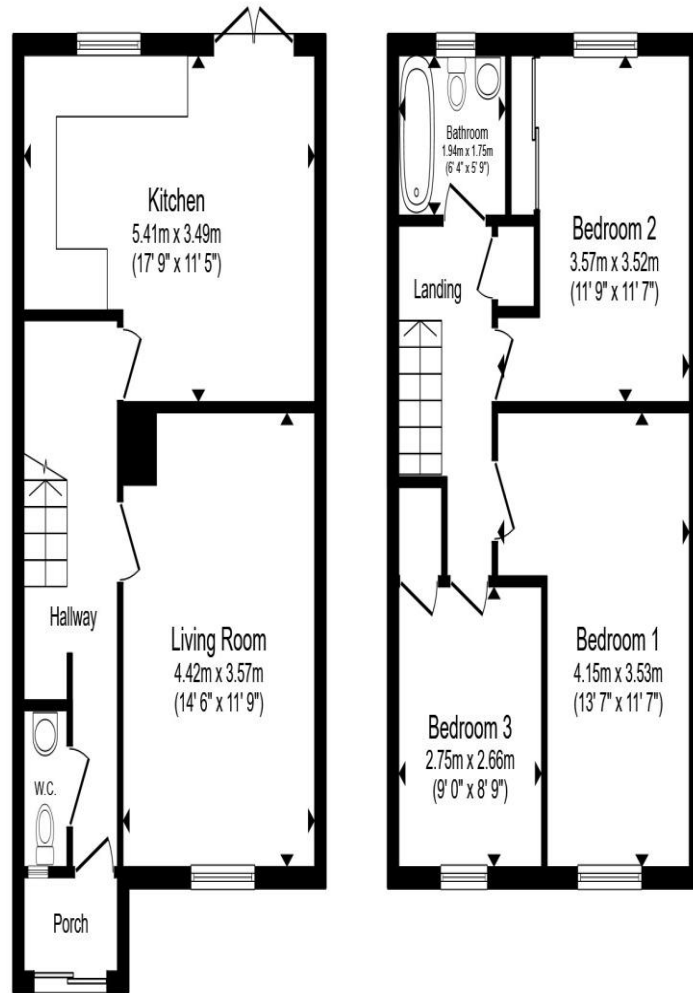

Ground Floor

First Floor

Total floor area 87.8 m² (945 sq.ft.) approx

This floor plan is for illustrative purposes only. It is not drawn to scale. Any measurements, floor areas (including any total floor area), openings and orientation are approximate. No details are guaranteed, they cannot be relied upon for any purpose and they do not form part of any agreement. No liability is taken for any error, omission or misstatement. A party must rely upon its own inspection(s). Powered by www.propertybox.io



welcome to
Weaver Close,
Ipswich

- Refurbished throughout to a high standard
- Three bedrooms
- Stylish kitchen/diner with under floor heating
- Ground floor cloakroom & 1st floor bathroom
- Landscaped rear garden

Tenure: Freehold EPC Rating: Awaited
Council Tax Band: B

£250,000



view this property online williamhbrown.co.uk/Property/IPS119822



Property Ref:
IPS119822 - 0002

1. MONEY LAUNDERING REGULATIONS Intending purchasers will be asked to produce identification documentation at a later stage and we would ask for your co-operation in order that there is no delay in agreeing the sale. 2. These particulars do not constitute part or all of an offer or contract. 3. The measurements indicated are supplied for guidance only and as such must be considered incorrect. Potential buyers are advised to recheck measurements before committing to any expense. 4. We have not tested any apparatus, equipment, fixtures or services and it is in the buyers interest to check the working condition of any appliances. 5. Where an EPC, or a Home Report (Scotland only) is held for this property, it is available for inspection at the branch by appointment. If you require a printed version of a Home Report, you will need to pay a reasonable production charge reflecting printing and other costs. 6. We are not able to offer an opinion either written or verbal on the content of these reports and this must be obtained from your legal representative. 7. Whilst we take care in preparing these reports, a buyer should ensure that his/her legal representative confirms as soon as possible all matters relating to title including the extent and boundaries of the property and other important matters before exchange of contracts.

William H Brown is a trading name of Sequence (UK) Limited which is registered in England and Wales under company number 4268443, Registered Office is Cumbria House, 16-20 Hockliffe Street, Leighton Buzzard, Bedfordshire, LU7 1GN. VAT Registration Number is 500 2481 05.



william h brown



01473 226101



ipswich@williamhbrown.co.uk



16-18 Wolsey House, Princes Street, IPSWICH,
Suffolk, IP1 1QT



williamhbrown.co.uk