



Holmewood Gardens | London |
SW2 3SA

£1,400 pcm

- One double bedroom
- Top floor
- Lift access
- Great views
- Recently decorated
- Great transport links
- Brixton Tube
- Brixton Market
- Brockwell Park
- Herne Hill



A top floor, one bedroom apartment with lift access and great city views in Brixton. The apartment has a double bedroom, bright lounge three piece suit bathroom and fitted kitchen. Located with in walking distance to Brixton Tube, Brixton Village and POP. Brockwell park, with it's Lido and Gym. Ideal for a couple, or individual professional, set back from the day and night-life but close enough to have fun. Available 17th June part furnished.



Energy Efficiency Rating		
	Current	Potential
<i>Very energy efficient - lower running costs</i>		
(92-100) A		
(81-91) B		
(69-80) C		75
(55-68) D	80	
(39-54) E		
(21-38) F		
(1-20) G		
<i>Not energy efficient - higher running costs</i>		

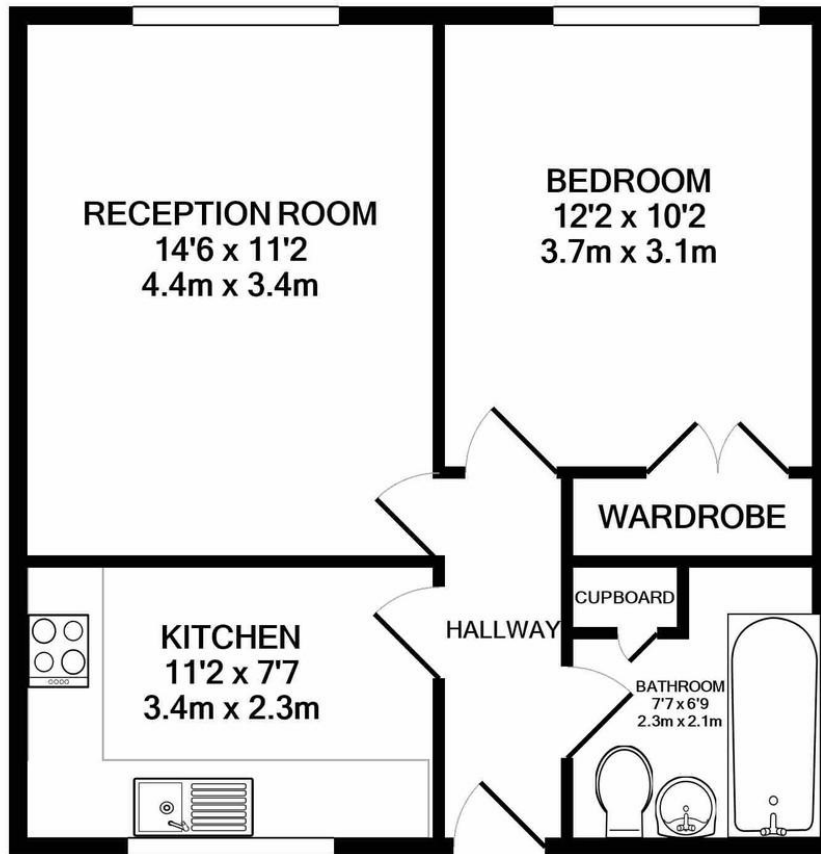

TOTAL APPROX. FLOOR AREA 472 SQ.FT. (43.8 SQ.M.)

Whilst every attempt has been made to ensure the accuracy of the floor plan contained here, measurements of doors, windows, rooms and any other items are approximate and no responsibility is taken for any error, omission, or mis-statement. This plan is for illustrative purposes only and should be used as such by any prospective purchaser. The services, systems and appliances shown have not been tested and no guarantee as to their operability or efficiency can be given

Made with Metropix ©2022

Viewing Arrangements

Strictly by appointment

Contact Details

121 Denmark Hill

London

SE5 8EN

www.urbanvillagehomes.co.uk

lettings@urbanvillagehomes.com

020 3519 9121

Agents Note: Whilst every care has been taken to prepare these sales particulars, they are for guidance purposes only. All measurements are approximate and are for general guidance purposes only and whilst every care has been taken to ensure their accuracy, they should not be relied upon and potential buyers are advised to recheck the measurements