



## Oak Tree Close, W5

£459,950

This two bedroom third floor apartment comes to market with no onward chain. Kept in immaculate condition throughout, the property comes with the added bonus of allocated parking and a share of freehold. The large living/dining room has floor to ceiling windows and is flooded with light.

Oak Tree Close is an eight minute walk from Ealing Broadway station and the wide range of shops and amenities that Ealing has to offer, just around the corner. The open space of Haven Green is a short walk, with excellent local schools also.

### Features

- Two Bedrooms
- Third Floor
- No Onward Chain
- Allocated Parking
- Share Of Freehold
- Close to Transport

# Oak Tree Close, London, W5

## Third Floor

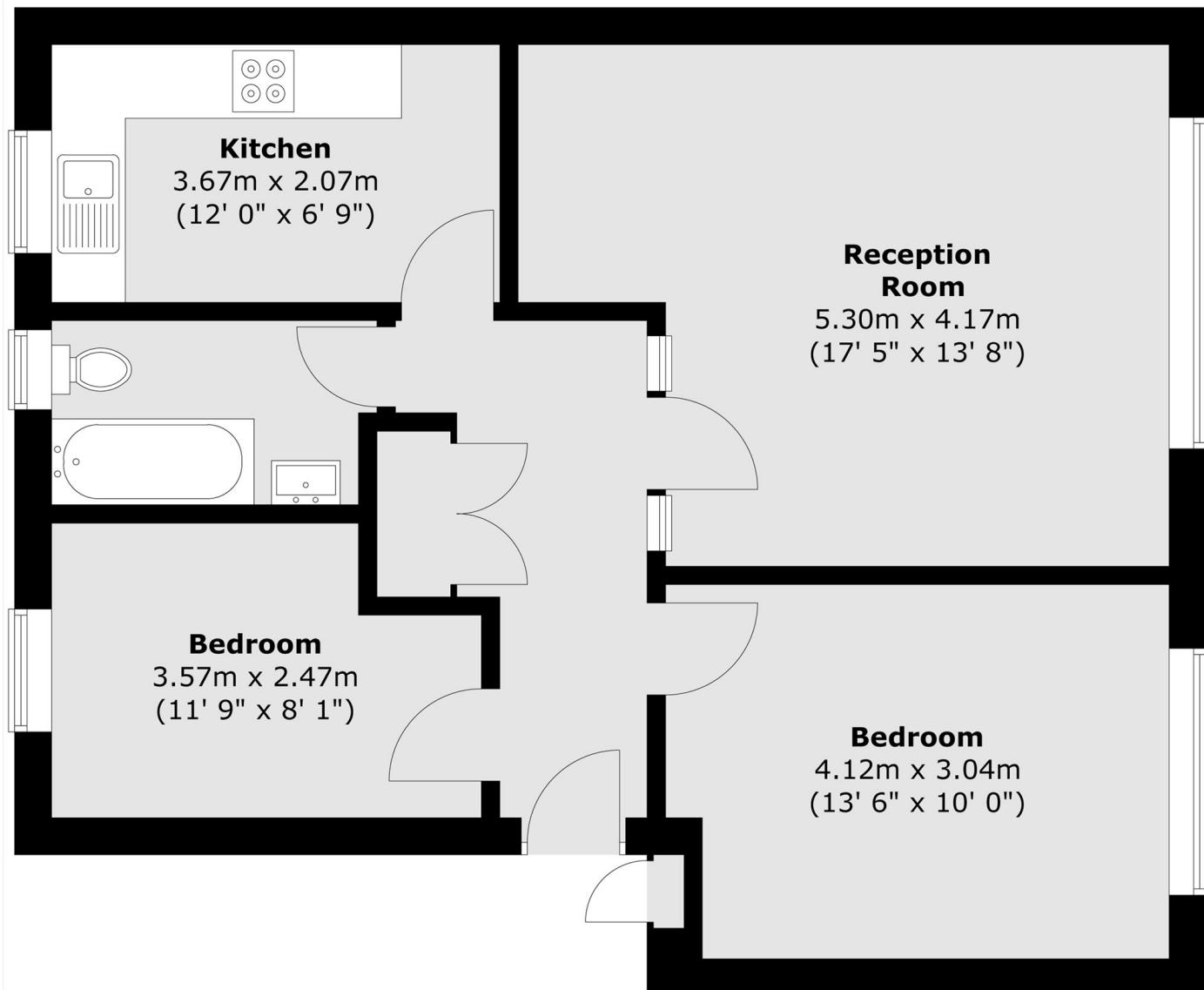

Total area (approx.) : 62 sq. m (667 sq. ft)