



POWIS GARDENS, W11

£3,250 Per week

Five bedroom
House
Three bathrooms
Conservatory dining area
Large private garden
EPC - C

@marshandparsons
marshandparsons.co.uk

MARSH &
PARSONS



ABOUT THE PROPERTY

A stunning five-bedroom family house with an impressive private garden, ideally positioned in the heart of Notting Hill.

Superbly located moments from the fashionable boutiques, artisan cafés, and renowned restaurants of Westbourne Grove and Portobello Road, the house also enjoys excellent transport links nearby at Notting Hill Gate and Westbourne Park stations, offering convenient access across London.



STEP INSIDE POWIS GARDENS

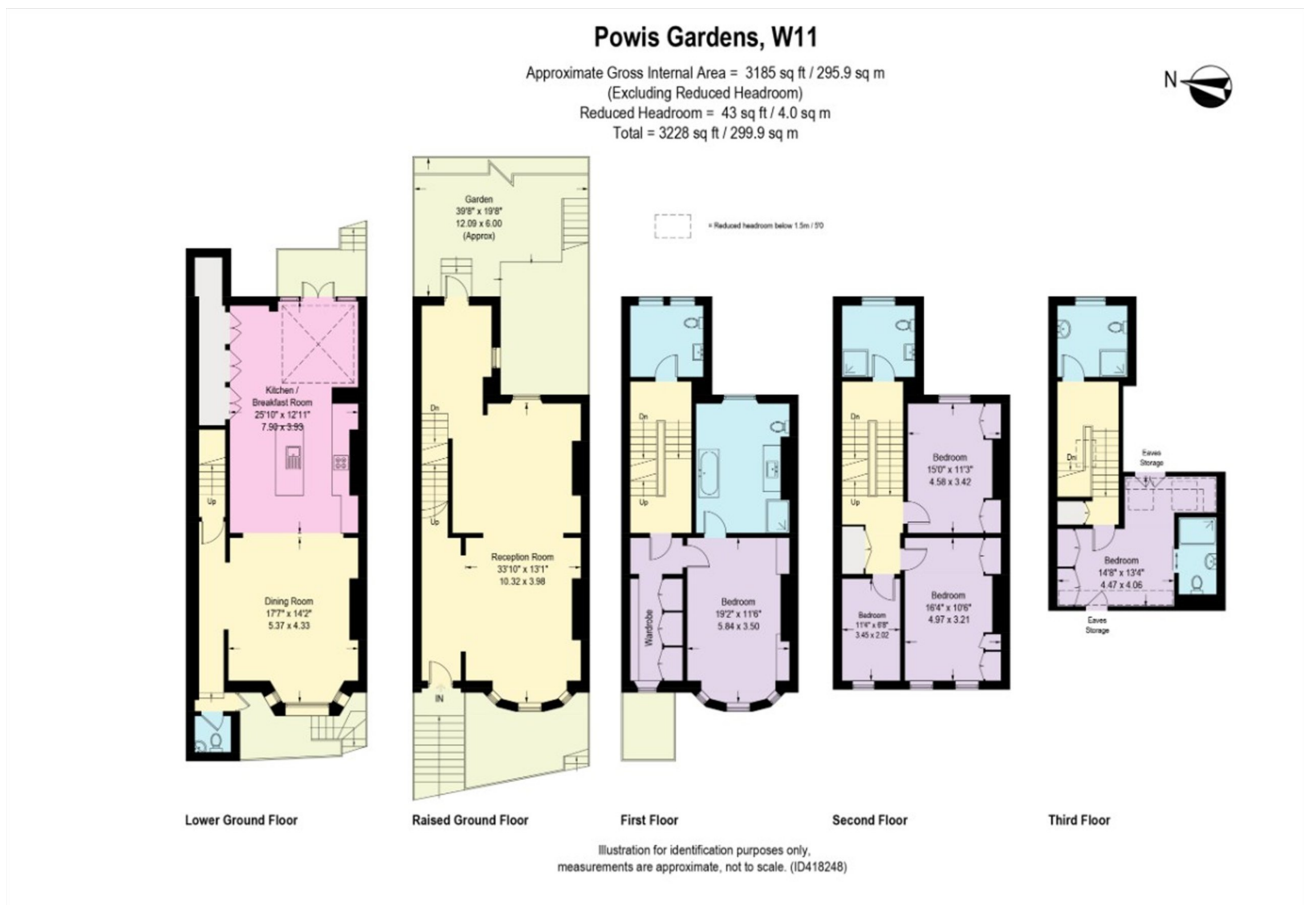

Notting Hill
020 7313 2890

Energy Rating: C We aim to make our particulars both accurate and reliable. However, they are not guaranteed; nor do they form part of an offer or contract. If you require clarification on any points then please contact us, especially if you're traveling some distance to view. Please note that appliances and heating systems have not been tested and therefore no warranties can be given as to their good working order

**MARSH &
PARSONS**