

Holly Close

SPEEDWELL

APPROXIMATE FLOOR AREA
94.9 SQM / 1021 SQFT



GROUND FLOOR

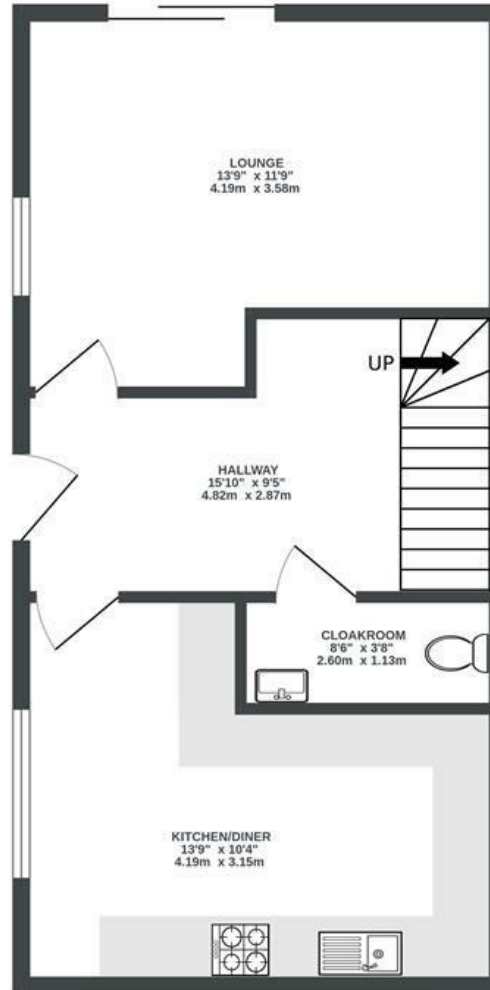

1ST FLOOR

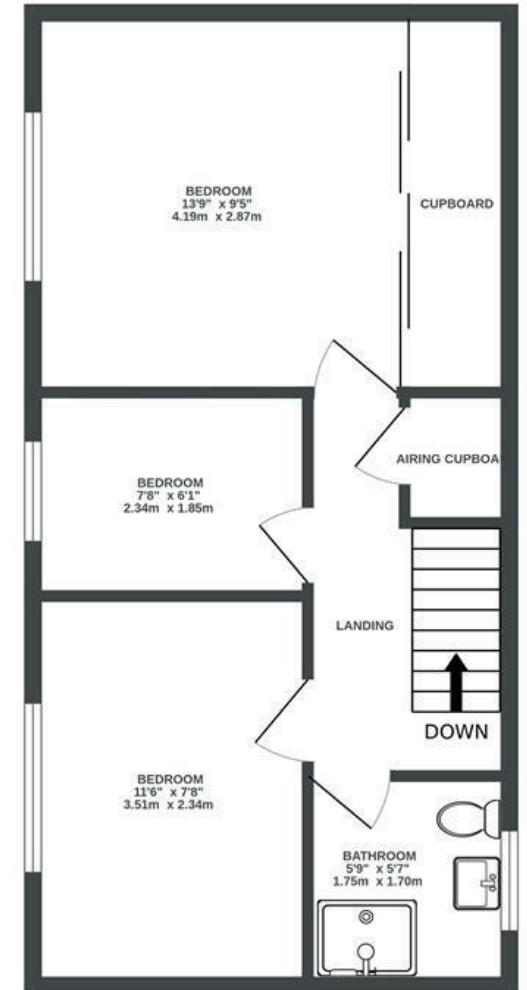

Boardwalk

Holly Close

SPEEDWELL, BRISTOL



£300,000



3 Bedrooms



BS5 7XP



1 Bathrooms

"This home has provided us with everything we've needed over the last five years. We've loved living in a house with so much natural light and we've taken great care in enhancing its features and redesigning the space, drawing inspiration from nature to create somewhere that feels calm, uplifting, and connected to the outdoors. The location is just as special. Proximity to the Bristol-to-Bath cycle path makes daily life easy, with a traffic-free ride to Temple Meads in under 15 minutes. Despite being well-connected, the setting is wonderfully peaceful; situated on a pedestrian-only path with cherry blossoms and greenery visible from every window, it has a quiet, tucked-away feel. There is birdsong throughout the day, and robins nesting in the garden most years have made this home feel truly special to us."

