



8 Berkeley Close

Abbots Langley, WD5 0XA

Asking Price £375,000

Welcome to this charming mid-terrace house located on Berkeley Close in the desirable village of Abbots Langley. This property, offers a comfortable living space of 612 square feet, featuring two well-proportioned double bedrooms and off street parking, making it an ideal choice for small families or professionals seeking a convenient lifestyle.

As you enter the home, you will find a welcoming reception room that provides a perfect space for relaxation or entertaining guests. The layout is functional, allowing for easy movement throughout the property. The kitchen, while in need of some modernisation, presents an excellent opportunity for the new owner to add their personal touch and create a culinary haven.

One of the standout features of this property is its prime location. It is within walking distance to the village centre, where you can enjoy a variety of local shops, cafes, and amenities. This accessibility enhances the appeal of the home, making it a practical choice for those who appreciate community living.

The seller is motivated, providing a unique opportunity for buyers looking to invest in a home that they can personalise to their taste.

In summary, this two-bedroom mid-terrace house on Berkeley Close is a promising prospect for anyone looking to settle in Abbots Langley. With its convenient location, potential for modernisation, and motivated seller, it is certainly worth considering for your first or next home.

- Two bedroom Mid Terrace Property
- Allocated Parking Space
- Enclosed rear Garden
- Walking Distance To Village
- No Upper Chain Complications
- In Need Of Some Modernisation
- Motivated Vendor
- Viewing By Appointment Only!

Viewing

Please contact our Abbots Langley Office on 01923262666 if you wish to arrange a viewing appointment for this property or require further information.



Floor Plan

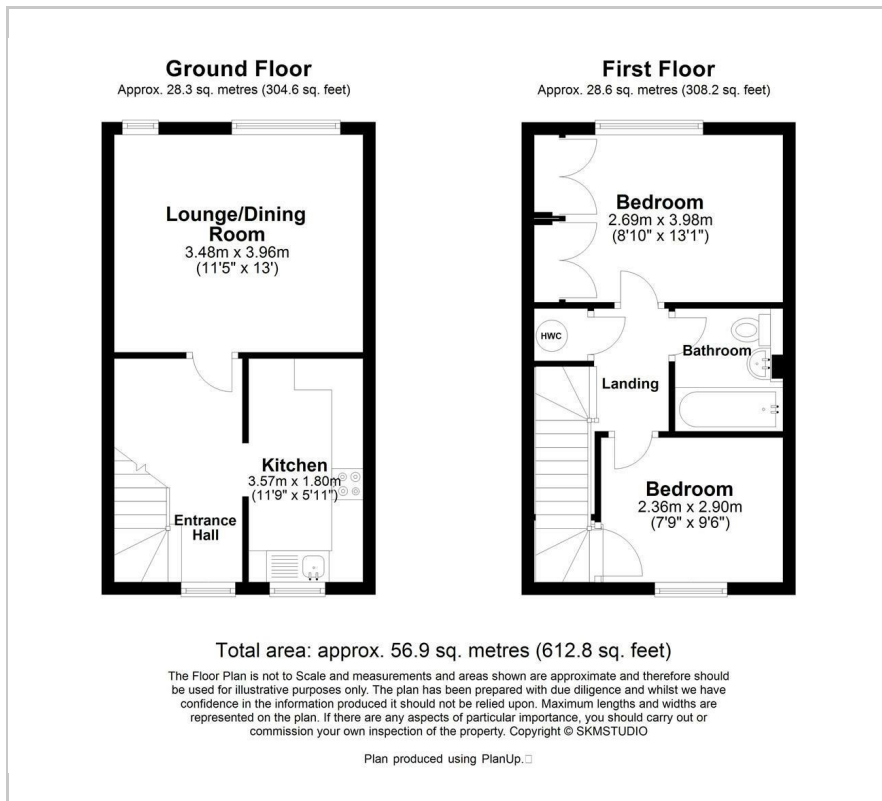

Area Map



Energy Efficiency Graph

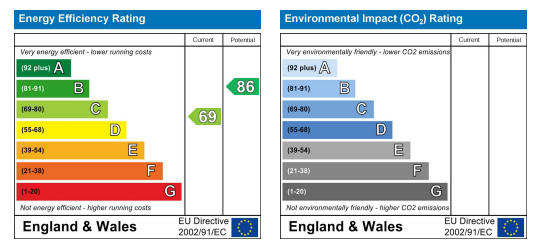

These particulars, whilst believed to be accurate are set out as a general outline only for guidance and do not constitute any part of an offer or contract. Intending purchasers should not rely on them as statements of representation of fact, but must satisfy themselves by inspection or otherwise as to their accuracy. No person in this firm's employment has the authority to make or give any representation or warranty in respect of the property.