

# Cottons

CHARTERED SURVEYORS

98 Poole Crescent, Harborne,  
Birmingham, B17 0PB

Offers in the Region Of  
**£245,000**



- Spacious End Terrace Home
- Two Double Bedrooms
- Downstairs WC
- EPC Rating: D
- Living Room
- First Floor Bathroom

Cavendish House, 359 - 361 Hagley Road Edgbaston, Birmingham, B17 8DL  
Tel: 0121 247 4747 Email: [sales@cottons.co.uk](mailto:sales@cottons.co.uk)  
[cottons.co.uk](http://cottons.co.uk)

A SPACIOUS and WELL PRESENTED end terrace home within HARBORNE near QUEEN ELIZABETH HOSPITAL. Viewing VITAL to appreciate accommodation and location on offer. Benefiting from uPVC double glazing and gas central heating, this ideal first time purchase or buy to let investment comprises paved driveway, porch, hallway, living room, kitchen diner with range cooker, downstairs WC, two double bedrooms, first floor bathroom and rear garden. Offered with NO UPWARD CHAIN.

#### Property Tenure

Freehold

#### Council Tax Band

B

#### EPC Rating

D

#### Location

The property is situated in a convenient and well regarded residential location within Harborne, in a crescent off Quinton Road, conveniently situated approximately:

- 680 metres from Queen Elizabeth Hospital.
- 750 metres from Selly Oak Shopping Park.
- 0.7 miles from Selly Oak Train Station.
- 0.8 miles from Harborne High Street.
- 0.9 miles from University of Birmingham.
- 3 miles from Birmingham City Centre.

#### Description

A two storey end terrace home of traditional brick construction with a pitched roof. The property is generally in a presentable condition.

Benefiting from uPVC double glazing and combi gas central heating.

#### Accommodation

Please refer to the floor plan for room measurements.

#### Ground Floor

Porch, hallway, living room, kitchen diner with range cooker, downstairs WC.

#### First Floor

Stairs and landing, bedroom one (double), bedroom two (double), bathroom with shower and WC.

#### Outside

Front - Gated paved driveway. Rear - Garden.

#### Availability

The property is offered with vacant possession and no upward chain.



**Fixtures and Fittings:** All fixtures and fittings mentioned in these particulars of sale are included in the asking price. All others are specifically excluded, but some items may be available by separate negotiation.

Need a solution with a property matter? Cottons can assist;

#### Residential Sales

0121 247 4747  
sales@cottons.co.uk

#### Auctions

0121 247 2233  
auctions@cottons.co.uk

#### Property Management

0121 247 2030  
property@cottons.co.uk

#### Landlords Property Insurance

0121 247 2030  
insurance@cottons.co.uk

#### Residential Lettings

0121 247 2299  
lettings@cottons.co.uk

#### Commercial Sales & Lettings

0121 247 4747  
commercial@cottons.co.uk

#### Energy Performance Certificates

0121 247 2299  
epc@cottons.co.uk

#### RICS Valuation Surveys

0121 247 4747  
sales@cottons.co.uk

# Cottons

CHARTERED SURVEYORS

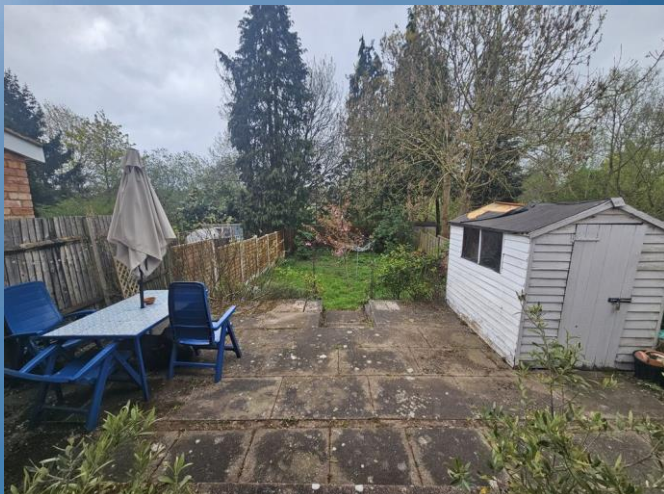

Cottons Chartered Surveyors give notice that (i) the particulars are set out as a general outline copy for the guidance of intending purchasers or lessees, and do not constitute part of an offer or contract; (ii) all descriptions, dimensions, references to condition and necessary permission for use and occupation, and other details are given without responsibility and any intending purchasers or tenants should not rely on them as statements or representations of fact but must satisfy themselves by inspection or otherwise as to the correctness of each of them; (iii) no persons in the employment of Cottons Chartered Surveyors has any authority to make or give any representation or warranty whatever in relation to this property.

Cottons Chartered Surveyors have not tested any apparatus, equipment, fixtures and fittings or services and so cannot verify that they are in working order or fit for the purpose. A Buyer is advised to obtain verification from their Solicitor or Surveyor. References to the Tenure of a Property are based on information supplied by the Seller. The Agent has not had sight of the title documents. A Buyer is advised to obtain verification from their Solicitor. You are advised to check the availability of this property before travelling any distance to view. We have taken every precaution to ensure that these details are accurate and not misleading. If there is any point which is of particular importance to you, please contact us and we will provide any information you require. This is advisable, particularly if you intend to travel some distance to view the property. The mention of any appliances and services within these details does not imply that they are in full and efficient working order. These particulars are in draft form awaiting Vendors confirmation of their accuracy. These details must therefore be taken as a guide only and approved details should be requested from the agents.

# 98 Poole Crescent

Approximate Gross Internal Area = 78.0 sq m / 839 sq ft

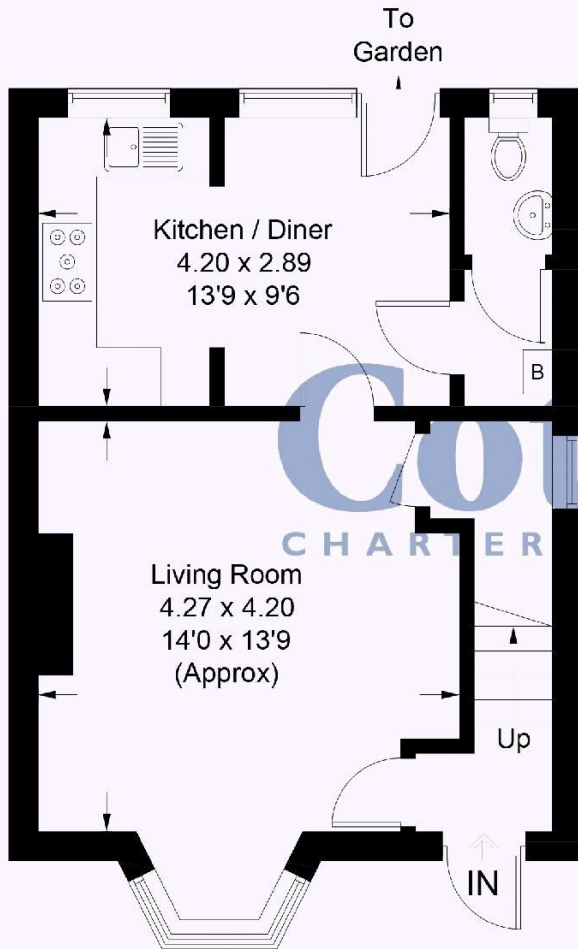

Ground Floor

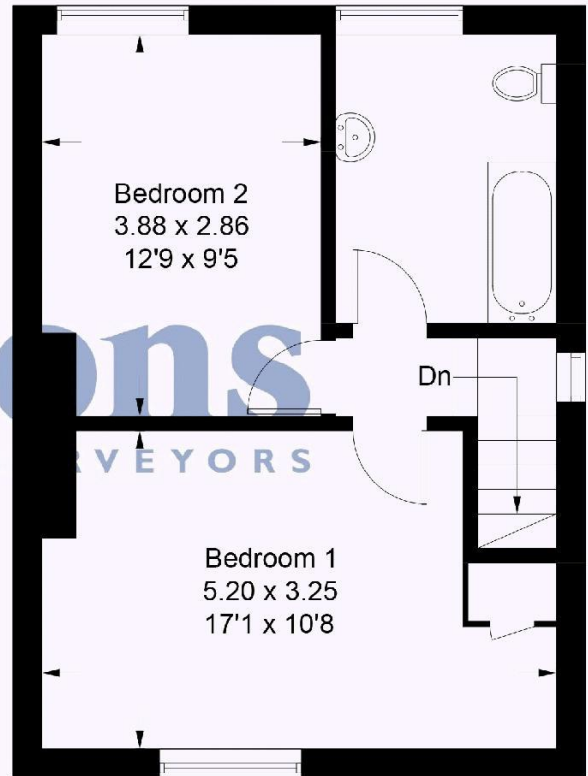

First Floor

Illustration for identification purposes only, measurements are approximate, not to scale. Fourlabs.co © (ID1291400)

**Cottons**  
CHARTERED SURVEYORS

0121 247 4747

This plan is for illustration purposes only and may not be to scale or representative of the property.

359 - 361 Hagley Road, Edgbaston, Birmingham, West Midlands, B17 8DL

