



HIVE

7 BARNES LODGE WESSEX ROAD
DORCHESTER
DT1 2FH



Agent's introduction

No chain. This beautifully presented two bedroom ground floor apartment offers bright, spacious accommodation and the rare advantage of direct access onto the attractive communal gardens.







HIVE

Property highlights

- Lodge Manager available 5 days a week
- Excellent on-site facilities including Owners' Lounge and Guest Suite
- Close to Dorchester's shops, transport links and hospital
- 24-hour Careline system for safety and security
- A Guest Suite is available for friends and family to stay in
- Owners Lounge and coffee bar
- Owners Wellbeing Suite
- Owners private car park



Floor plan and EPC

Energy Efficiency Rating		
	Current	Potential
Very energy efficient - lower running costs		
(92 plus) A		
(81-91) B		
(69-80) C	69	71
(55-68) D		
(39-54) E		
(21-38) F		
(1-20) G		
Not energy efficient - higher running costs		
England & Wales	EU Directive 2002/91/EC	

Approx Gross Internal Area
88 sq m / 950 sq ft

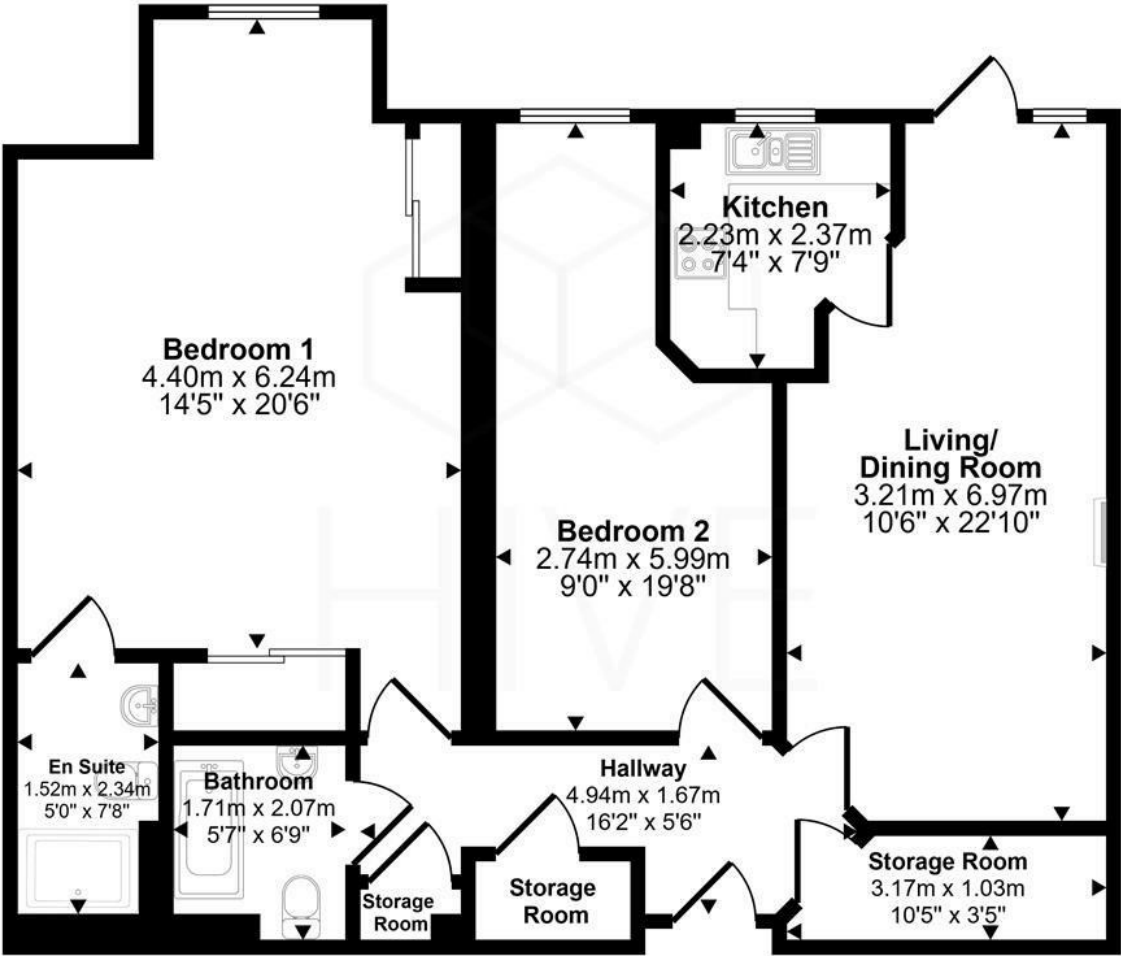

Floorplan

This floorplan is only for illustrative purposes and is not to scale. Measurements of rooms, doors, windows, and any items are approximate and no responsibility is taken for any error, omission or mis-statement. Icons of items such as bathroom suites are representations only and may not look like the real items. Made with Made Snappy 360.



HIVE



HIVE & Partners Unit F1, Arena Business Centre 9 Nimrod Way, Ferndown, BH21 7UH
01202 122 002 | www.hiveandpartners.co.uk | sales@hiveandpartners.co.uk