

Yardley Wood Road, Shirley, Solihull, B90 1LA

Offers In Region Of £340,000

3 2 2



Extended Family Home in Prime Shirley Location — Versatile Layout with Option for Fourth Bedroom, Spacious Lounge & Conservatory

Key Features

- Extended three-bedroom semi-detached family home
- Highly sought-after Shirley location close to schools & amenities
- Modern kitchen/diner with access to a downstairs shower room & further dining room
- Contemporary family bathroom
- Driveway and integrated garage
- Versatile dining room doubles as potential fourth bedroom
- Spacious 22ft lounge with feature bay window
- Bright conservatory overlooking private rear garden
- Ground floor WC and multiple storage cupboards
- Excellent transport links via Shirley Station, A34 & M42

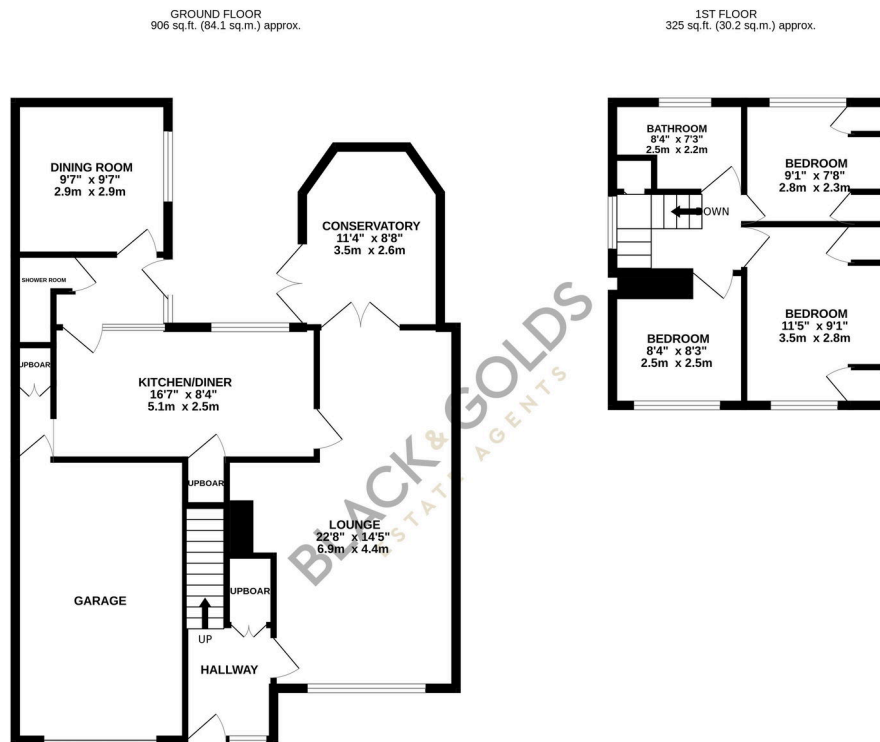

Whilst every attempt has been made to ensure the accuracy of the floorplan contained here, measurements of doors, windows, rooms and any other items are approximate and no responsibility is taken for any error, omission or mis-statement. This plan is for illustrative purposes only and should be used as such by any prospective purchaser. The services, systems and appliances shown have not been tested and no guarantee as to their operability or efficiency can be given.

Made with Metropix ©2025