

Floriston Avenue

Uxbridge • Middlesex • UB10 9EB

PCM: £1,800 PCM



coopers
est 1986

Presented to the market, this THREE BEDROOM family home located on a popular residential road in Hillingdon on the Oak Farm Estate. The property is within walking distance of shops, schools, bus/road links & Hillingdon Tube station. The property comprises open plan lounge/diner, Kitchen, THREE bedrooms, Family bathroom and Large Rear Garden. Benefits include: Double glazing, Gas central heating, Driveway Parking. Unfurnished.

Oak Farm Estate
Large Rear Garden
Driveway Parking
Council Tax Band D
Close to Local Shops
Close to Hillingdon Station
Close to Oak Farm School
Transport Links
End of terrace
Close to Stockley Park

Available Date

19th December 2025

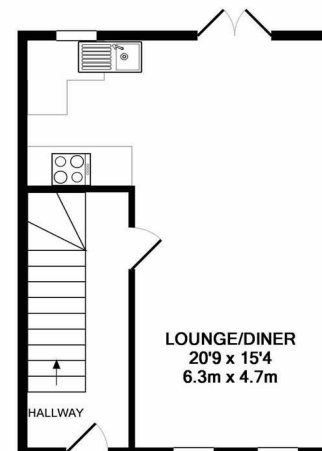

GROUND FLOOR
APPROX. FLOOR
AREA 319 SQ.FT.
(29.6 SQ.M.)

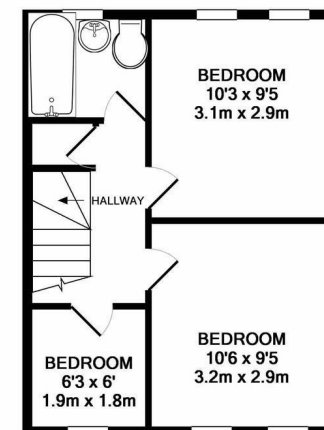

1ST FLOOR
APPROX. FLOOR
AREA 320 SQ.FT.
(29.8 SQ.M.)

TOTAL APPROX. FLOOR AREA 639 SQ.FT. (59.4 SQ.M.)

Whilst every attempt has been made to ensure the accuracy of the floor plan contained here, measurements of doors, windows, rooms and any other items are approximate and no responsibility is taken for any error, omission, or mis-statement. This plan is for illustrative purposes only and should be used as such by any prospective purchaser. The services, systems and appliances shown have not been tested and no guarantee as to their operability or efficiency can be given

Made with Metropix ©2018

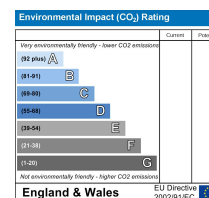
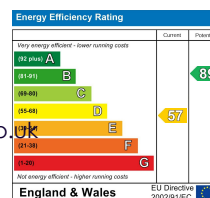
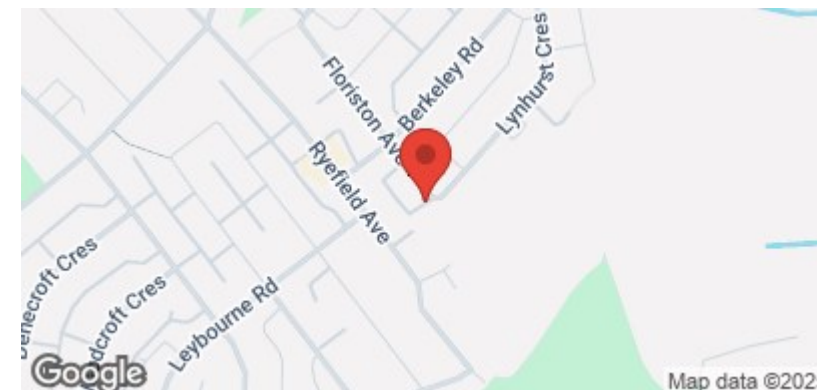

Important Notice: These particulars, whilst believed to be accurate are set out as a general outline only for guidance and do not constitute any part of an offer or contract. Intending purchasers should not rely on them as statements or representation of fact, but must satisfy themselves by inspection or otherwise has the authority to make or give any representation or warranty in respect of the property.

coopers
est 1986

01895 257 566

1 Vine Street, Uxbridge,
Middlesex, UB8 1QE

propertymanagement@coopersresidential.co.uk

CoopersResidential.co.uk