



**40 Desborough Crescent, Maidenhead SL6 4BB**

**welcome to**

**40 Desborough Crescent, Maidenhead**

This three bedroom semi-detached family home offers an excellent opportunity for a buyer looking to modernise and create a property tailored to their own taste.



# Desborough Crescent, Maidenhead, SL6

Approximate Area = 790 sq ft / 73.3 sq m

For identification only - Not to scale

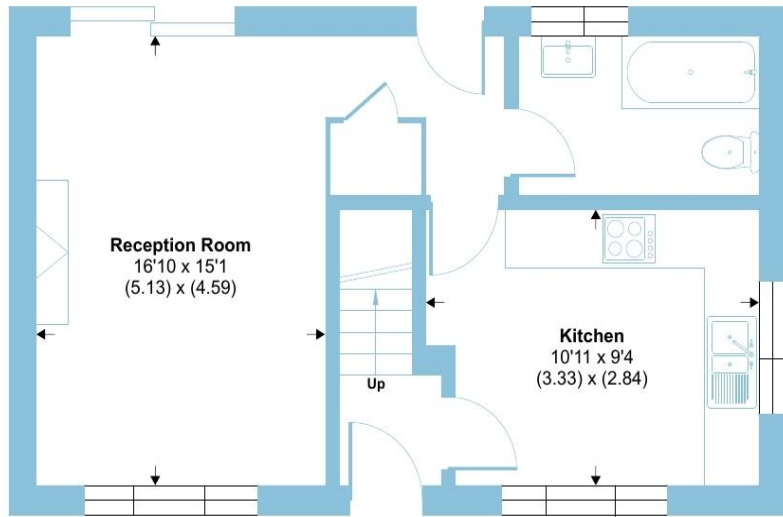

GROUND FLOOR

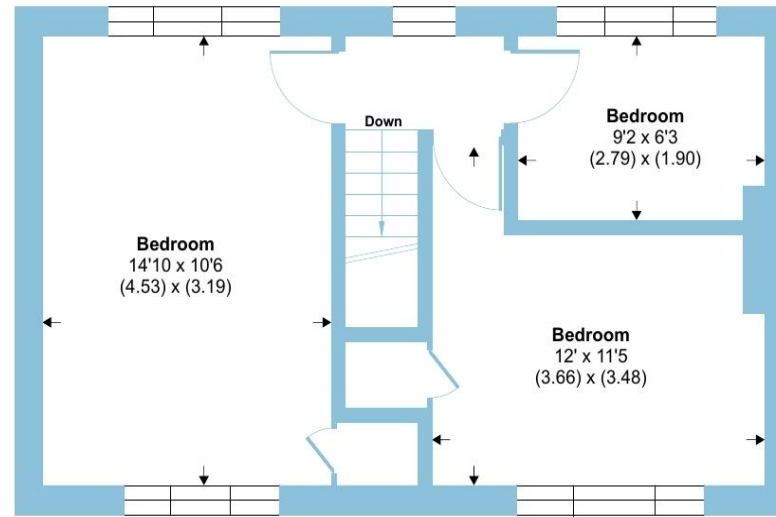

FIRST FLOOR

The ground floor features an entrance lobby leading into a bright living room, a practical kitchen and a family bathroom. Upstairs, there are two generous double bedrooms along with a well-proportioned third bedroom, providing flexible space for guests, children or a home office. The property benefits from a good-sized rear garden—ideal for families, entertaining or future extension potential (subject to planning). To the front, there is convenient off-street parking.

Located within easy reach of Maidenhead town centre and station, the home is well placed for commuters and enjoys close proximity to several well-regarded local schools. Offering great potential in a sought-after area, this property is perfect for those keen to put their own stamp on a family home.

welcome to

## 40 Desborough Crescent, Maidenhead

- SEMI DETACHED FAMILY HOME
- THREE GOOD SIZE BEDROOMS
- LIVING ROOM
- GROUND FLOOR BATHROOM
- REQUIRING MODERNISATION - GREAT POTENTIAL
- OFF STREET PARKING
- CLOSE TO LOCAL SCHOOLS
- EASY ACCESS TO TOWN CENTRE & STATION

Tenure: Freehold EPC Rating: D

Council Tax Band: C

offers over

**£425,000**



Please note the marker reflects the postcode not the actual property

check out more properties at [rogerplatt.co.uk](http://rogerplatt.co.uk)



Property Ref:  
MHD123400 - 0003

1. MONEY LAUNDERING REGULATIONS Intending purchasers will be asked to produce identification documentation at a later stage and we would ask for your co-operation in order that there is no delay in agreeing the sale. 2. These particulars do not constitute part or all of an offer or contract. 3. The measurements indicated are supplied for guidance only and as such must be considered incorrect. Potential buyers are advised to recheck measurements before committing to any expense. 4. We have not tested any apparatus, equipment, fixtures or services and it is in the buyers interest to check the working condition of any appliances. 5. Where an EPC, or a Home Report (Scotland only) is held for this property, it is available for inspection at the branch by appointment. If you require a printed version of a Home Report, you will need to pay a reasonable production charge reflecting printing and other costs. 6. We are not able to offer an opinion either written or verbal on the content of these reports and this must be obtained from your legal representative. 7. Whilst we take care in preparing these reports, a buyer should ensure that his/her legal representative confirms as soon as possible all matters relating to title including the extent and boundaries of the property and other important matters before exchange of contracts.

Roger Platt is a trading name of Sequence (UK) Limited which is registered in England and Wales under company number 4268443, Registered Office is Cumbria House, 16-20 Hockliffe Street, Leighton Buzzard, Bedfordshire, LU7 1GN. VAT Registration Number is 500 2481 05.

  
roger platt



**01628 773333**



Maidenhead@rogerplatt.co.uk



25-29 Queen Street, MAIDENHEAD, Berkshire,  
SL6 1NB



**rogerplatt.co.uk**